

*Improvements to*  
**PENNIMAN ROAD  
PLAY AREA**



# MEETING RECORDING



*The Boston Parks and Recreation Department will be recording the meeting and posting to our project webpage for those who are unable to attend the Zoom meeting live.*

*It is possible that participants may also be recording the meeting with their phones cameras or other devices. If you do not wish to be recorded during this meeting, please keep your microphone muted and camera off.*

*Please share with your neighbors and friends:  
[boston.gov/penniman-road-play](https://boston.gov/penniman-road-play)*

# MEETING ETIQUETTE

*We want to ensure this conversation is a pleasant experience for all and that all community members/stakeholders are comfortable sharing their comments, questions and feedback.*

*Please be respectful and mindful of each other's time when asking questions/ providing comments, so that all attendees are able to participate in the meeting.*

*Keep questions/ comments project-specific and not personal to yield solution-driven discussion.*

*Please wait until all attendees have had the opportunity to ask a question/ provide a comment before providing additional questions/ comments.*

*You can always set up a conversation with **Max Sell**, [max.sell@Boston.gov](mailto:max.sell@Boston.gov), to further discuss the project or process.*

# ZOOM TIPS

Here is how you can participate during the question and answer part of the presentation.

## DURING THE PRESENTATION:



### VIA WEB:

Turn video on / off.

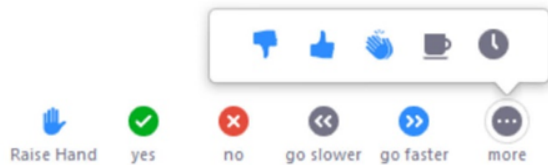

To use these non-verbal options click on participants (bottom of screen); these options will pop up in side bar.

## FEEDBACK:

Please note that chat will be disabled for the meeting. Please share your feedback through the survey link available at the end of the presentation.

# AGENDA

---

1

**PROJECT OVERVIEW**

---

2

**WHAT WE HEARD - MEETINGS, SURVEY**

---

3

**FINAL CONCEPT DESIGN PLAN**

---

4

**TEAM LISTENING & COMMUNITY DISCUSSION**

---

5

**CLOSING REMARKS & NEXT STEPS**

---

# PROJECT OVERVIEW



# PROJECT TEAM

---

## MAX SELL

Project Manager

[max.sell@boston.gov](mailto:max.sell@boston.gov) or 617-961-3097

## JENNIFER ROBERTS

Allston-Brighton Liaison,  
Office of Neighborhood Services

[jennifer.roberts@boston.gov](mailto:jennifer.roberts@boston.gov) or 617-635-4517

## MY'KEL MCMILLEN

Outreach Coordinator, External Affairs

[corey.mcmillen@boston.gov](mailto:corey.mcmillen@boston.gov) or 617-201-1294

**KAKI MARTIN**, PRINCIPAL

**JENNIFER NG**, SENIOR ASSOCIATE

**HANNAH HARDENBERGH**, LANDSCAPE DESIGNER

KLOPFER MARTIN DESIGN GROUP



# PROJECT SCHEDULE

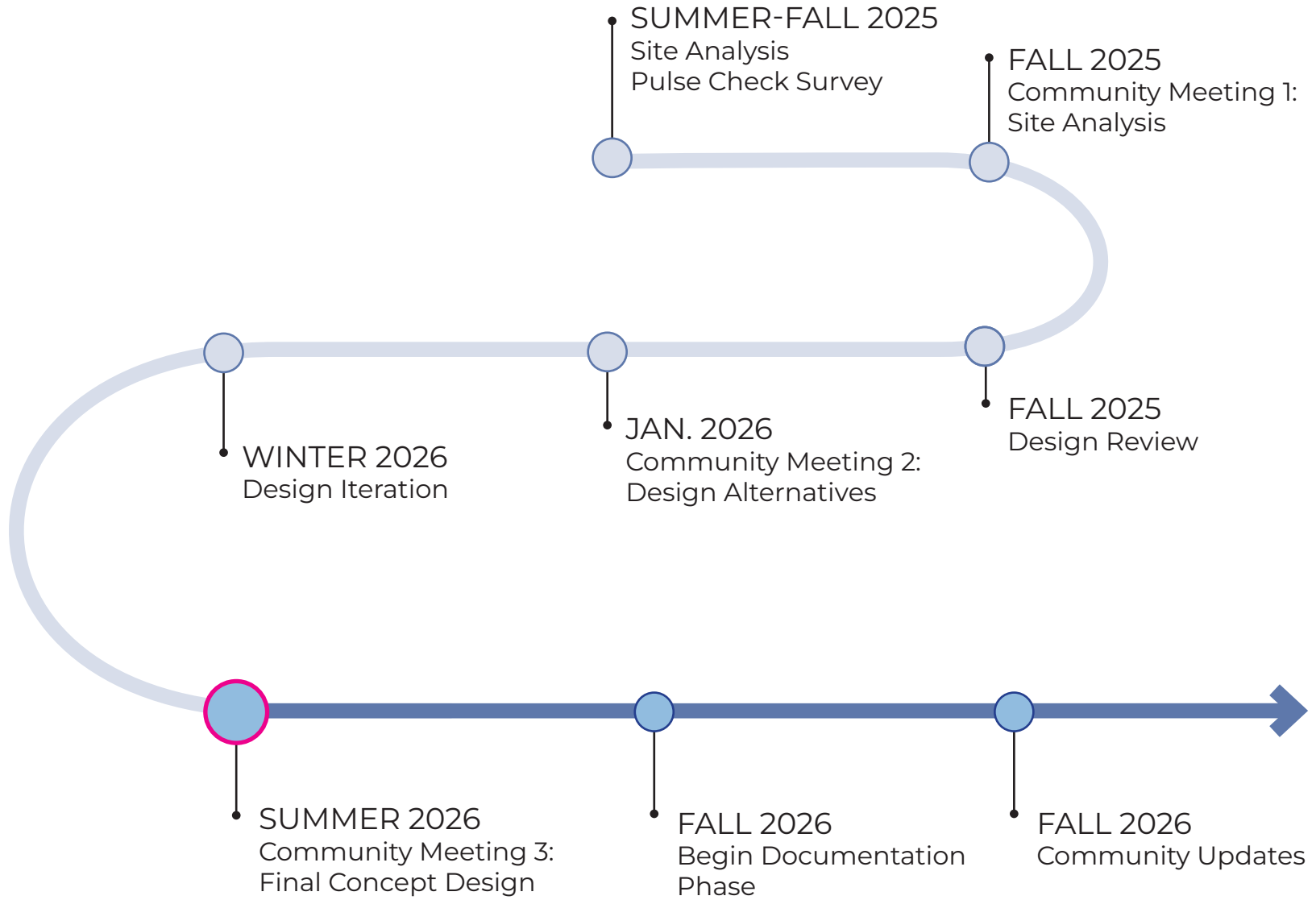

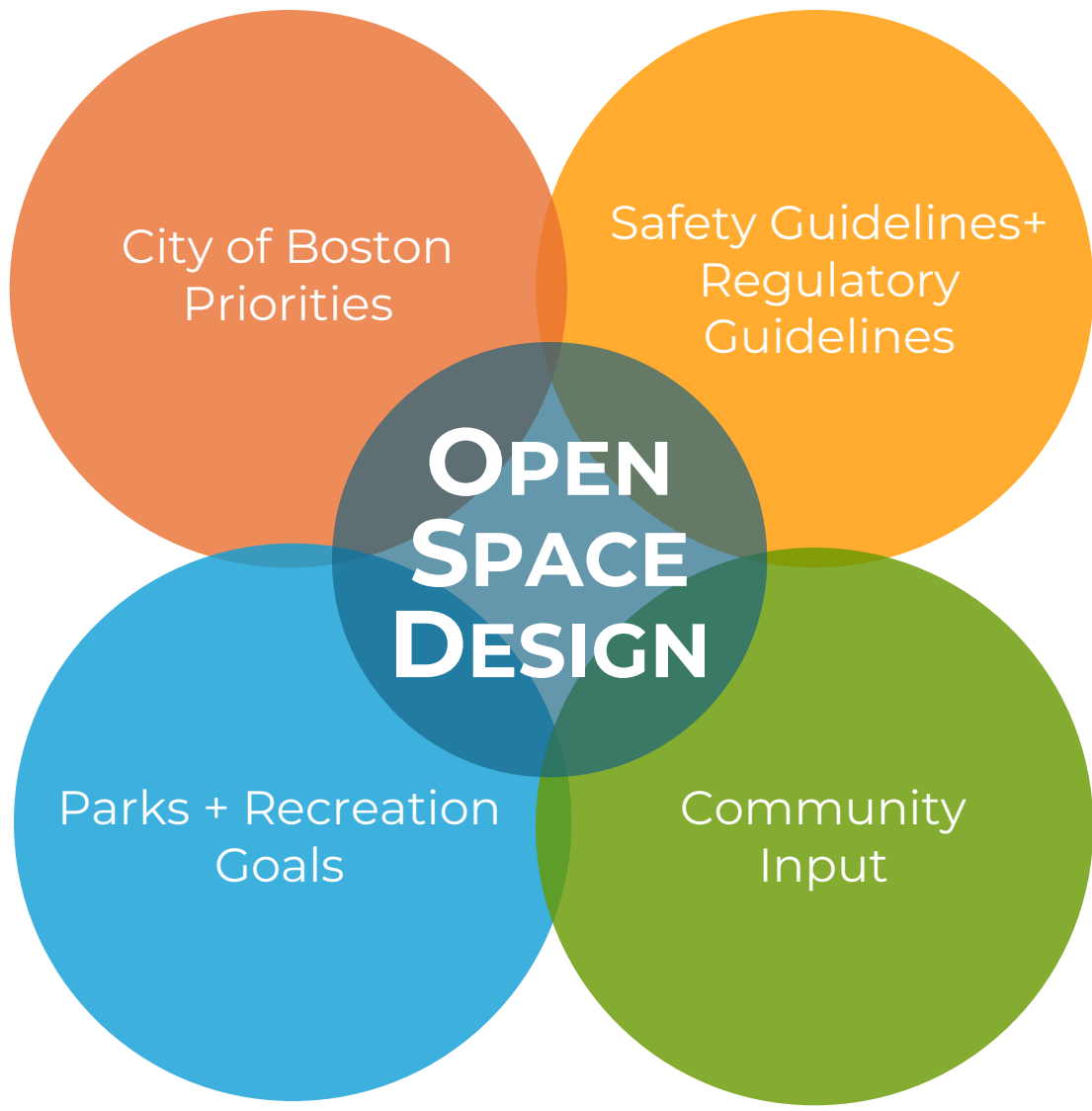

City of Boston  
Priorities

Safety Guidelines+  
Regulatory  
Guidelines

**OPEN  
SPACE  
DESIGN**

Parks + Recreation  
Goals

Community  
Input

# PARK EXTENTS

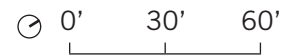

# EXISTING PARK AMENITIES

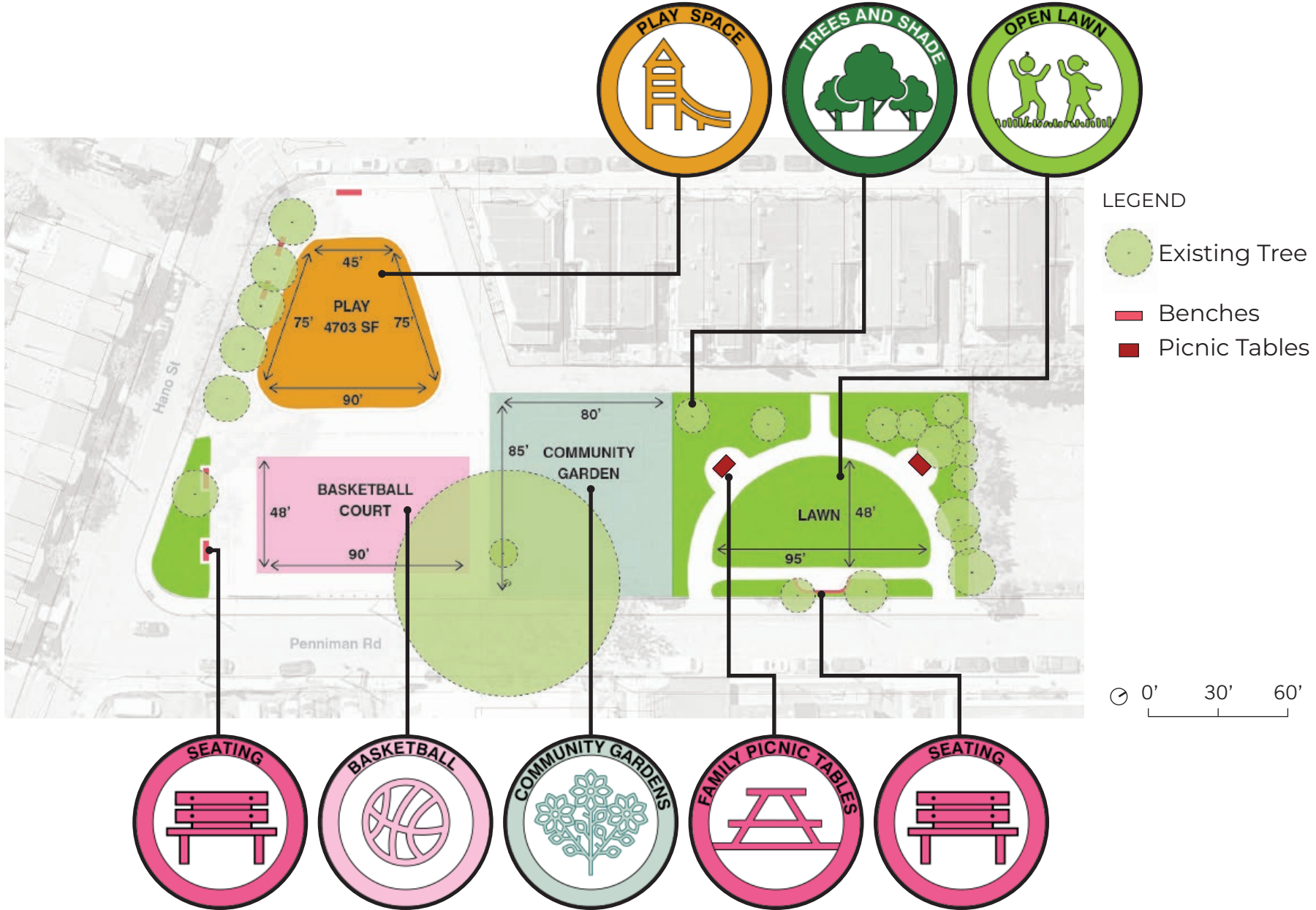

# WHAT WE HEARD

## COMMUNITY MEETINGS 1 + 2

JASONS  
GLEN

BERNIE

# COMMUNITY MEETING 1 FEEDBACK

What do you do at the Park? Which improvements would you like to see?  
*Comments included from both Meeting Discussion and Survey Responses.*

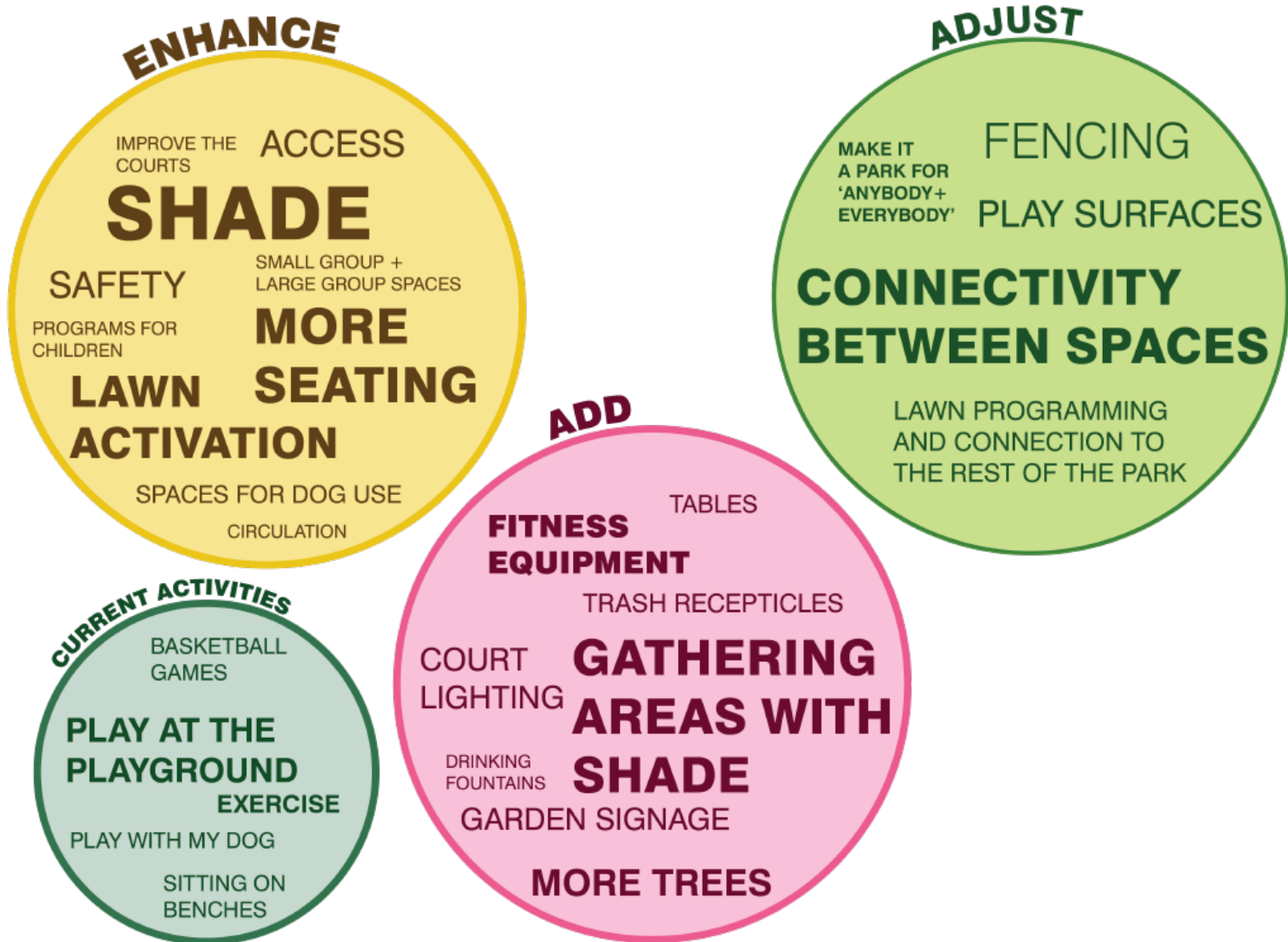

# COMMUNITY MEETING 2 FEEDBACK

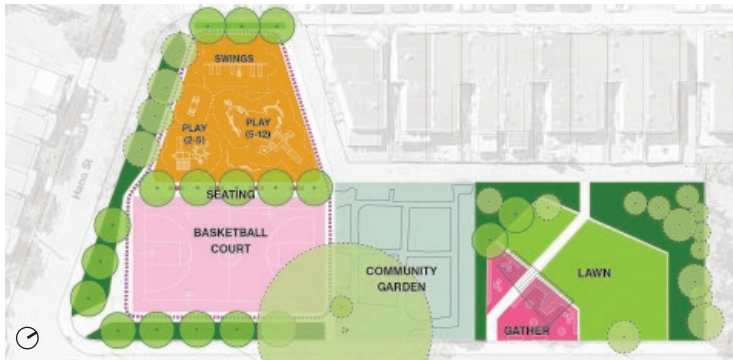

Simple refinements to what's already there.

## CONCEPT 1: REFRESH



Nice **trike loop!**



Swap locations of basketball court and lawn.

## CONCEPT 2: TRADE

We like that the **Lawn** and the **Playground** are together!

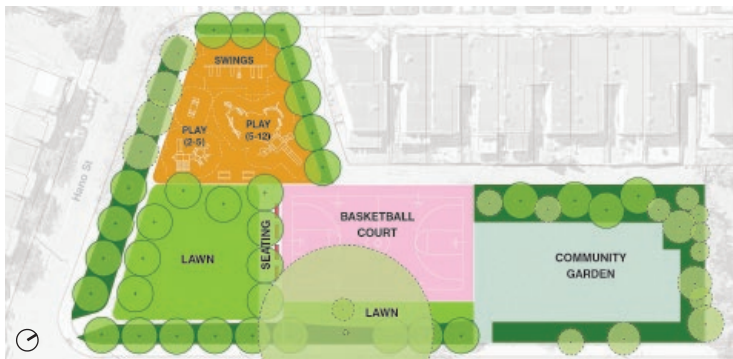
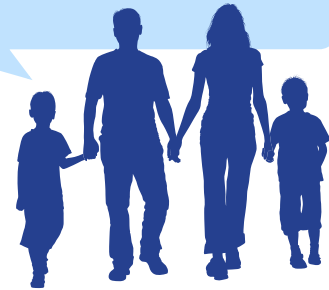

Relocate community garden to unify the park.

## CONCEPT 3: SHUFFLE

Moving the garden makes the park feel **more connected.**



We Agree!



# COMMUNITY MEETING 2 FEEDBACK

**DESIGN OPTIONS**  
Share what you prefer!

When you arrive at the park's main entrance, what do you want to do and see first?  
Place a sticker on your favorite option & tell us why!

What activities are best next to each other?  
Place a sticker on your favorite option & tell us why!

How can we improve the basketball court?  
Share your thoughts!

Would you like fitness equipment?  
Place a sticker on your favorite types!

Should the community garden be relocated?  
Place a sticker on your favorite option!

**Legend:**  
 ■ GATHERING AREA  
 ■ PLAY AREA  
 ■ BASKETBALL COURT  
 ■ PLANTING  
 ■ LAWN  
 ● EXISTING TREE  
 ● PROPOSED TREE  
 → PARK MAIN ENTRANCE

*Like to arrive @ a green lawn*

*Yes to more shade*

*Like Concept 3! - Differentiation of play, lawn & what - whatever - something for the ball - Concept 3 is best!*

**Community Garden Relocation Considerations:**  
 1. Improvements to the community garden since not part of the original project issue in budget.  
 2. Relocating the community garden would work significant budget away from other park programs (play, basketball, lawn).

**Options for Garden Relocation:**  
 KEEP THE GARDEN WHERE IT IS (CONCEPTS 1 & 2): South Park, Existing Garden, North Park.  
 MOVE THE GARDEN NORTH (CONCEPT 3): United Park, Relocated Garden.

**Fitness Equipment Options:** STRENGTH, BALANCE, AGILITY, FLEXIBILITY.

JANUARY 28, 2026 | PENNIMAN ROAD PLAY AREA CO.

"This park gets used by multiple daycares. It would be great if the toddler play area could somewhat be divided from the big kids structure."

"Stripe the courts for other sports and games in addition to basketball!"

"Connection of garden, playground, and lawn - expands the park's green space."

"More shade and a trike/scooter circle would be great!"

"The existing trees in the park do not provide sufficient shade near seating areas."

"I wonder if there is a way...that we could have some sort of connecting path between the playground/lawn and the basketball court."



# PROJECT GOALS

1. Maximize **multi-generational play** and gathering.
2. Create smooth transition between programs.
3. Provide **more seating** and **shaded gathering areas.**
4. **Activate the lawn** area and integrate the lawn with the overall park experience.
5. Increase play value at the playground and **maximize play opportunities.**
6. Improve **basketball court** and increase seating for viewing.
7. Maintain and protect **existing trees** and design for the **next generation of tree canopy.**

# FINAL CONCEPT DESIGN PLAN



# CONCEPT OVERVIEW

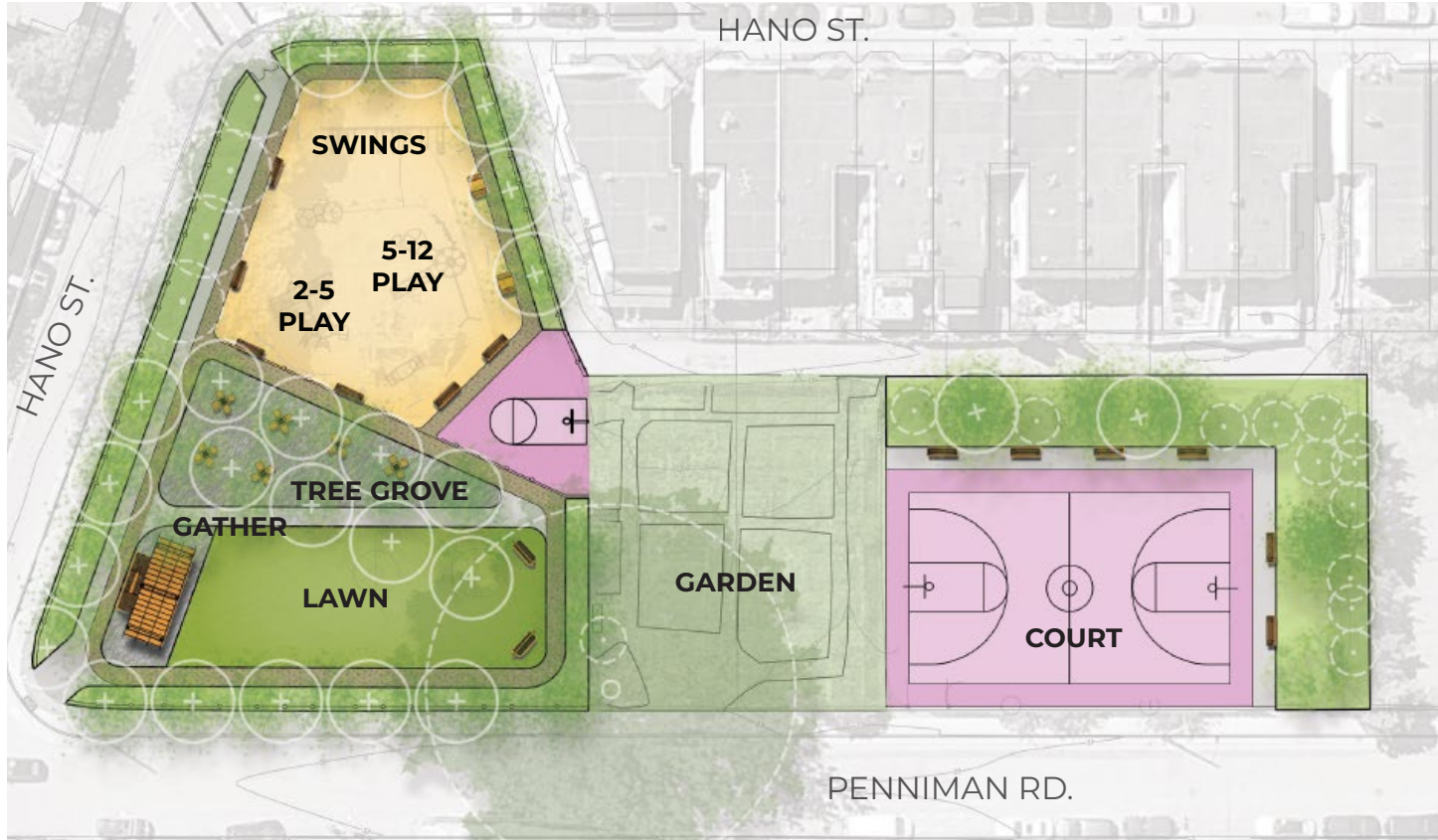

## LEGEND

- Play Area
- Trike Loop
- Basketball
- Benches
- Picnic Tables
- Game Tables
- Porch Swings

0' 25' 50'

\* Note: Colors noted in plan are concept only and do not represent final material color choice.

# ZOOMING IN: PLAYGROUND, TREE GROVE, & LAWN



\* Note: Colors noted in plan are concept only and do not represent final material color choice.

# PROGRAMS

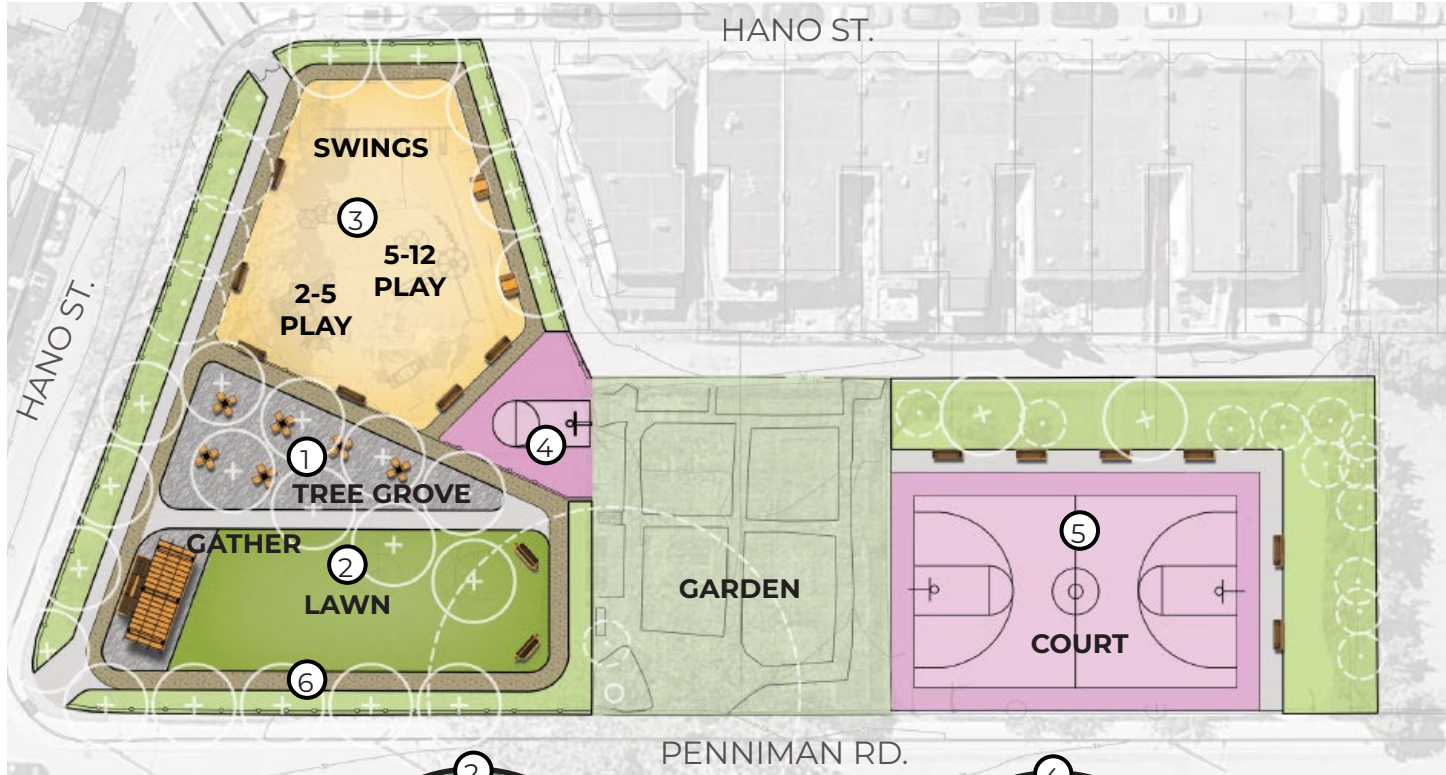

## LEGEND

- Play Area
- Trike Loop
- Basketball
- Benches
- Picnic Tables
- Game Tables
- Porch Swings

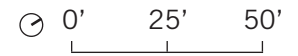

# SEATING & GATHER

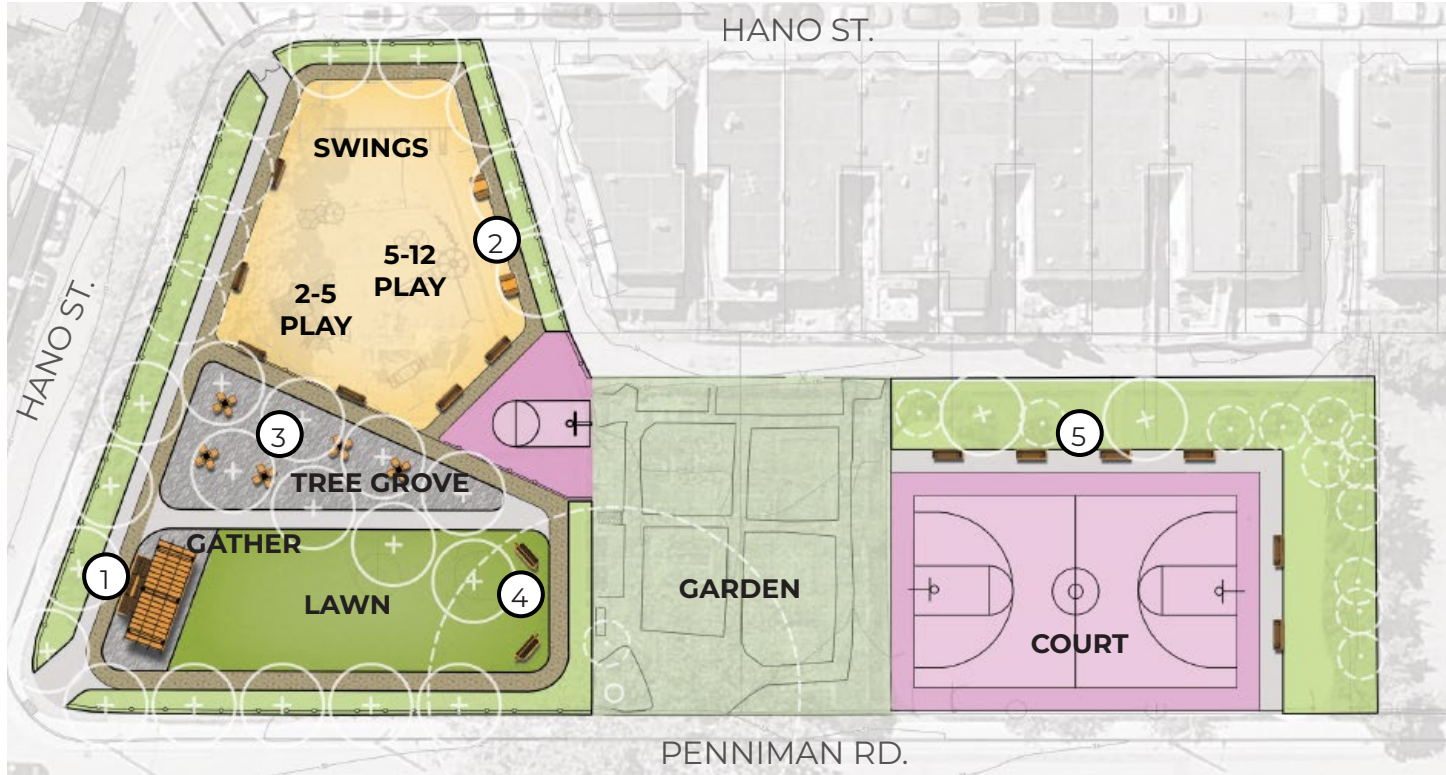

## LEGEND

- Play Area
- Trike Loop
- Basketball
- Benches
- Picnic Tables
- Game Tables
- Porch Swings

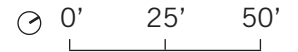

**SOCIAL BENCH**



**PICNIC TABLES**



**GAME TABLES**



**PORCH SWINGS**





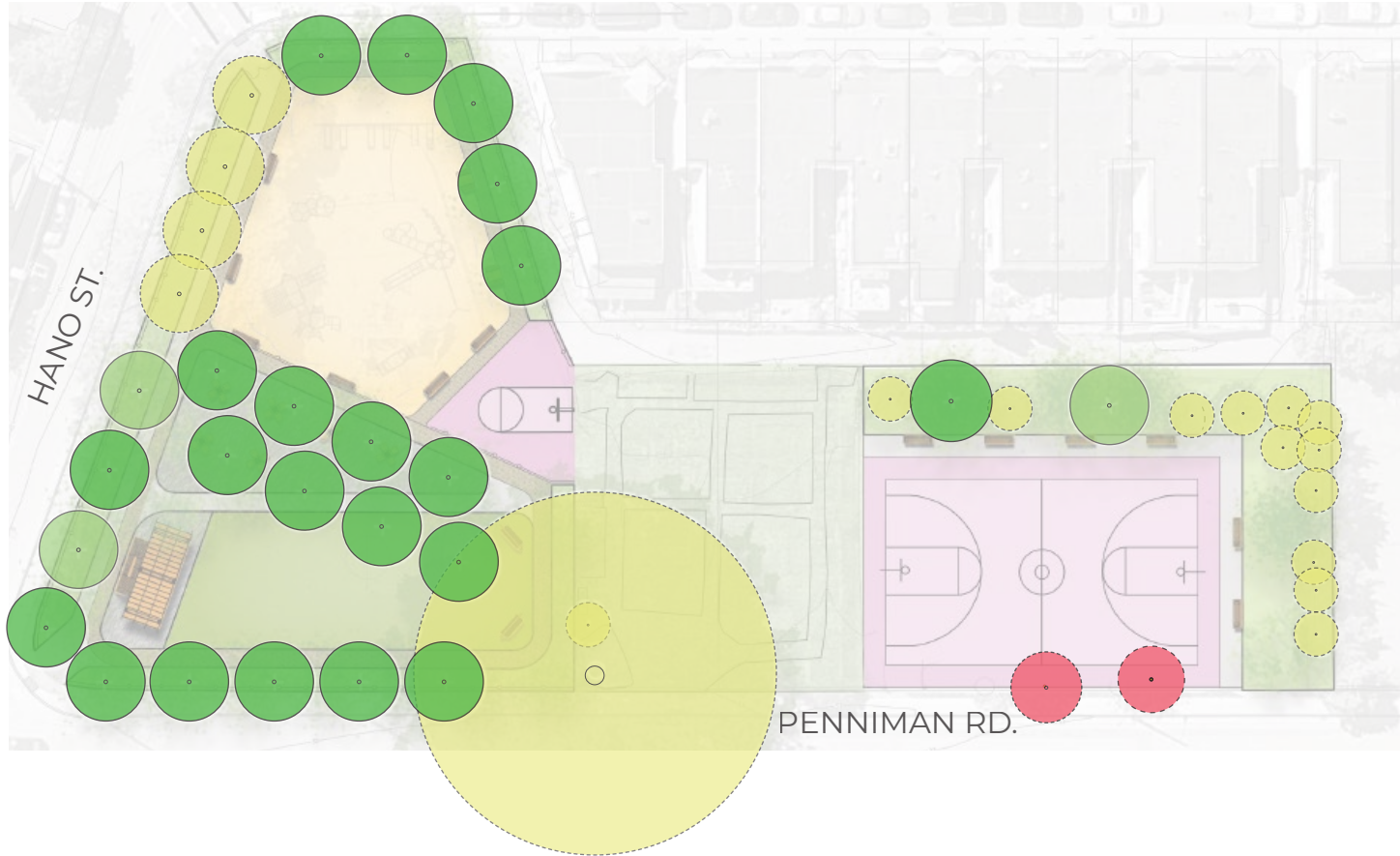

**COURT SEATING**

# TREE PLANTING STRATEGY



## LEGEND

-  Existing to Remain
-  To be removed (2)
-  To be replaced (3)
-  Proposed (+/- 20)

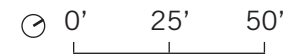

# TEAM LISTENING & COMMUNITY DISCUSSION

A blue-tinted photograph of a park path. The path is paved and runs through a wooded area with large trees. A chain-link fence runs along the path. In the background, there are people walking and sitting on a bench. A white van with a blue logo is visible on the left side of the path. The overall scene is bright and sunny.

# FENCING OPTION 01: PERIMETER

At the playground

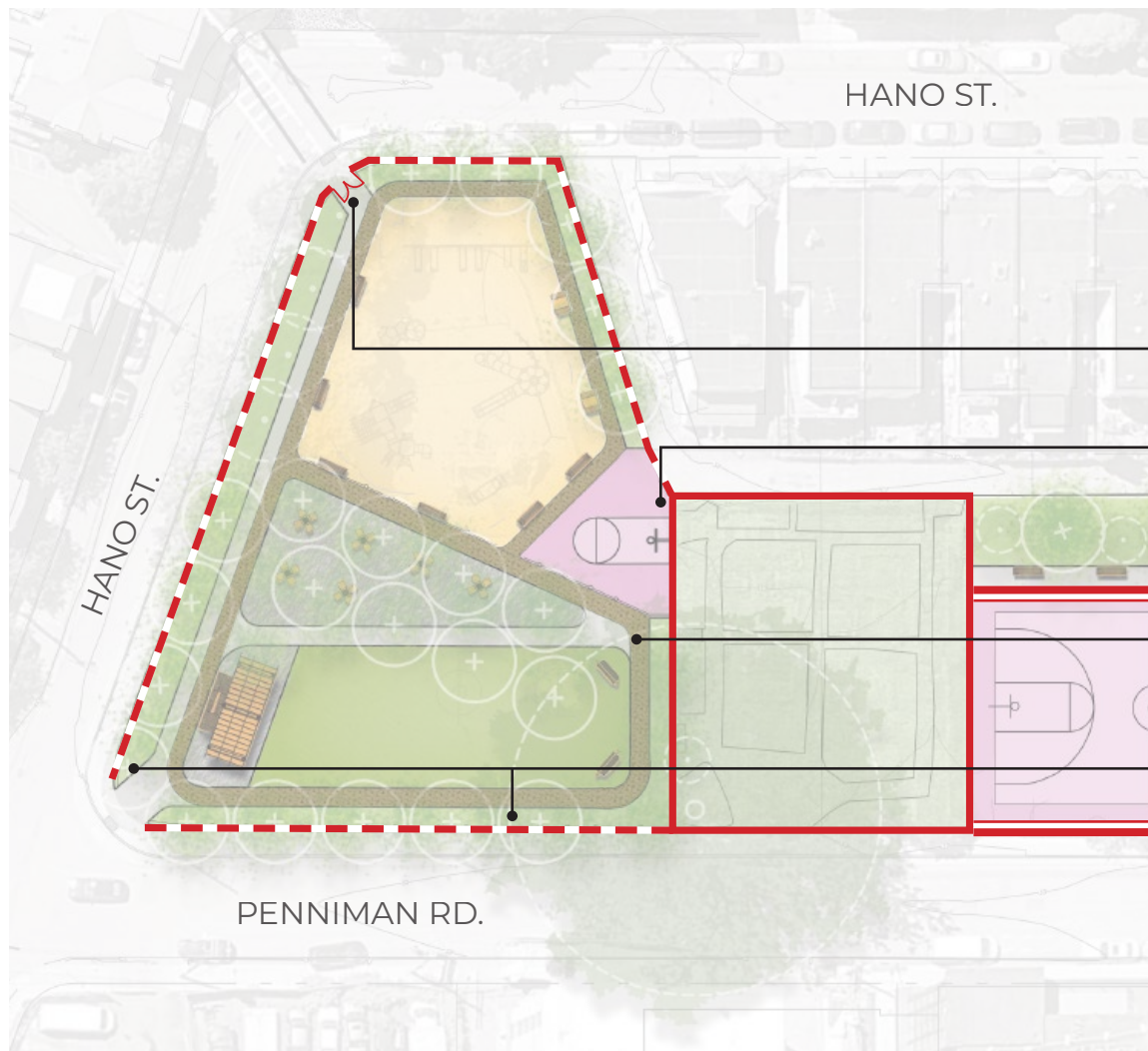

## LEGEND

- 4' Perimeter Fence
- 10' Garden Fence
- 10' Court Fence

Gate allows for play area to feel more enclosed.

Mini-court is enclosed on one side using existing garden fence.

Trike Loop extends across Lawn, Tree Grove, and Play areas.

Perimeter fences on both Penniman Road and Hano St.

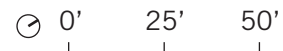



\* Note: Playground elements shown are placeholders for future selections.

# FENCING OPTION 02: ENCLOSED PLAYGROUND

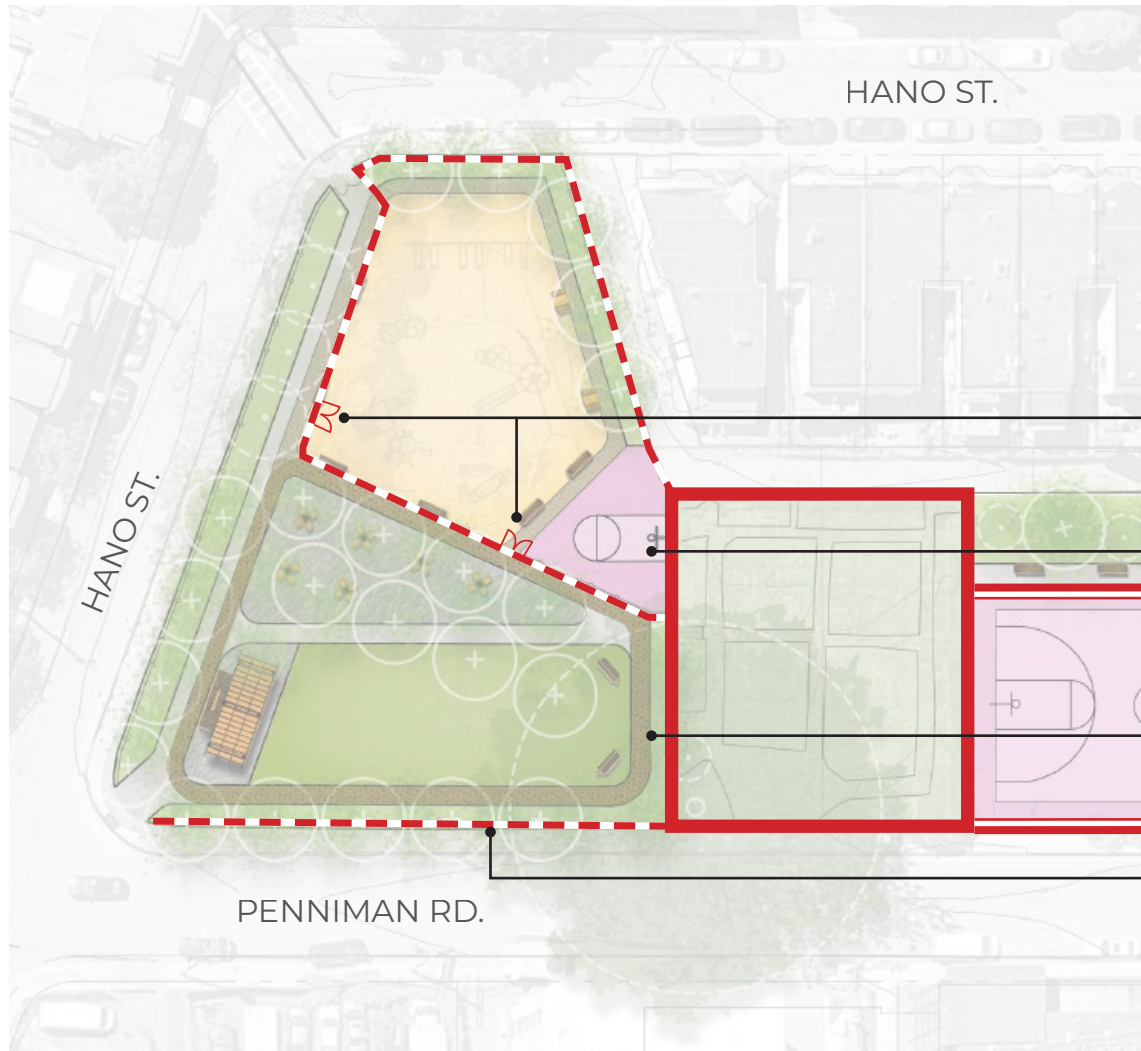
At the playground



## LEGEND

-  4' Perimeter Fence
-  10' Garden Fence
-  10' Court Fence

Play Area is fully enclosed and includes gates for entry/exit.

Mini-court is enclosed on two sides using existing garden and proposed play area fences.

Trike Loop extends around lawn only.

Perimeter fence on Penniman Road.

0' 25' 50'



\* Note: Playground elements shown are placeholders for future selections.

# FENCING OPTION 03: INTERNAL FENCE

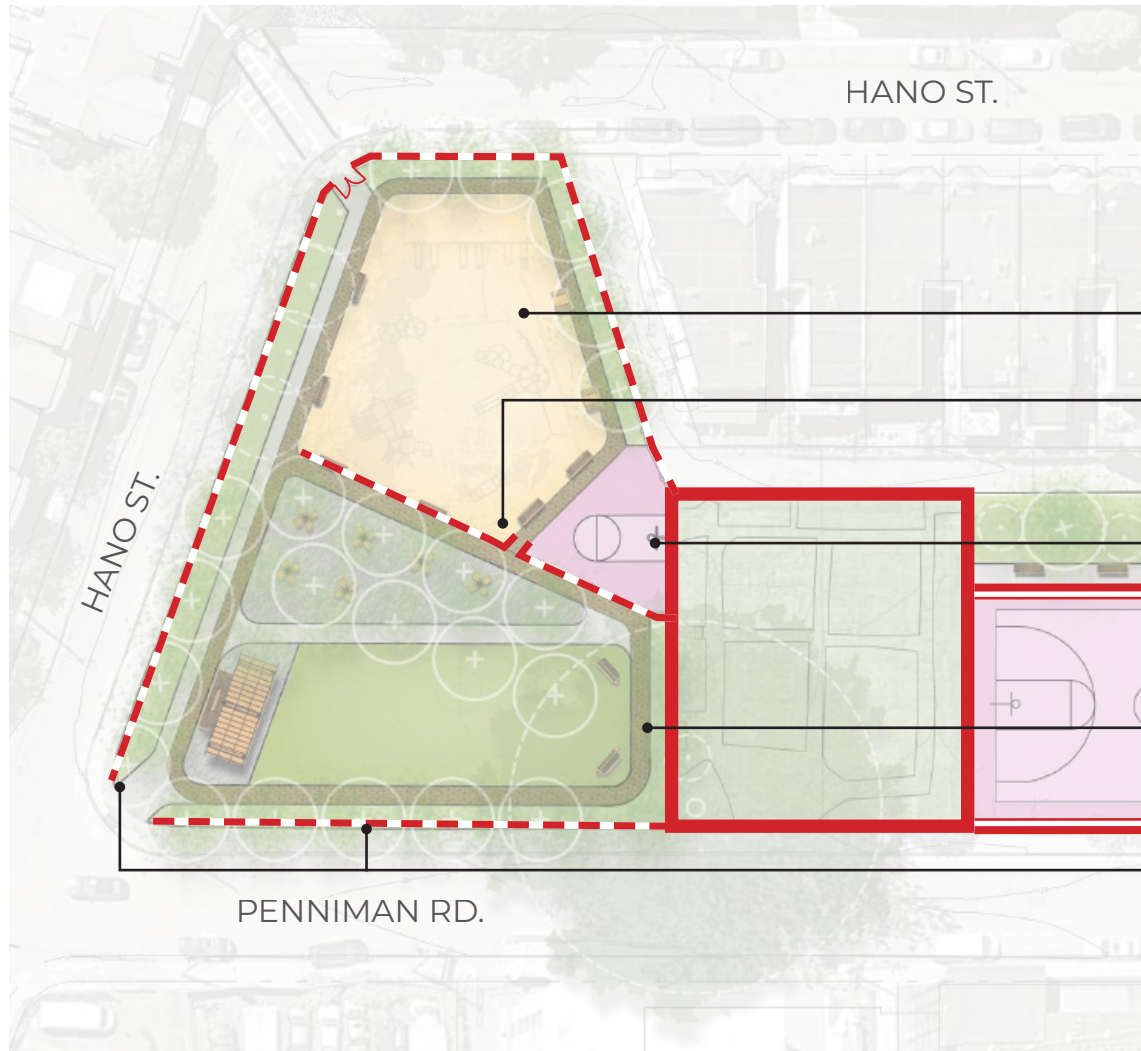
Separate playground from flexible program



## LEGEND

-  4' Perimeter Fence
-  10' Garden Fence
-  10' Court Fence

- Play Area is partially enclosed on two sides.
- Mini-court and play area are separated by fence opening for the trike loop.
- Mini-court is enclosed on two sides using existing garden and proposed play area fences.
- Trike Loop extends across Lawn, Tree Grove, and Play areas.
- Perimeter fences on both Penniman Road and Hano St.

0' 25' 50'

\* Note: Playground elements shown are placeholders for future selections.

# FENCING OPTIONS: COMPARE



What is your preferred fencing strategy?



## OPTION 01:

### PERIMETER FENCE

- The playground, kids court, lawn, and tree grove are connected.



## OPTION 02:

### ENCLOSED PLAY

- Playground is entirely enclosed. Trike loop is smaller and separated from the playground.

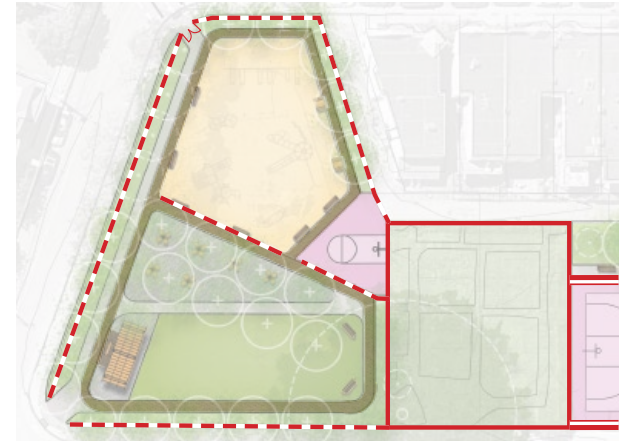

## OPTION 03:

### INTERNAL FENCE

- Integrates trike loop with the playground. Perimeter fence with an internal fence for some separation between play and flexible program.

# THIS.... OR THAT?

WHERE DO YOU PREFER THE LOWER HOOP FOR YOUNGER AGES?



THE KIDS COURT



**OR**



Keep the lower basketball hoop for younger kids separate from the full-sized court.

Integrate the lower basketball hoops into the full-sized court.

# THIS... OR THAT?

WHICH PLAY EQUIPMENT DO YOU PREFER?



THE PLAYGROUND



BIGGER IS BETTER!  
One big play piece



OR



MORE THE MERRIER!  
Medium play piece + a few small pieces

# THIS.... OR THAT?

SHADE STRUCTURE OR PORCH SWINGS AT THE LAWN?



THE LAWN



OR



Offer a shade structure over the large gathering plaza.

Offer porch swings that overlook the lawn.

# PLAY EQUIPMENT | AGE 5-12

Which multi-level play elements do you prefer?



THE PLAYGROUND



Tower with Sensory Play

**OR**



Tower with Small Net

**OR**



Large Climbing Net

# PLAY EQUIPMENT | AGE 2-5

Which do you prefer?



THE PLAYGROUND



OR



Dispersed Individual Elements  
with climbing, sliding, and spinning

Large Central Play House  
with climbing and imaginary play

# SENSORY PLAY DISCUSSION

Which type of sensory play do you prefer?



Sound

**OR**



Music

**OR**



Touch and Sound



Movement and Sound

**OR**



Touch and Graphics

**OR**



Learning Panel



# TAKE THE COMMUNITY MEETING 3 SURVEY:



[bit.ly/pennimansurvey](https://bit.ly/pennimansurvey)

# CLOSING REMARKS & NEXT STEPS

The background image shows an outdoor park area. In the foreground, there is a wooden picnic table on a paved surface. Behind it is a chain-link fence. In the background, there is a large tree, a building under construction with scaffolding, and other residential buildings under a clear blue sky with some light clouds.



# This is our final meeting!

For questions, maintenance requests or concerns regarding any of our parks contact 311



To learn more, visit the project website:

**[boston.gov/penniman-road-play](https://boston.gov/penniman-road-play)**

For questions or comments about this project,  
contact Max Sell

**[max.sell@Boston.gov](mailto:max.sell@Boston.gov)**

June 23, 2026

Boston Parks and Recreation

