

EXISTING

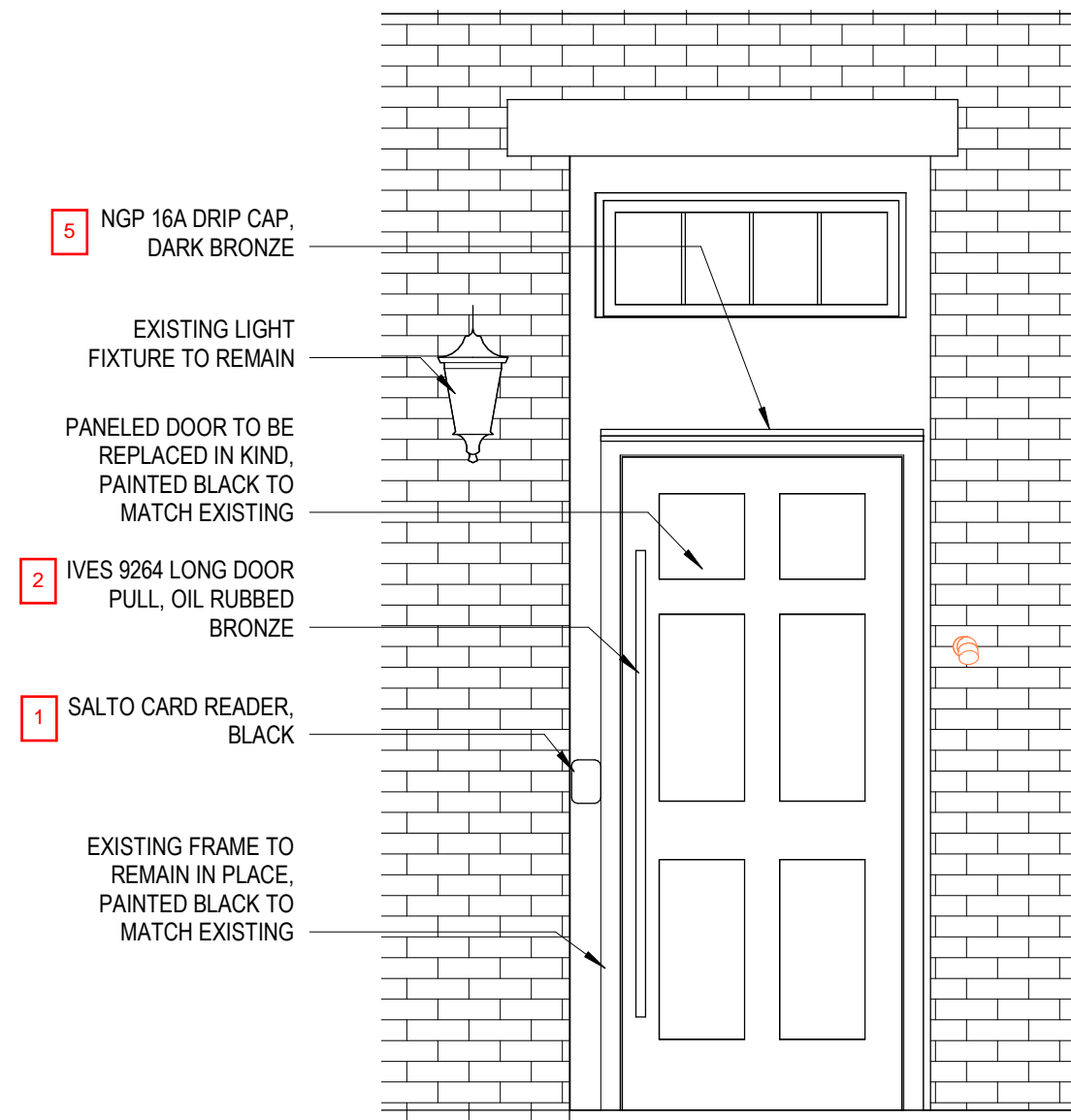

GENERAL NOTE: EXISTING DOOR INSTALLED 2000

PROPOSED



HARDWARE AND FINISHES

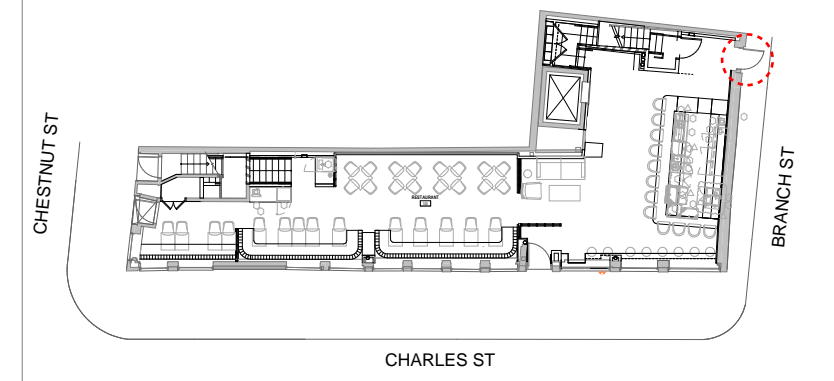
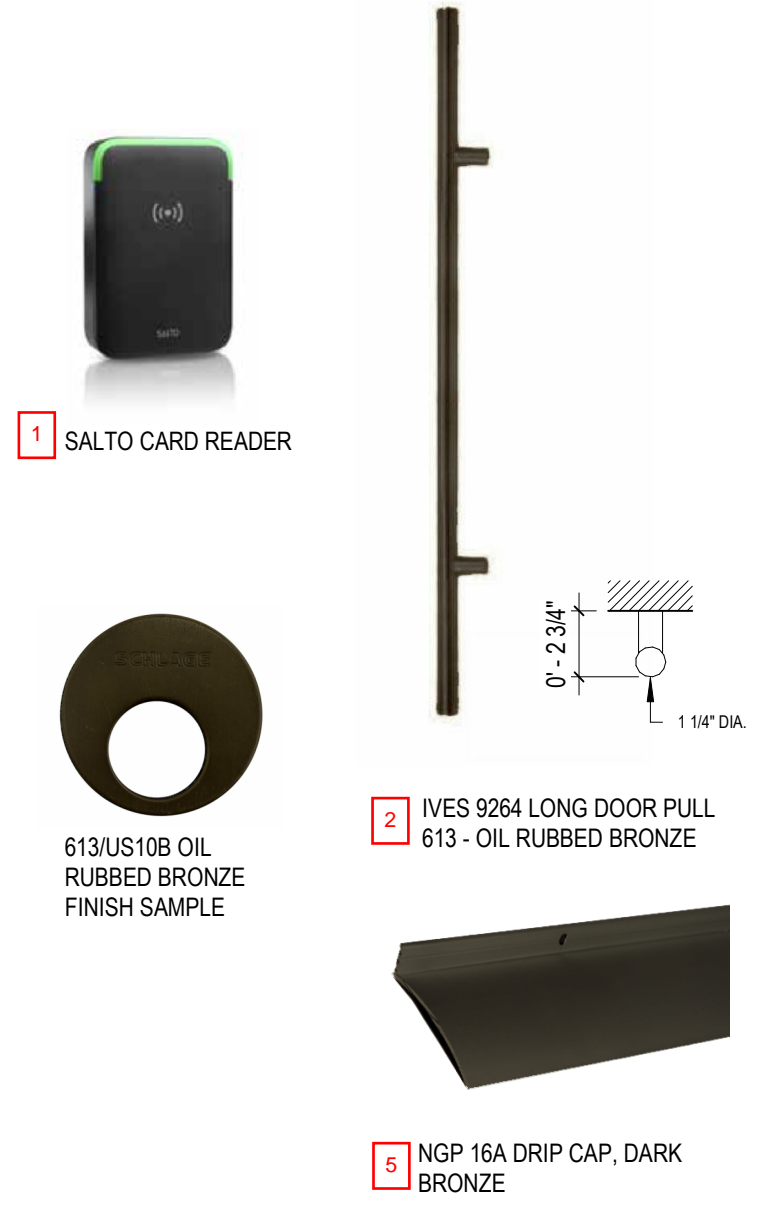



EXISTING



GENERAL NOTE: EXISTING DOOR INSTALLED 2000

PROPOSED

- 5 NGP 16A DRIP CAP, DARK BRONZE
- EXISTING DOOR AND FRAME TO REMAIN IN PLACE, PAINTED BLACK TO MATCH EXISTING. EXISTING HARDWARE REMOVED AND PATCHED.
- 4 LCN ACTUATOR FOR AUTOMATIC OPERATOR
- 2 IVES 9264 LONG DOOR PULL, OIL RUBBED BRONZE
- 3 SCHLAGE B600 SERIES DEADBOLT, OIL RUBBED BRONZE

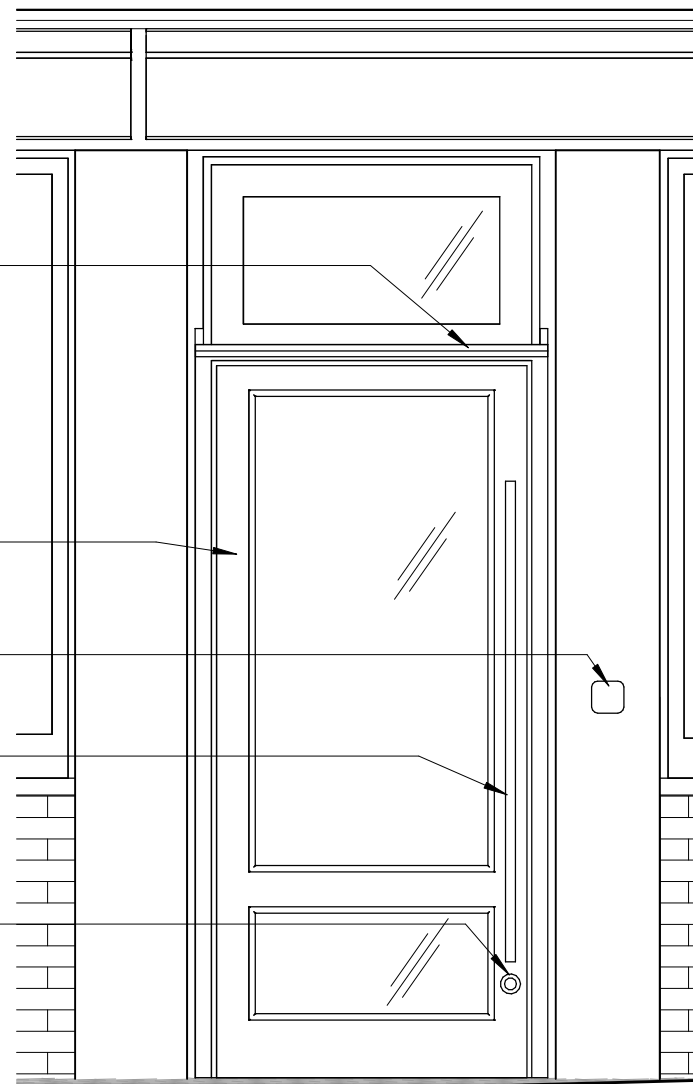

HARDWARE AND FINISHES

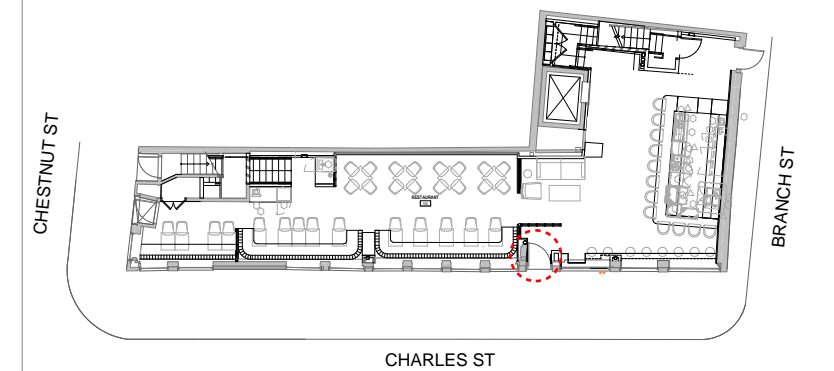
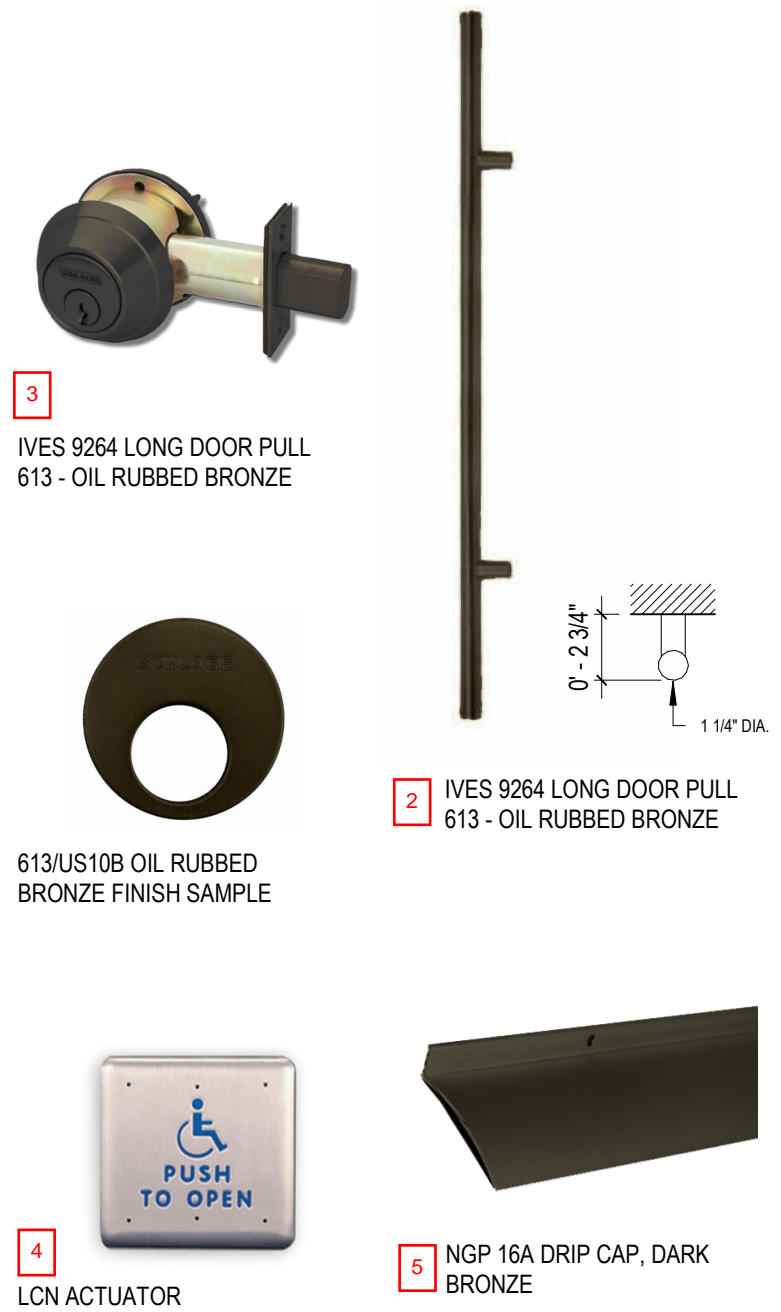

EXISTING



GENERAL NOTE: EXISTING DOOR INSTALLED 2000

PROPOSED

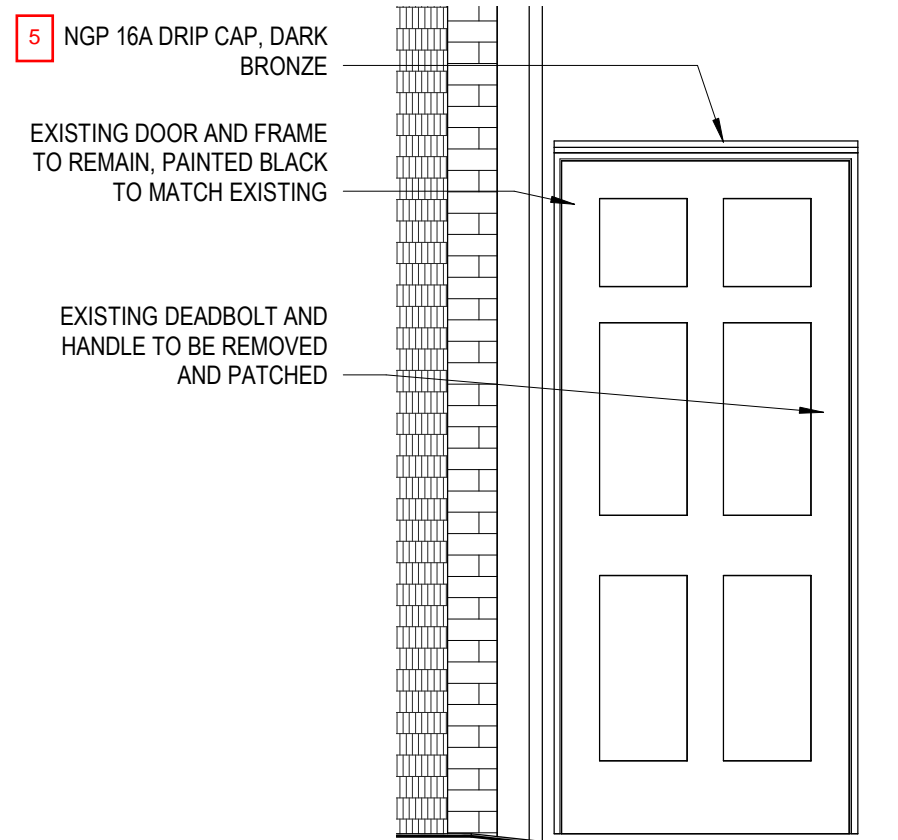

HARDWARE AND FINISHES



5 NGP 16A DRIP CAP, DARK BRONZE

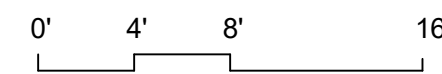
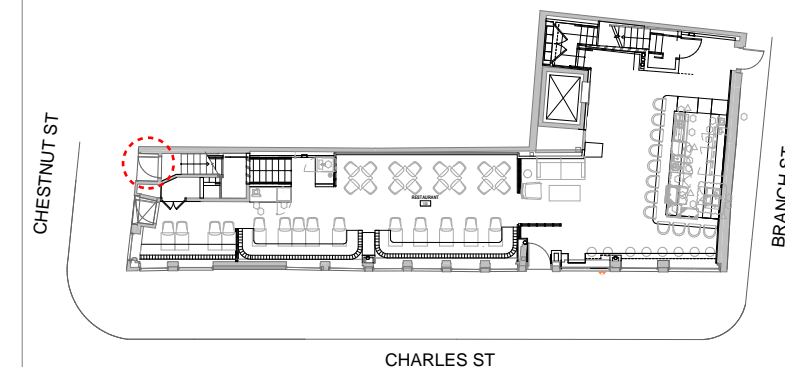



EXISTING



GENERAL NOTE: EXISTING DOOR INSTALLED 2000

PROPOSED

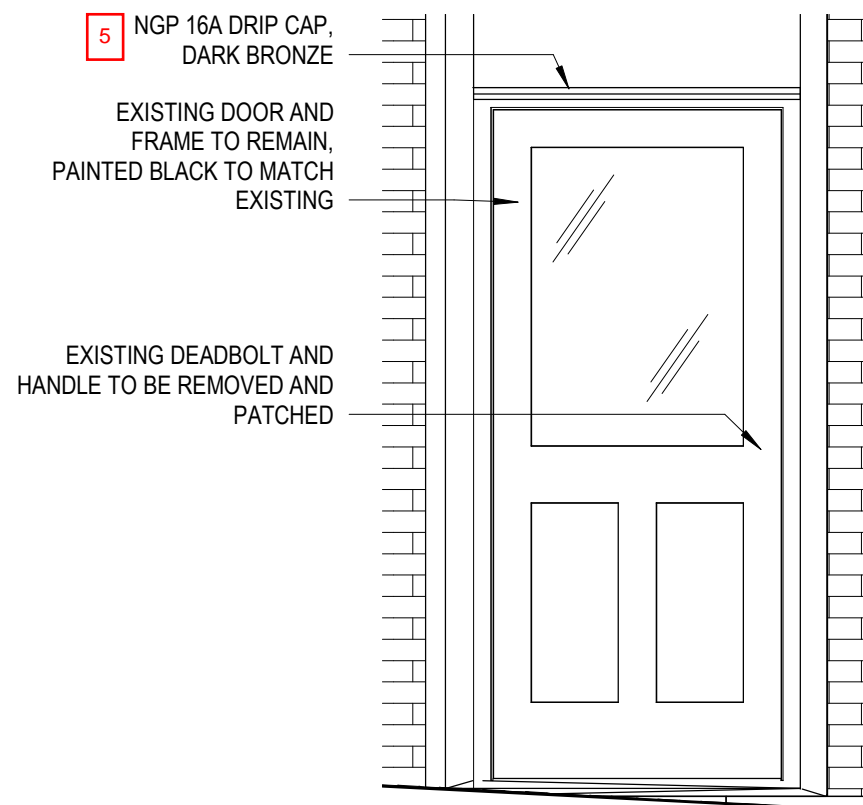

HARDWARE AND FINISHES



5 NGP 16A DRIP CAP, DARK BRONZE

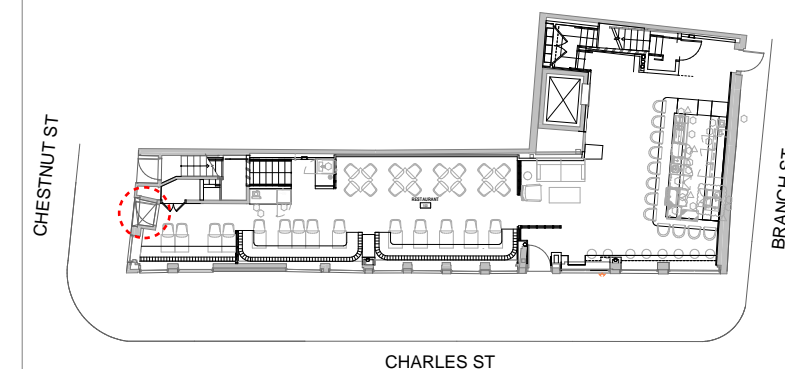

CHARLES ST



1

## SALTO XS4 WALL READER

The SALTO XS4 Wall Reader 2.0 incorporates the cutting-edge design standard of the XS4 2.0 product range in this technological powerhouse. The SALTO XS4 Wall Reader 2.0 in combination with the SALTO XS4 2.0 Controller, facilitates the integration of the wall reader with almost any SALTO interface such as SALTO ProAccess SPACE, to provide your facility with a complete security solution.

This wall reader has been designed to fit on standard ANSI electrical box.

### XS4 WALL READER 2.0: STANDARD

#### WRDB0A04

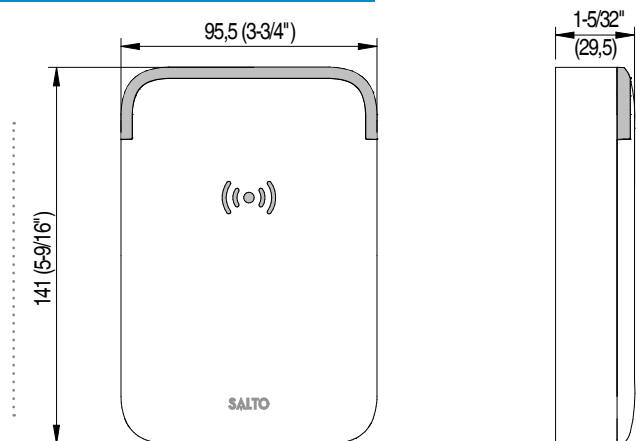

#### MAIN FEATURES:

- Modern aesthetic design with clear LED signaling.
- Conical shape.
- Fully integrated with the SALTO XS4 platform.
- Virtual network capable through SALTO Virtual Network technology.
- ID technologies available: DESfire, DESfire EV1, Mifare, Mifare plus, Mifare Ultralight C, SKIDATA and Bluetooth Low Energy.
- NFC compatible.
- All communications between the carrier and the wall reader are encrypted and secure<sup>2</sup>.
- Acoustic and optical signalling, dual colour green/red to indicate access authorisation.
- Available in 2 different finishes: White and Black.
- Concealed fixing screw for greater security and improved aesthetics.
- Contactless reading of the carrier, Reading distance up to 35mm (depending on the credential).

#### MECHANICAL ASPECTS:

- Dimensions: 95,5mm x 141mm x 29,5mm (W x H x D).

#### CERTIFICATIONS:

- IP 66 compliant, suitable for outdoor and indoor use.
- CE conform (pending).
- UL 294 (pending).
- FCC certified (pending).

- The maximum cable length between the door controller and the wall reader is 400meters<sup>1</sup>, using a twisted pair cable.
- Connection to the door controller using AWG24 twisted pair or AWG18 cable connection.
- Powered by the controller.
- Emergency opening by means of contactless portable programming device (PPD).

#### INSTALLATION:

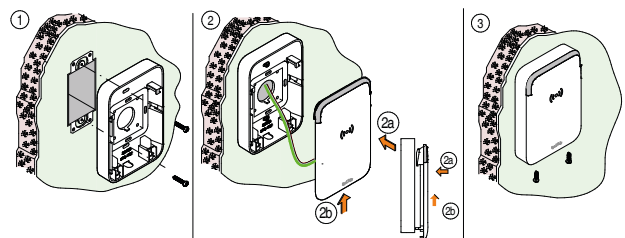

#### COMPATIBLE WITH STANDARD ANSI ELECTRICAL BOX

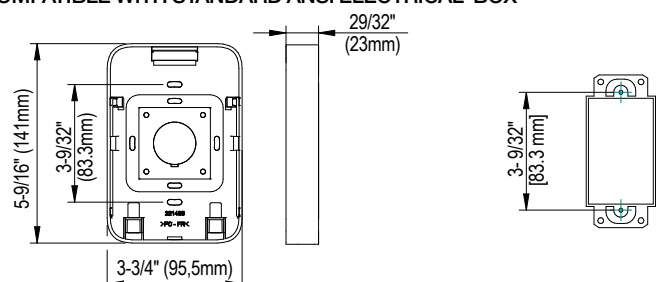

<sup>1</sup> Depending on the cable.

<sup>2</sup> Depending on the card and the RFID technology

**9264 Offset long door pull, rounded tip**  
**9266 Straight long door pull, rounded tip**



9266 Straight long door pull

- 1-1/4" Diameter tubular bar
- Round tip is standard
- Optional flat Tip (F) is available. Specify F after model number when ordering.
- Available in whole 1" increments from 12" to 96"
- *Other lengths available as engineering special, consult customer service.*

**Certifications**

- Meets ANSI A156.06

**Mounting**

- Heavy duty mounting hardware exceeds industry standards
- 3/8-16 mounting hardware
- Specify door thickness. Standard mounting hardware for door thickness of 1-1/2" to 1-3/4" unless otherwise specified. Optional package available for 2" and 2-1/4" thick doors.
- Comes standard with through bolt screws and decorative washers.
- Optional mounting hardware available (see general information section for details) A, I, L, N, O, P, Q, X
- *Mounting hardware for other door thicknesses are available as engineering special, consult customer service.*

**Standard lengths**

Product number	Projection	Clearance	Offset	Overall Length	CTC
9264-72-56	2-3/4"	1-1/2"	1 5/8"	72"	56"
9264-36-20	2-3/4"	1-1/2"	1 5/8"	36"	20"
9264-24-18	2-3/4"	1-1/2"	1 5/8"	24"	18"
9264-18-12	2-3/4"	1-1/2"	1 5/8"	18"	12"
9264-12-8	2-3/4"	1-1/2"	1 5/8"	12"	8"
9266-72-56	2-3/4"	1-1/2"	—	72"	56"
9266-36-20	2-3/4"	1-1/2"	—	36"	20"
9266-24-18	2-3/4"	1-1/2"	—	24"	18"
9266-18-12	2-3/4"	1-1/2"	—	18"	12"
9266-12-8	2-3/4"	1-1/2"	—	12"	8"

**Material substrate**

- Made from brass or stainless steel (316 Series)
- 316 Series Stainless Steel standard, exceeding industry standards for corrosion resistance
- Recommended for external applications

**Finishes**

BHMA	Description	Substrate	Finish
605	Bright brass	Brass	US3
606	Satin brass	Brass	US4
613	Oil rubbed bronze	Brass	US10B
619	Satin nickel	Stainless Steel	US15
629-316	Bright stainless	Stainless steel	32-316
630-316	Satin stainless	Stainless steel	32D-316
630-AM	Satin stainless anti-microbial	Stainless steel	US32D-AM
631	Matte black	Stainless steel	BLK
643e/716*	Aged bronze	Stainless steel	643e/716

Note: For other colors, consult factory.

\* Max length for 643e/716 is 36".

**Additional information**

- If not specified, standard center to center length for pulls 36" or longer is 16" less than total pull length (8" from each end of the pull). Center to center length must be specified for lengths less than 36".
  - Ex. 72" Long pull has a 56" Center to Center
- If the center to center length is less than half the total pull length, consult customer service.
- Specify PR when ordering a set of push bars for back to back mounting
- For one back to back machined push bar, specify Nsgl or Psgl (glass doors)
- *Additional mounting post required for lengths greater than 96". Mid posts are optional for other lengths. Specify mid post location when ordering.*

**Caution**

- Recommend the length of the ladder pull should not exceed 4" less than the door height



9264 Offset bracket



Round tip (Standard)

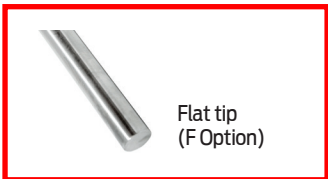

Flat tip (F Option)

Note: A middle position bracket is required for pulls over 8 feet.

Hinges & pivots **A**

Pulls & plates **B39**

Flush bolts & coordinators **C**

Latches, catches & bolts **D**

Stops **E**

Exterior hardware **F**

Miscellaneous hardware **G**



# Deadbolt designs

## B600 Series

Schlage's toughest heavy duty Grade 1 commercial deadbolt.

Furnished with conventional cylinder standard.

Also available with full size interchangeable core cylinder or small format interchangeable core (SFIC) cylinder.

Requires 2 1/8" (54mm) prep. UL10B and UL 10C listing standard for auxiliary lock on A label fire doors. Not all functions available as fire rated auxiliary locks. See function charts for required cross bore dimensions.



## B700 Series

Same lock as B600 Series but furnished with Primus XP controlled access cylinder for patented key control, geographical exclusivity and resistance to picking and impressioning. Also available with Primus XP full size interchangeable core cylinder.



## B800 Series

Same lock as B700 Series but Primus XP high security cylinder is UL437 listed to resist drilling and other forms of physical attack. Not available in interchangeable core.

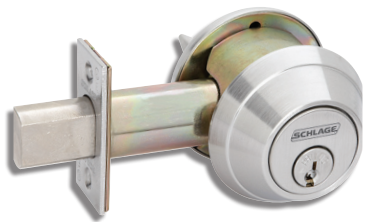

Thumbturn for B600, 700 and 800

All designs shown in 626 satin chrome

## Automatic Operator Actuators &amp; Accessories



**8310-853**  
Wall Mounted Actuator

- Hardwired low voltage actuator with stainless steel touch plate in 4-3/4" (121mm) square
- Engraved blue filled handicap symbol conforms to most accessibility codes
- Designed to mount in a flush or surface mount box (sold separately) in/on a vertical surface near the controlled door
- Optional mounting in single gang electrical box (by others) or double gang box (4" x 4" by others) or on an 8310-866 bollard post
- Heavy industrial grade components provide vandal resistant mounting and weather resistant switch standard



**8310-853T**  
Wall Mounted Actuator

- Same as the 8310-853, with the added engraving of "Push to Open"



**8310-853WP**  
Surface Mounted Actuator

- Wireless, low profile, low voltage actuator with square, stainless steel touch plate in 4-3/4" (121mm) square
- Engraved blue filled handicap symbol conforms to most accessibility codes
- Surface mount box includes integral transmitter w/ battery and actuator switch
- Heavy industrial grade components provide vandal resistant mounting and weather resistant switch standard
- Requires 8310-865 Receiver



**8310-853TWP**  
Surface Mounted Actuator

- Same as the 8310-853WP, with the added engraving of "Push to Open"

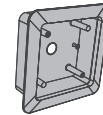

**8310-867F**  
Flush Mount Box

- Rugged Plastic Box
- 4-3/4" Square
- Optional accessory - can be used w/ any 4-3/4" square actuator

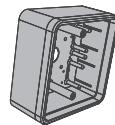

**8310-867S**  
Surface Mount Box

- Rugged Plastic Box, 4-3/4" Square
- Optional accessory - can be used w/ any 4-3/4" square actuator

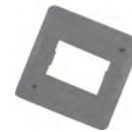

**8310-801**  
Weather/Trim Ring

- Plastic Weather Ring, 4-3/4" Square
- Optional accessory - can be used w/ any 4-3/4" square plastic mounting box

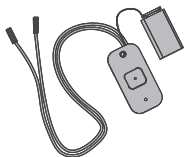

**8310-844**  
Transmitter

- Wireless, 1 Channel, 9v battery included
- Use to convert standard wall mount actuator to wireless
- Requires 8310-865 Receiver

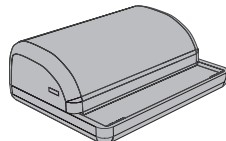

**8310-865**  
Receiver

- Wireless, 1 Channel, w/ Sequencing Feature
- Used in conjunction w/ Wireless Actuators & Transmitter(s)



**8310-813**  
Touchless Wall Mounted Actuator

- Hardwired low voltage actuator with plastic plate in 4-3/4" (121mm) square
- Optional mounting in single gang electrical box (by others) or double gang box (4" x 4" by others)





16

Rain Drip Guard

## PRODUCT CUT SHEET

PROJECT:

SUBMITTED BY:

DATE:

NOTES:

## Material

Aluminum Alloy 6063, T5 Temper

- ▶ BHMA Certified to ANSI/BHMA A156.22 Performance Tests for Heat and Cold
- ▶ 2 ½" Wide x 1 ½" Tall
- ▶ #6 x ¾" Stainless Steel SMS Furnished
- ▶ Screw Holes Slotted for Adjustment

## Finishes

16A Anodized Aluminum  
 16B Gold  
 16DKB Dark Bronze

## Options

FATT - Fast Attach Tape

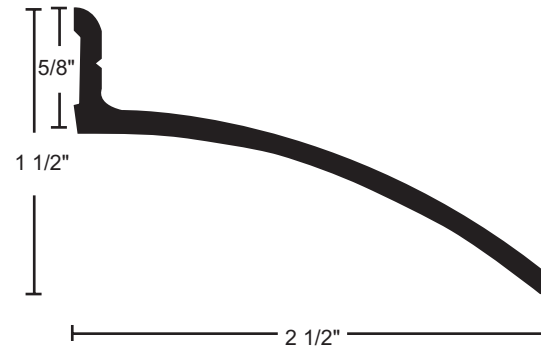

NGP-GKT-16-PCS-1220-A