



Improvements to
**CUTILLO
PLAYGROUND**

Community Meeting #3



MEETING RECORDING



The Boston Parks and Recreation Department will be recording the meeting and posting to our project webpage for those who are unable to attend the Zoom meeting live.

It is possible that participants may also be recording the meeting with their phones cameras or other devices. If you do not wish to be recorded during this meeting, please keep your microphone and camera off.

VIRTUAL MEETING ETIQUETTE

We want to ensure this conversation is a pleasant experience for all and that all community members/ stakeholders are comfortable sharing their comments, questions and feedback.

Please be respectful and mindful of each other's time when asking questions/ providing comments, so that all attendees are able to participate in the meeting.

Keep questions/ comments project-specific and not personal to yield solution-driven discussion.

Please wait until all attendees have had the opportunity to ask a question/ provide a comment before providing additional questions/ comments.

You can always set up a conversation with **Lauren Bryant**, lauren.bryant@boston.gov to further discuss the project or process.

ZOOM TIPS

Here is how you can participate during the question and answer part of the presentation.

DURING THE PRESENTATION:



VIA WEB:

Turn video on / off.

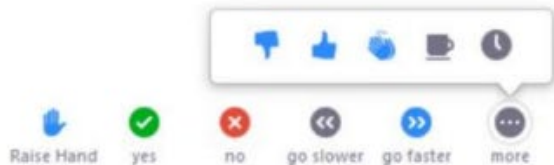

To use these non-verbal options click on participants (bottom of screen); these options will pop up in side bar.

DURING THE Q&A:



JOINING VIA PHONE?

Use *9 to raise hand to ask for audio / video permission to ask questions or provide comments.



VIA WEB:

Chat to ask questions / comments or provide responses to poll questions



Raise hand to ask for audio / video permission to ask questions or provide comments.

AGENDA

1 PROJECT TEAM INTRODUCTION

2 PROJECT OVERVIEW

3 SUMMARY OF 1st AND 2nd MEETINGS

4 PRESENTATION

5 LISTENING & DISCUSSION

6 CLOSING REMARKS & NEXT STEPS

PROJECT TEAM

Lauren Bryant

Project Manager

Lauren.Bryant@boston.gov or 617-961-3019

Christine Brandao

Outreach Coordinator, External Affairs

Christine.Brandao@boston.gov or 617-961-3006

Stantec Planning & Landscape Architecture

Kevin Beuttell, Project Manager

Shane Lougee, Project Manager

Adam Fearing, Project Landscape Designer

Sydney Trottier, Landscape Designer

John Romano

Office of Neighborhood Services

John.Romano@boston.gov



PROJECT SCHEDULE & FUNDING

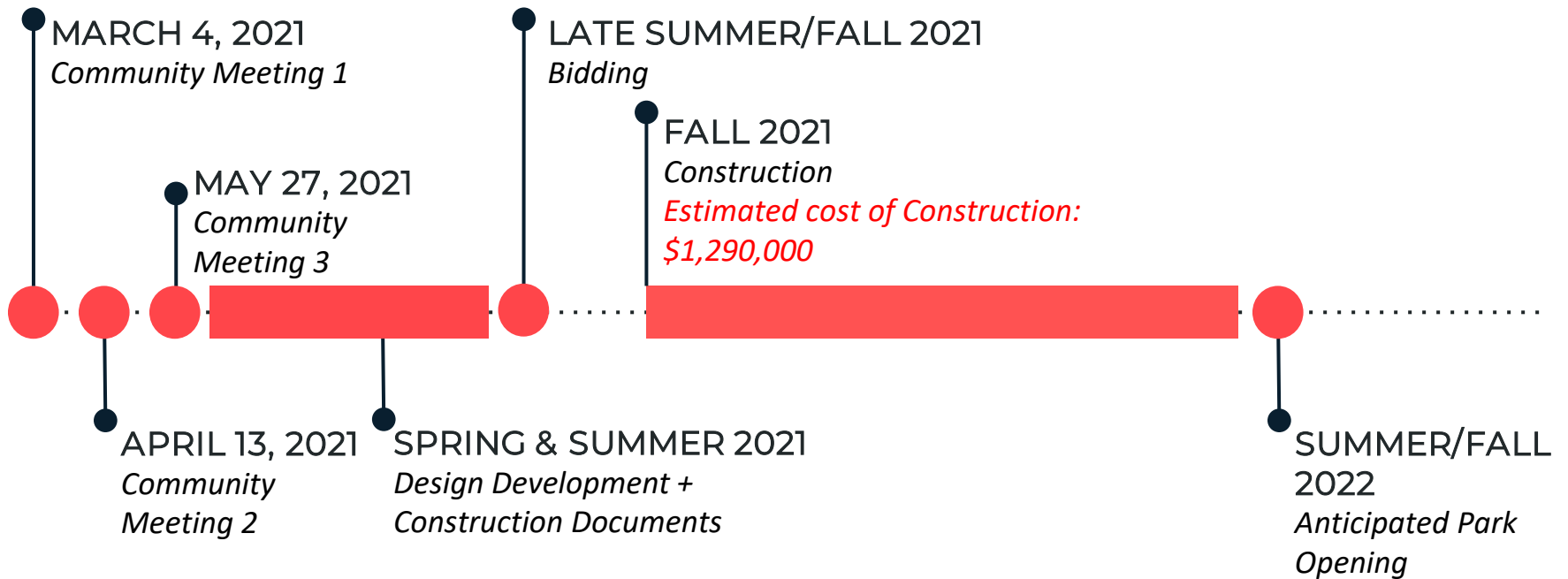

**Dates subject to change*

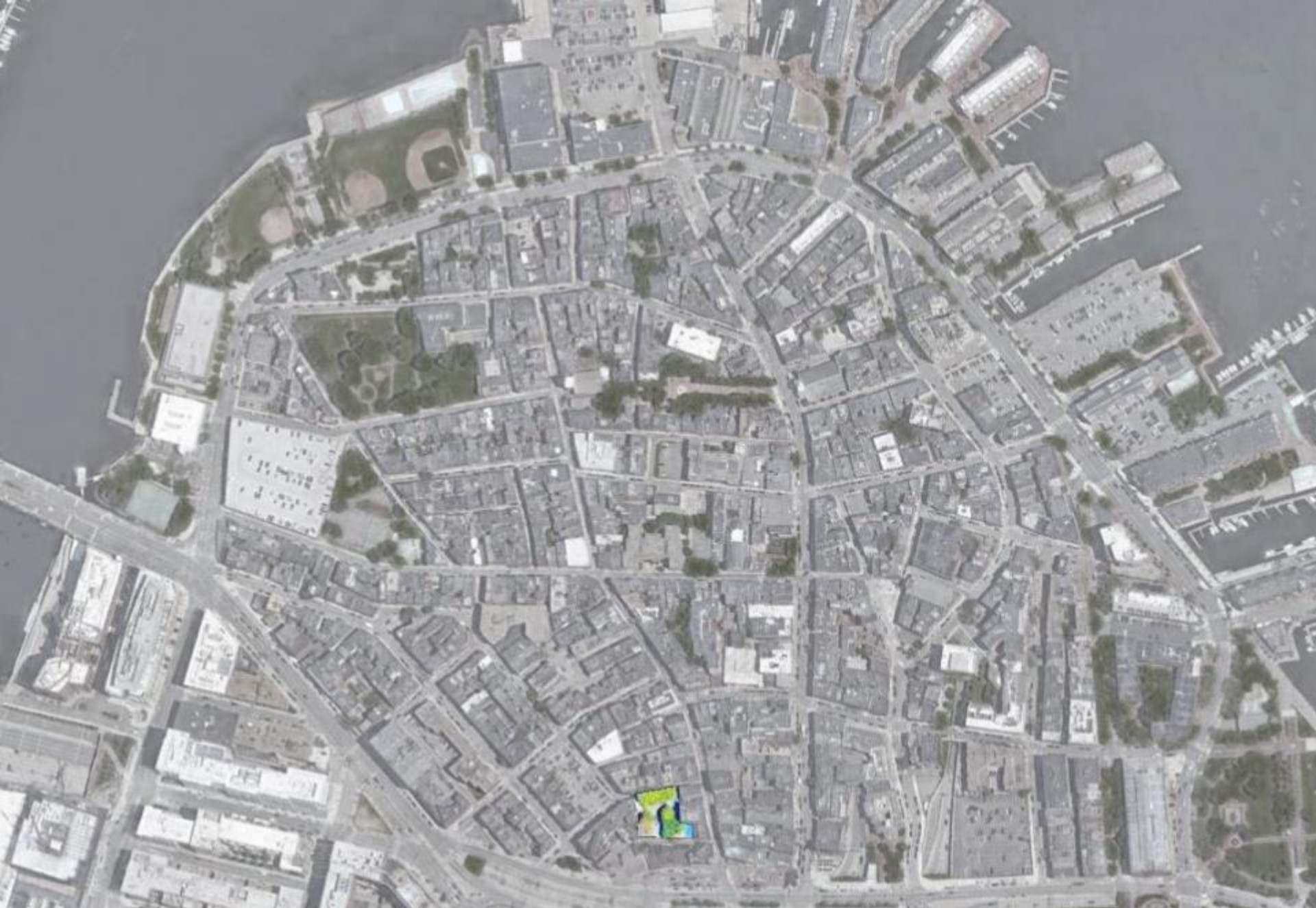

LOCATION



LOCATION



HISTORY: TODAY



AUGUST 31, 1923 No 6190



EXISTING CONDITIONS



12,300 SF

PROGRAMMED SPACE
7,660 SF – 62%

BASKETBALL
COURT

PLAY
EQUIP.

SWINGS

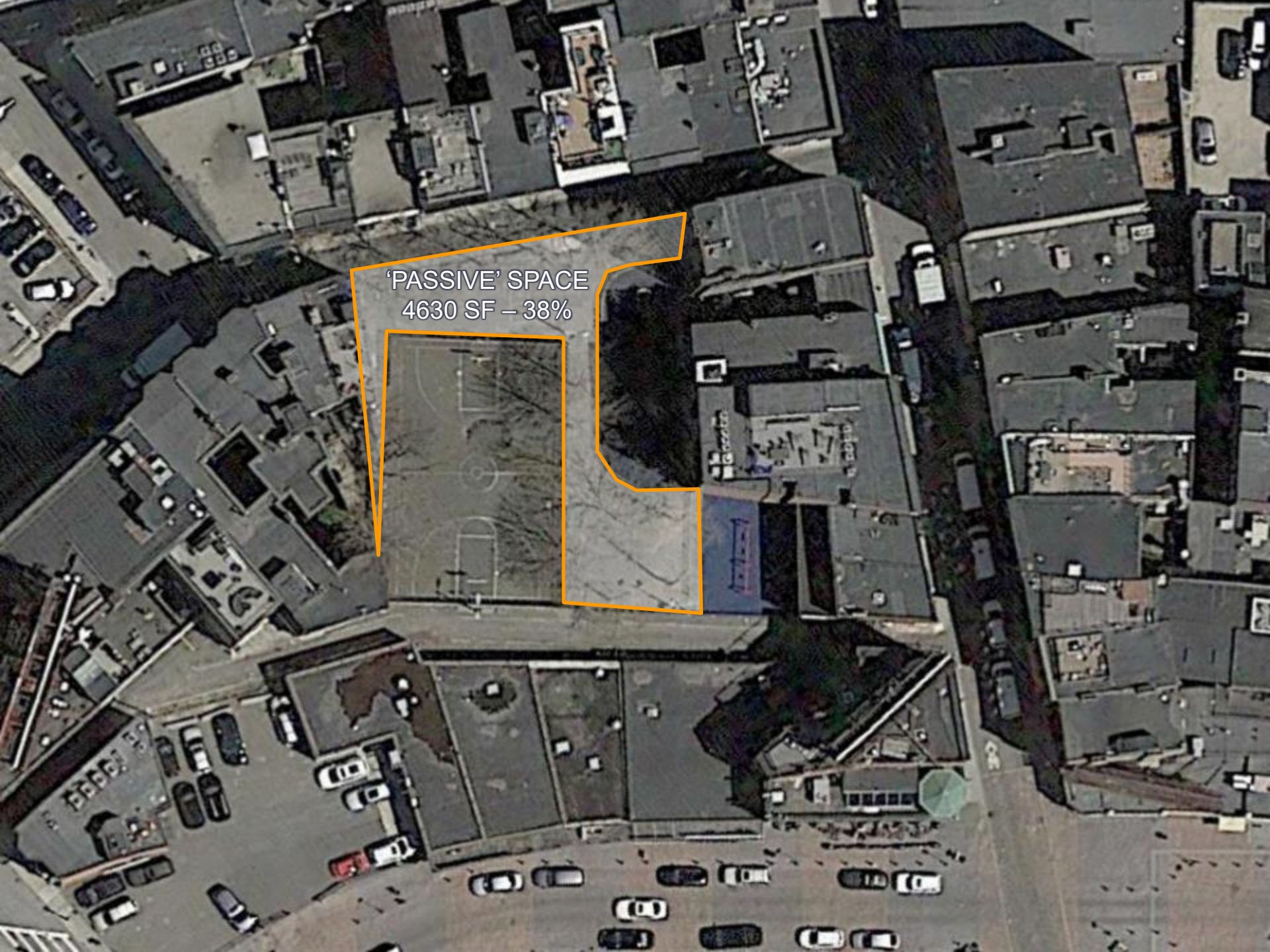
An aerial photograph of a city block with several buildings and a parking lot. A large, irregularly shaped area in the center is outlined in orange. This area contains a paved court with white markings, including a basketball key and a soccer goal. The surrounding buildings have dark roofs and some have signs. A parking lot with several cars is visible at the bottom of the image.

'PASSIVE' SPACE
4630 SF – 38%

-  Park
-  Playground 2-5
-  Playground 5-12
-  Basketball Court
-  Dog Park



5 MINUTE WALK RADIUS

CONSIDERATIONS: Surrounding Programming

INCORPORATE

- Nature play
- Adult exercise
- Preserve existing trees
- Flexible lawn space
- 5-12 play
- Incorporate play for older kids

MAINTAIN / PRESERVE

- Seating for older residents
- Existing trees
- Open visibility
- Historic pieces found during construction

IMPROVE

- Circulation through park including ADA access
- Court quality
- Lighting and visibility at night

INCREASE

- Greenery, but not block visibility
- Visitors to limit negative behavior

WHAT DO YOU LIKE TO DO AT CUTILLO PARK?

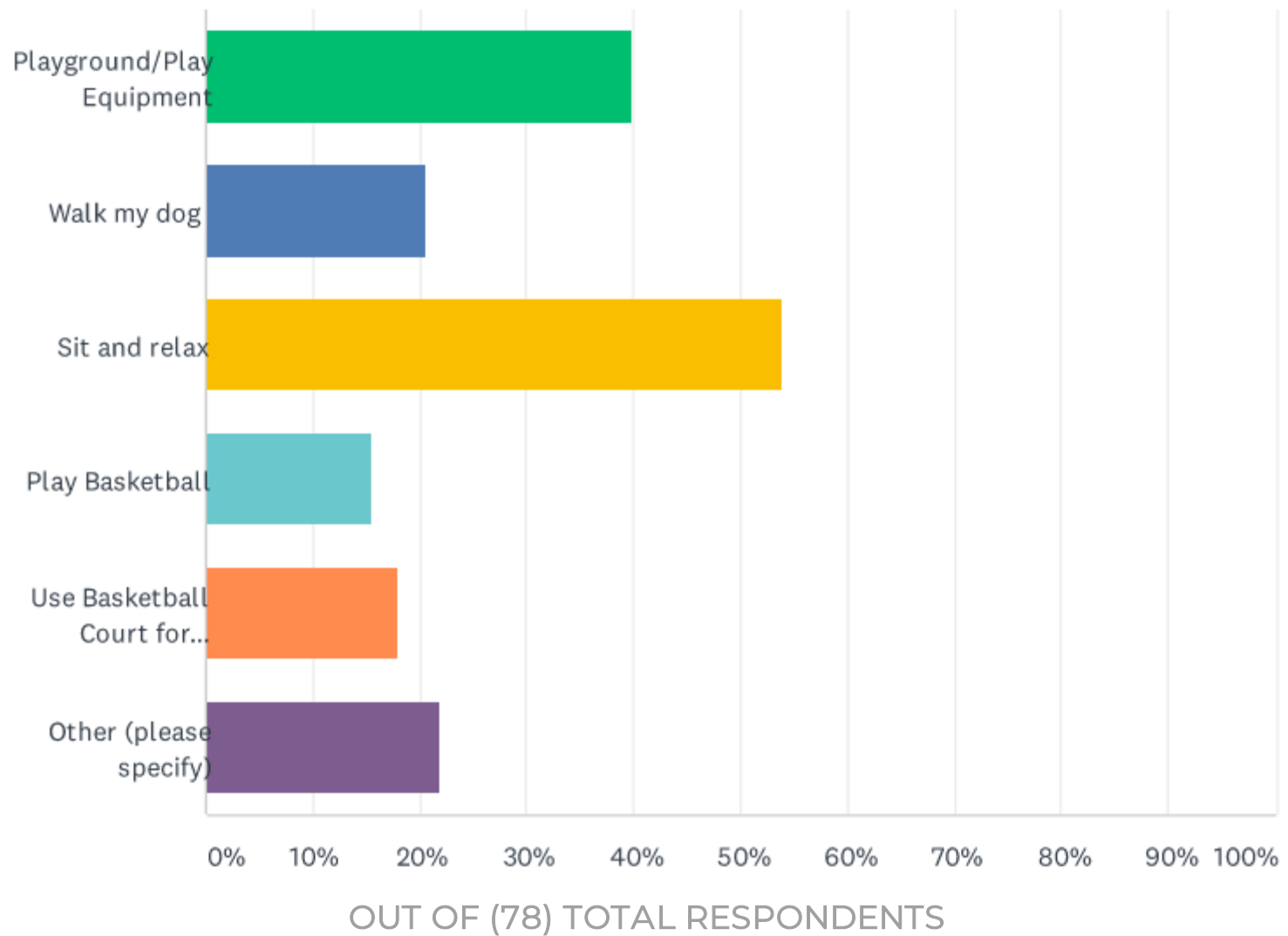

WHICH ENTRANCE DO YOU ENTER FROM MOST OFTEN?

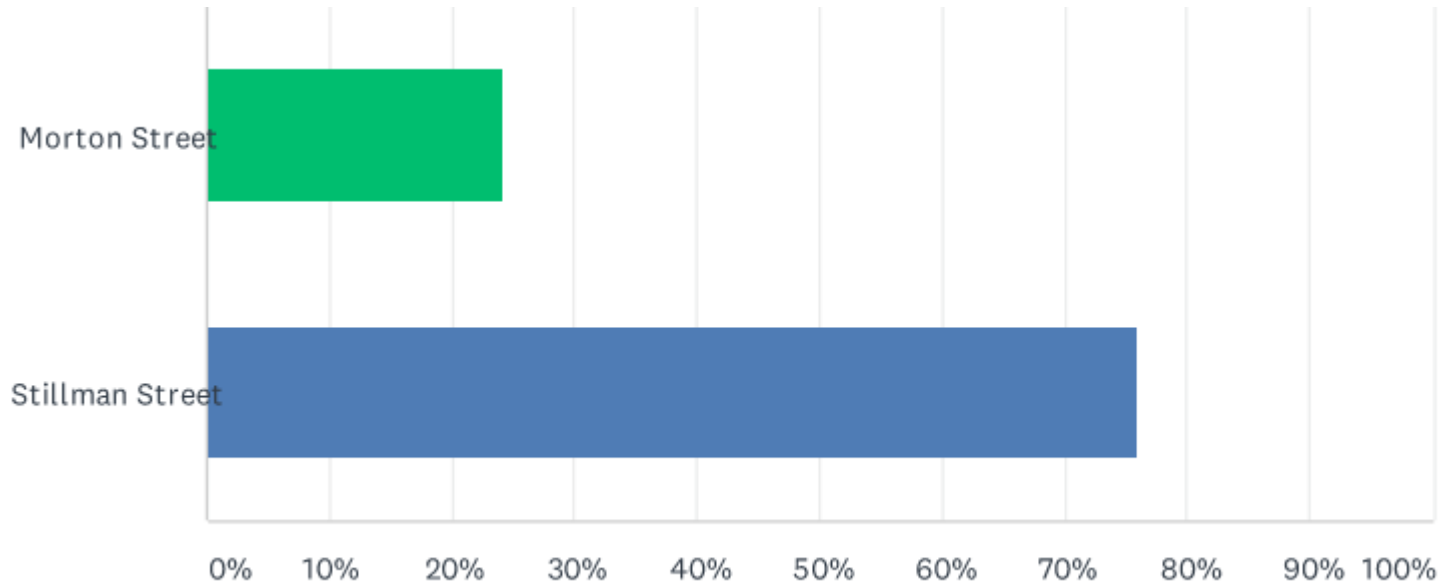

OUT OF (79) TOTAL RESPONDENTS

DO YOU PREFER A FULL-SIZE BASKETBALL COURT OR A HALF COURT?

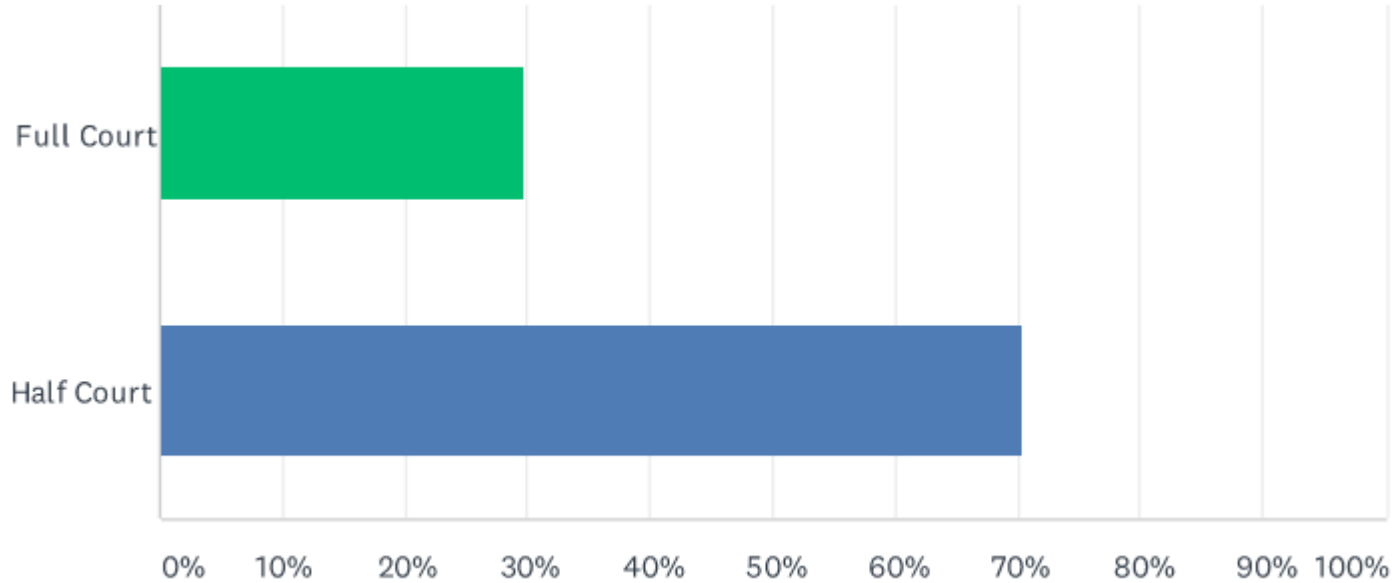

OUT OF (74) TOTAL RESPONDENTS

DO YOU PREFER AN OPEN PLAZA OR PLAZA FILLED WITH SEATING?

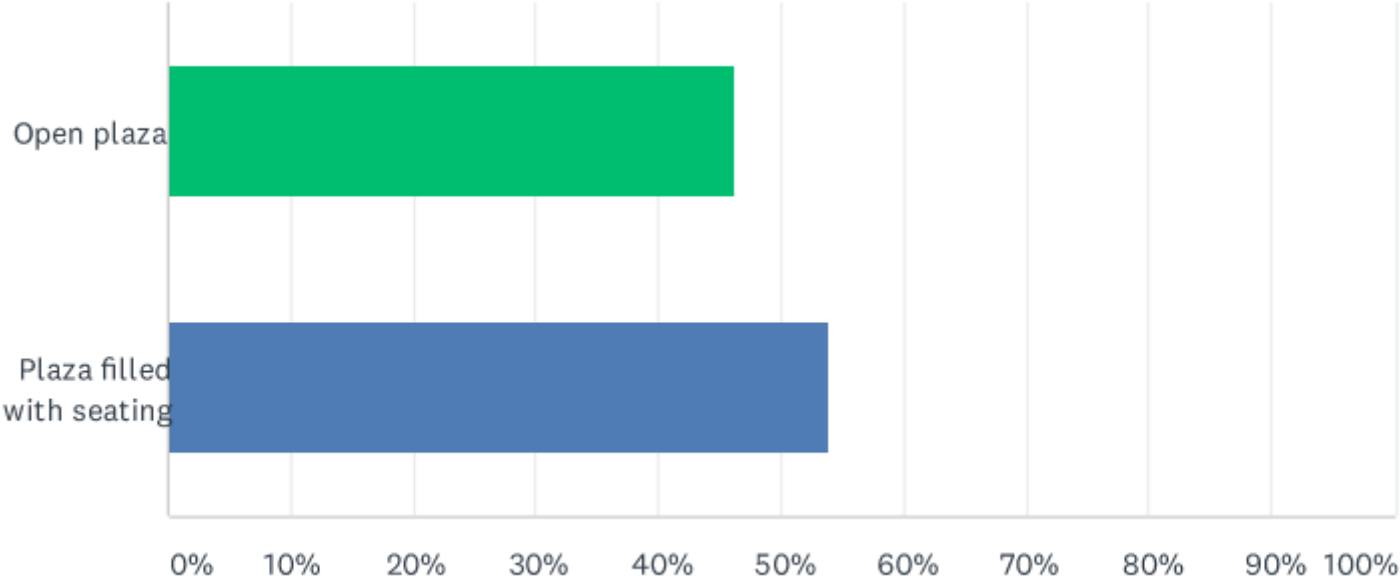

OUT OF (78) TOTAL RESPONDENTS

WHAT TYPE OF SEATING DO YOU PREFER IN THE PARK?

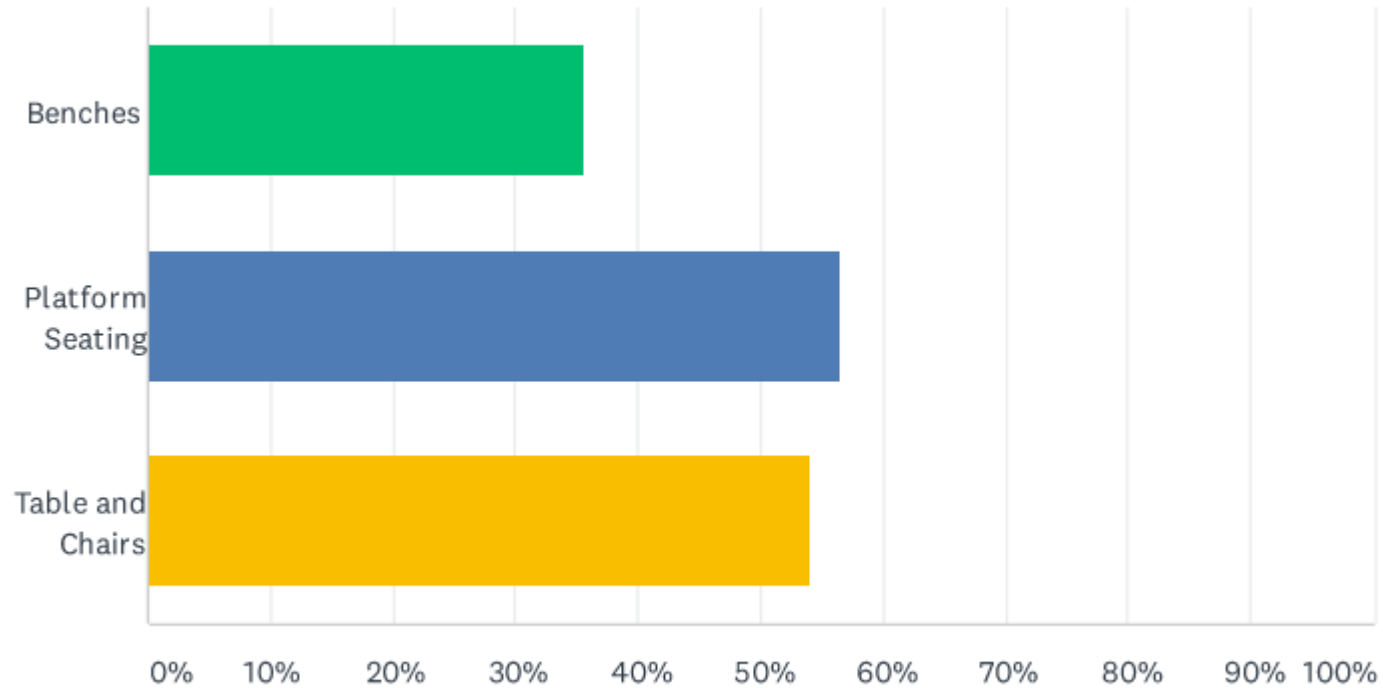

OUT OF (76) TOTAL RESPONDENTS

WHICH PARK ELEMENTS ARE MOST IMPORTANT TO YOU

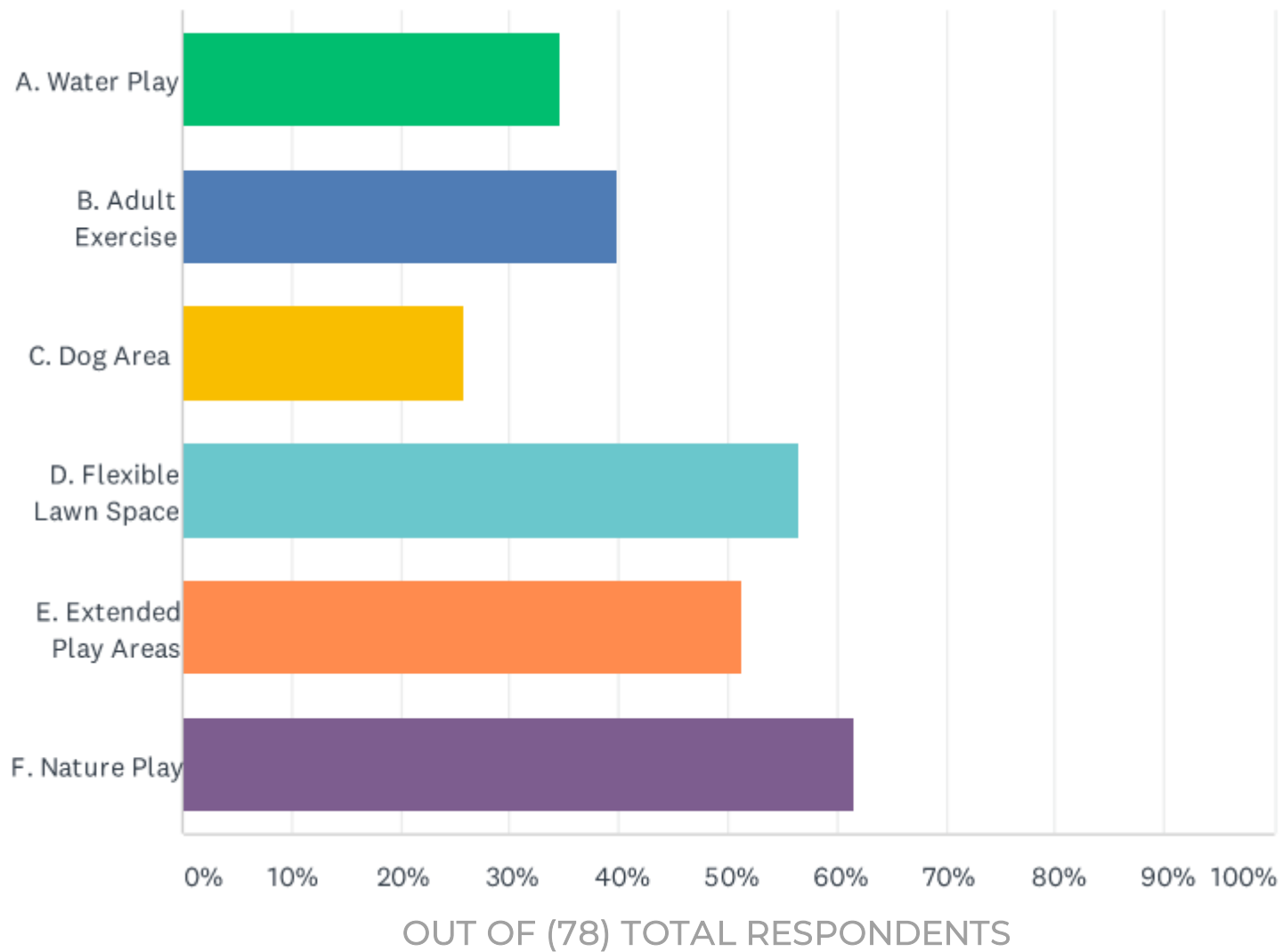

CREATING A FRAMEWORK FOR PARK LAYOUT

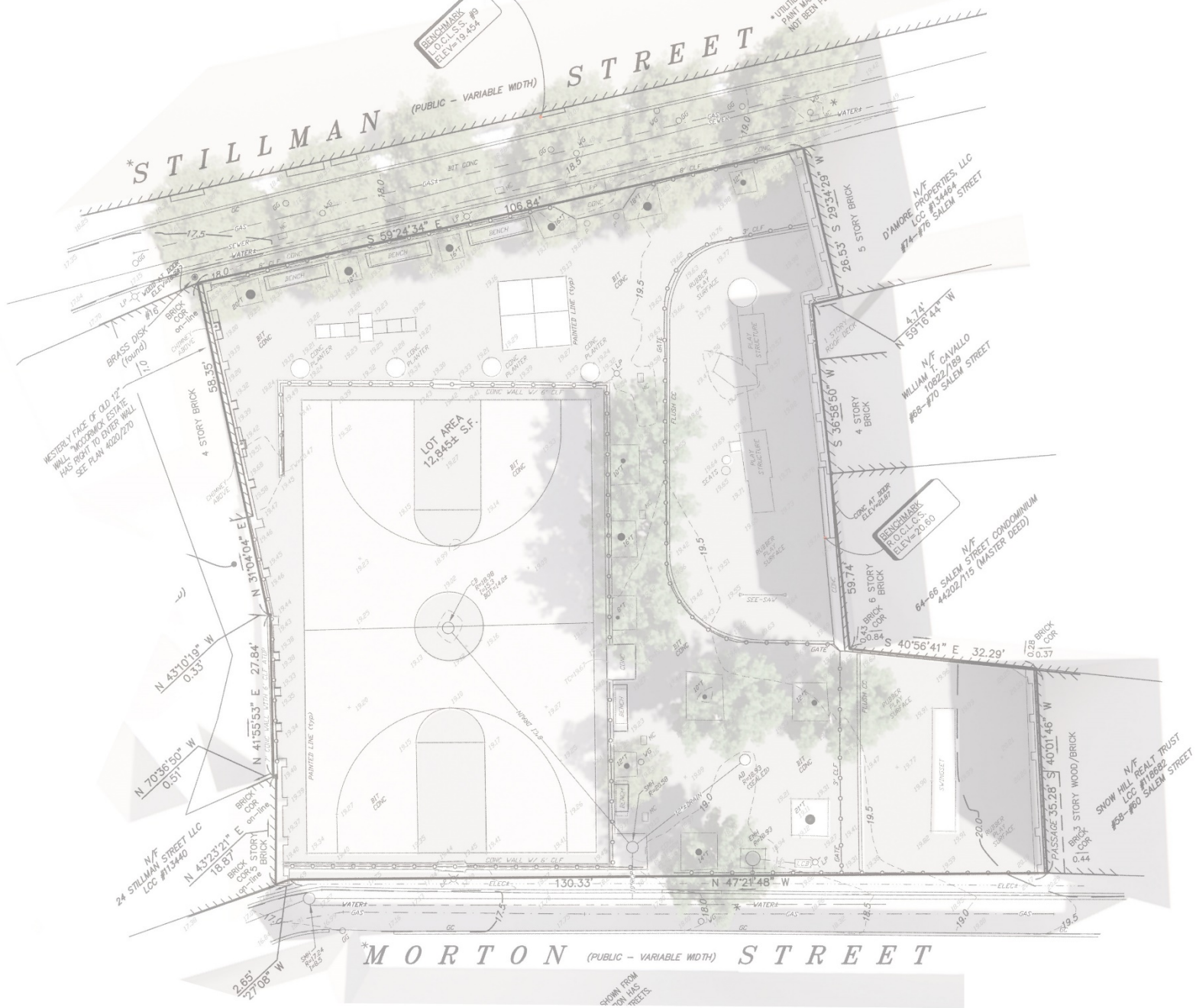

save existing trees

shift court off both streets to create entry areas
court location saves existing trees

establish tree zones ensures success of trees

save existing trees

establish tree zones ensures success of trees

remove ginkgo tree produces strongsmelling fruit



CREATING A FRAMEWORK FOR PARK LAYOUT

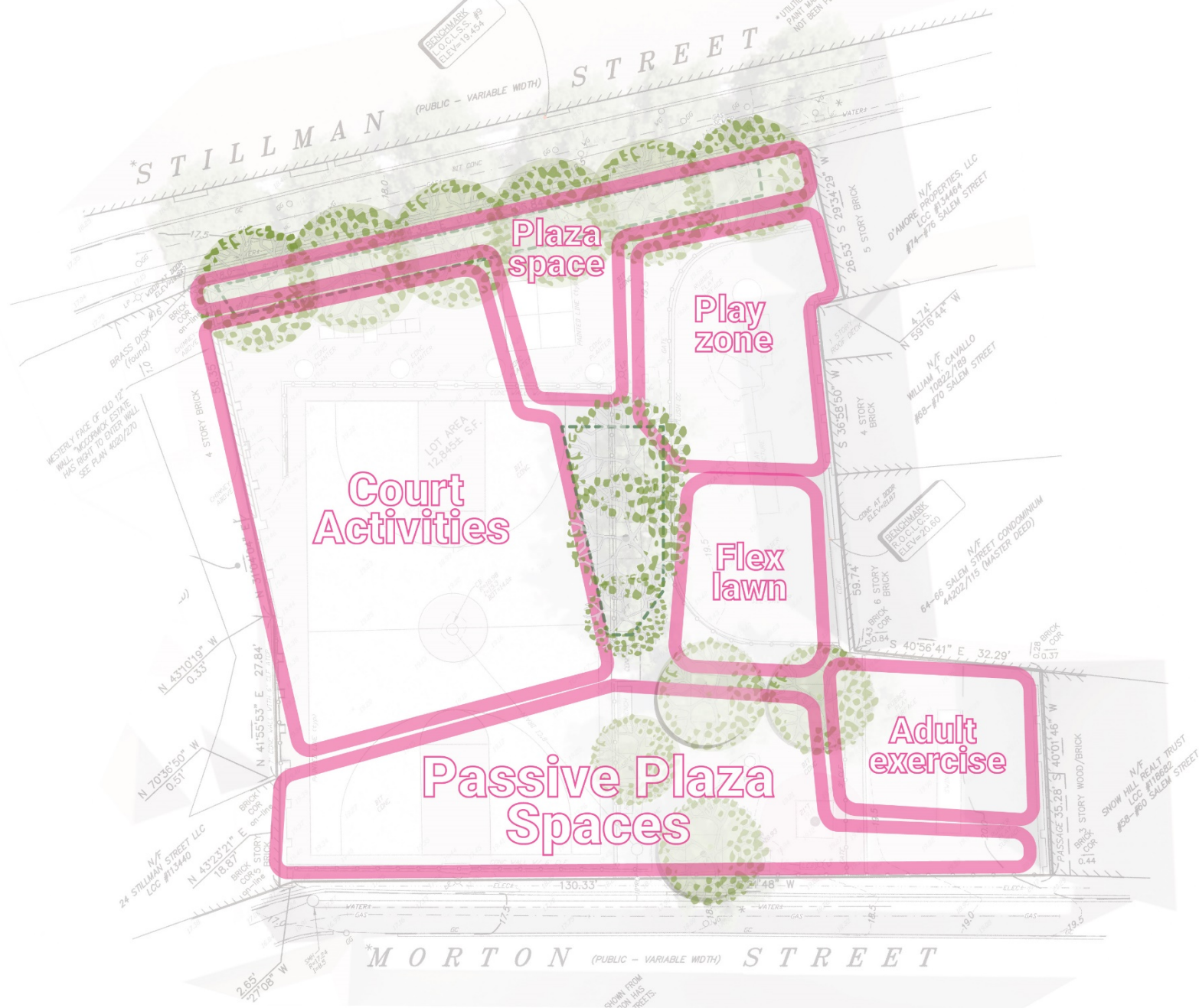

CREATING A FRAMEWORK FOR PARK LAYOUT



< EXAMPLES OF PREFERRED COURT GRAPHICS

1

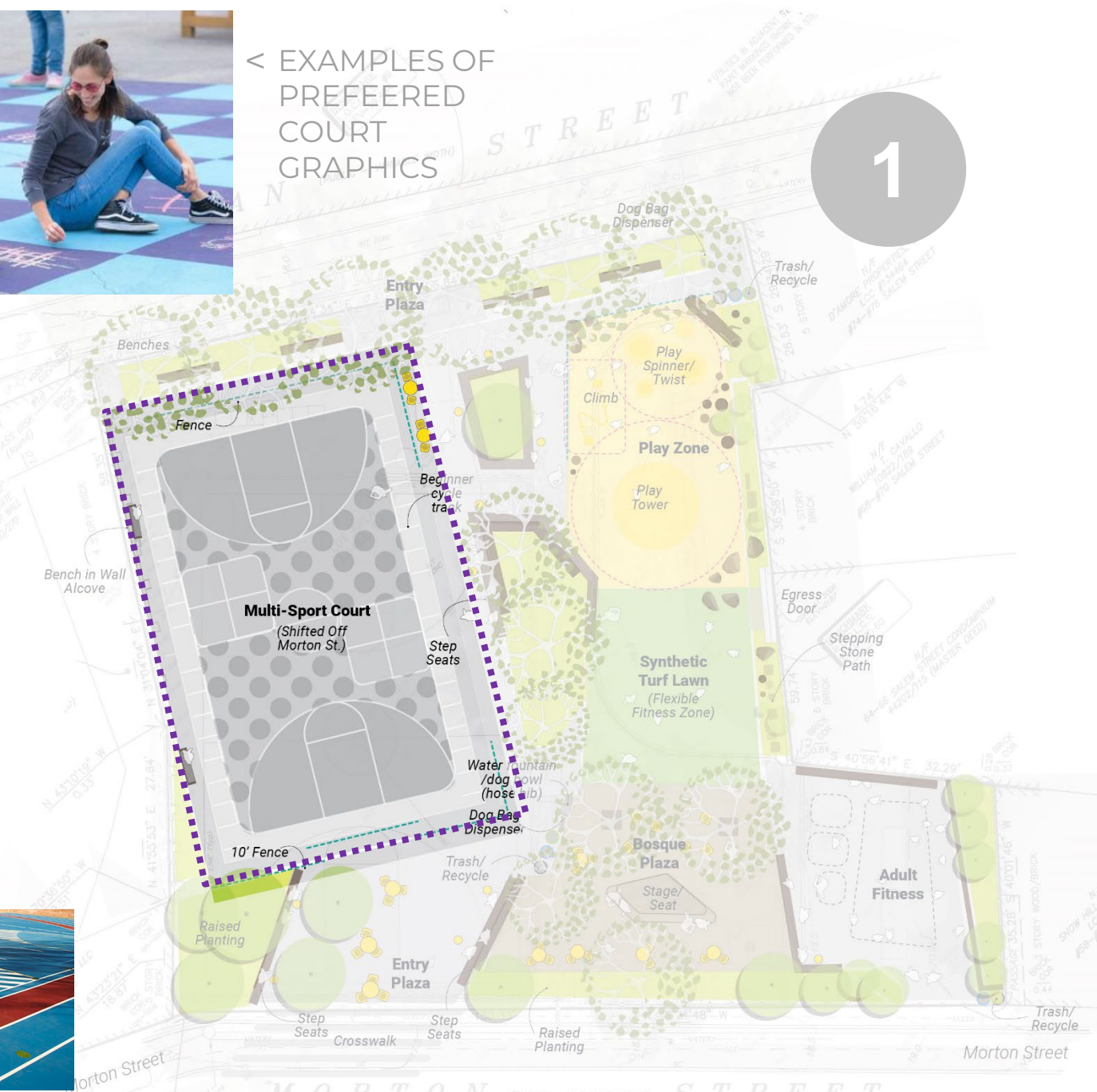
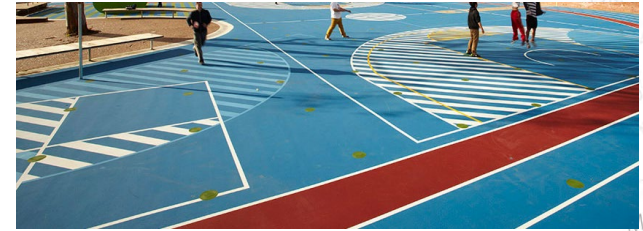

CONCEPT 1: FULL COURT (MULTI-USE COURT)

< EXAMPLES OF PLAY ELEMENTS

CONCEPT

1



*Play equipment shown for reference only, safety surface will be rubber

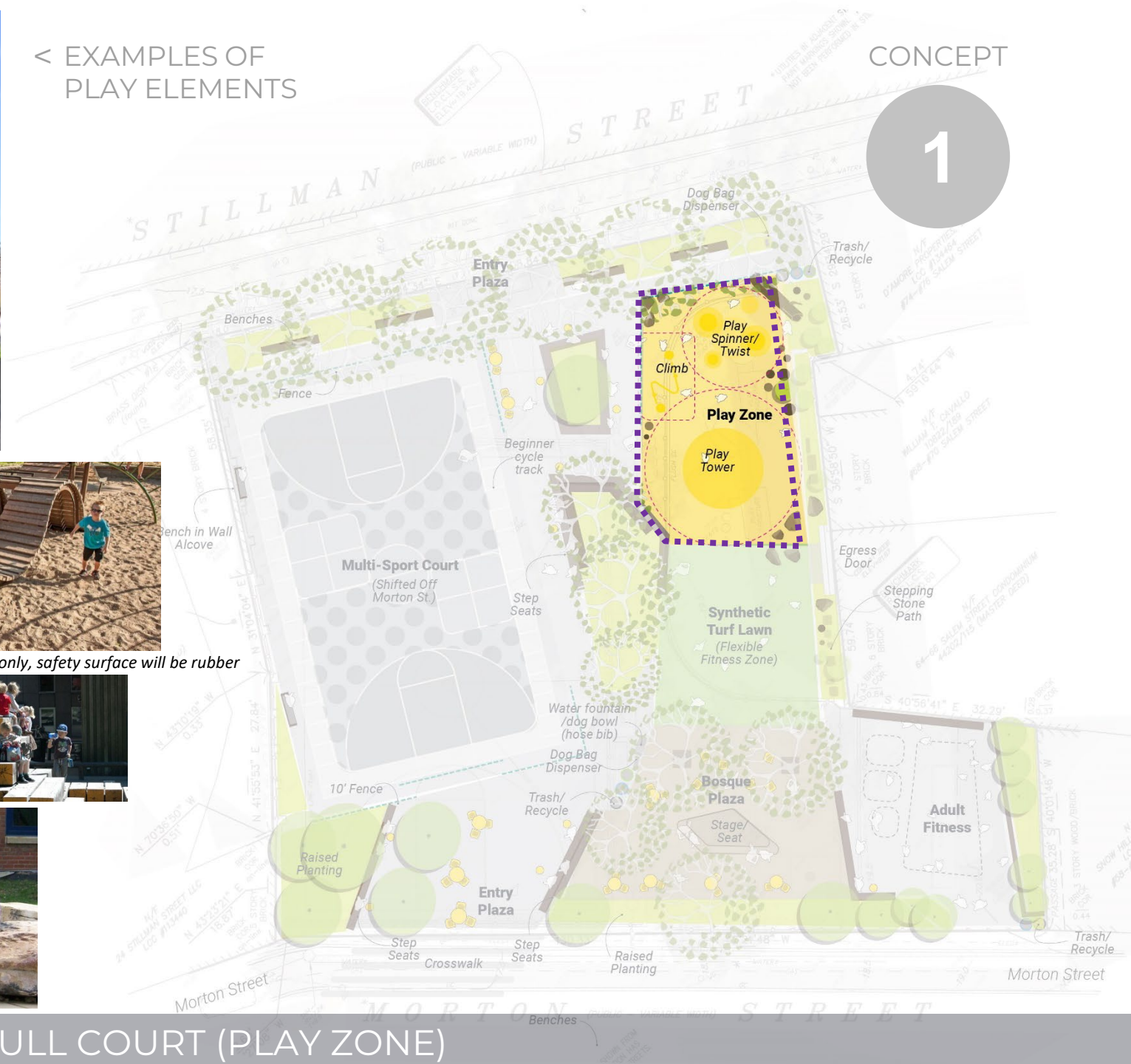

CONCEPT 1: FULL COURT (PLAY ZONE)

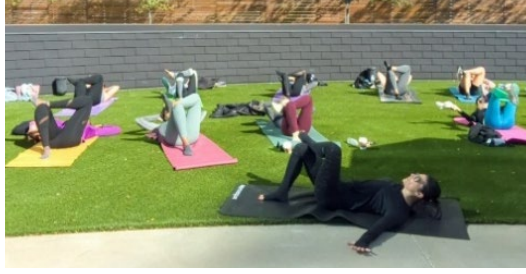

< EXAMPLES OF SYNTHETIC TURF SURFACING

1



CONCEPT 1: FULL COURT (SYNTHETIC TURF)



MATERIAL COMPARISON: PLAY SAFETY SURFACING (RUBBER VS. TURF)

< EXAMPLES OF
PREFERRED
PLAZA
ELEMENTS

1

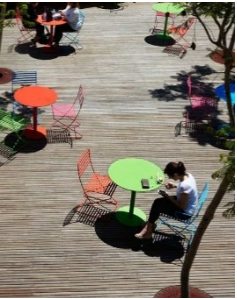

CONCEPT 1: FULL COURT (PLAZAS AND PASSIVE SPACE)



< Preferred All-in-One Unit



CONCEPT 1: FULL COURT (ADULT FITNESS)



FULL COURT

1



HALF COURT

2



FULL COURT

1



- Full court accommodates (2) games/groups of players
- More robust for games (adult and teen fitness)
- Provides open area for bikes/trikes for younger kids

HALF COURT

2



- Expands play area which accommodates more equipment and/or play opportunities for kids 0-12
- Plazas, play and basketball feel more open

- 4' FENCING
- 10' BALL FENCING

1

FULL COURT



2

HALF COURT



-Basketball fencing on park side can be reduced to 4' ht.



MATERIAL COMPARISON: FENCING (WELDED WIRE VS. CHAIN LINK)

FULL COURT

1



HALF COURT

2



- No room for dish swing
- Play remains less of visual focal piece/program element

- Expanded play zones make play a priority
- Older and younger play have more distinct zones
- Dish Swing area included, play tower in plaza



PLAY EQUIPMENT EXAMPLES – TOWER - VERTICAL VS. SCULPTURE



**Play equipment shown for reference only, safety surface will be rubber*





PLAY EQUIPMENT EXAMPLES – FREE PLAY/NATURE PLAY



PLAY EQUIPMENT EXAMPLES – DISH SWING

FULL COURT

1

HALF COURT

2



CONCEPT COMPARISON: SYNTHETIC TURF LAWN AREA

FULL COURT

1



HALF COURT

2



CONCEPT COMPARISON: ADULT FITNESS AREA

FULL COURT

1



HALF COURT

2



- Both concepts have similar plaza/passive zones. Both accommodate approximately 60+ people comfortably with varying seating options for multiple activities
- Seating includes flat benches, seat walls, backed benches/seats with armrests, café tables/chairs, single chair/benches, and platform seats

CONCEPT COMPARISON: PLAZA/PASSIVE ZONES

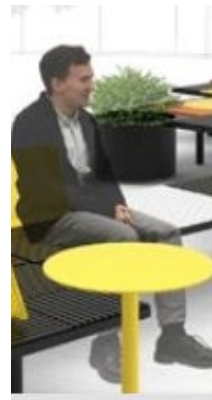
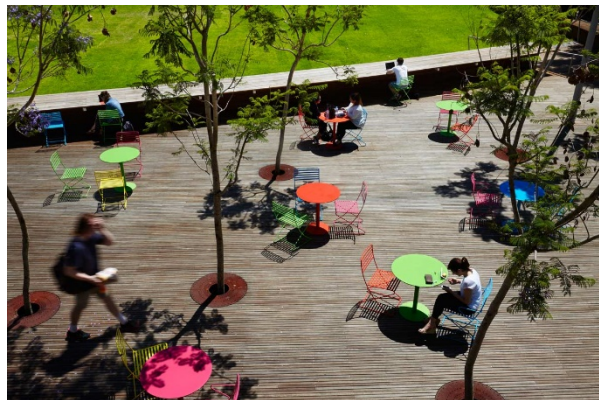
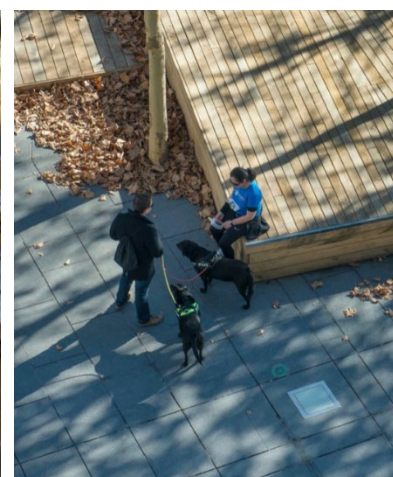
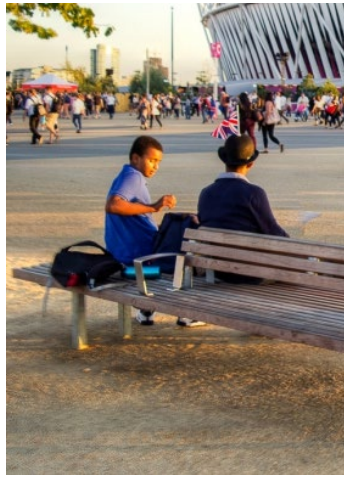

SITE FURNISHINGS: VARIED SEATING OPTIONS FOR ALL

FULL COURT

1



HALF COURT

2



DO YOU PREFER THE FULL-SIZE COURT OR THE HALF COURT? LET'S TAKE A 30 SEC. BREAK TO RESPOND

NEXT STEPS...

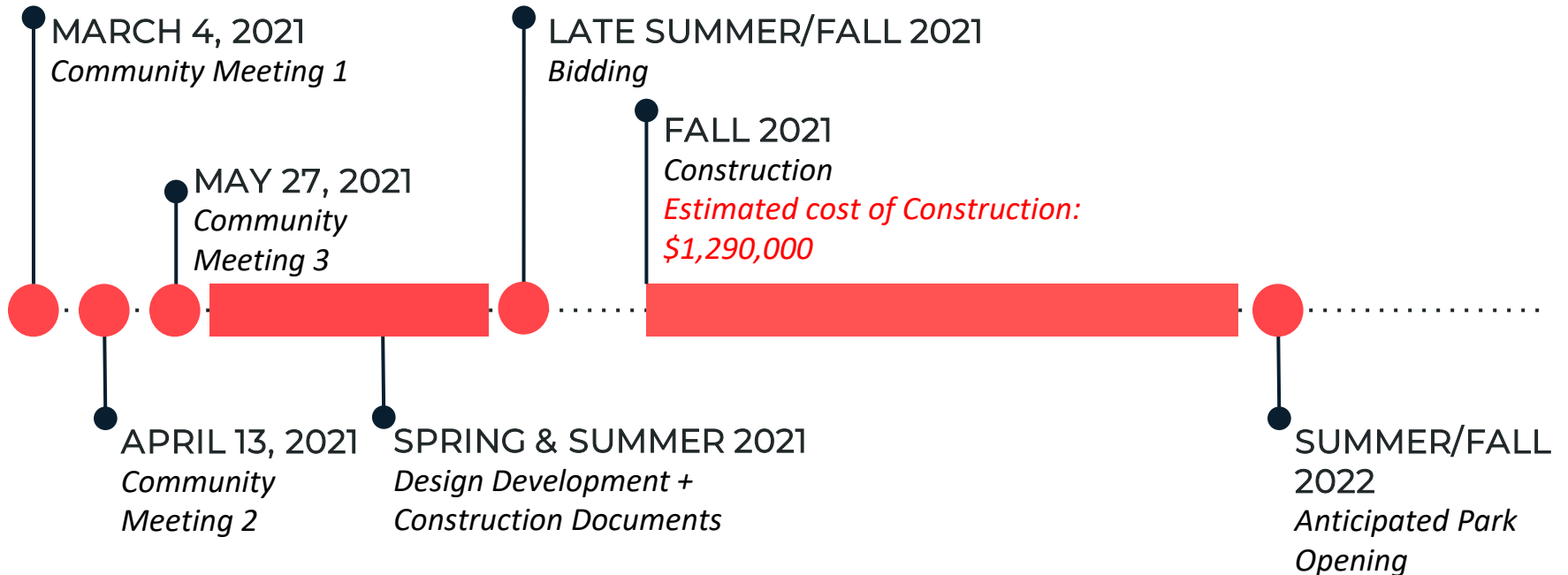

**Dates subject to change*

THANK YOU!

Cuttillo Park Website: <https://www.boston.gov/departments/parks-and-recreation/improvements-cuttillo-park>

For questions, maintenance requests or concerns regarding any of our parks contact 311

