

Improvements to Millennium Park Community Meeting #3



May 13, 2021
Boston Parks and Recreation Department



MEETING RECORDING

The Boston Parks and Recreation Department will be recording the meeting and posting to our project webpage for those who are unable to attend the Zoom Webinar live.

Please share with your neighbors and friends!

boston.gov/millennium-park



ZOOM TIPS

Here is how you can participate during the question and answer part of the presentation.

DURING THE PRESENTATION:



VIA WEB:

Turn video on / off.

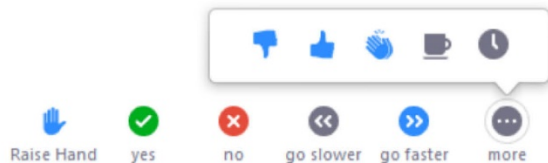

To use these non-verbal options click on participants (bottom of screen); these options will pop up in side bar.

DURING THE Q&A:



JOINING VIA PHONE?

Use *9 to raise hand to ask for audio / video permission to ask questions or provide comments.



VIA WEB:

Chat to ask questions / comments or provide responses to poll questions



Raise hand to ask for audio / video permission to ask questions or provide comments.

May 13, 2021

Boston Parks and Recreation Department



VIRTUAL MEETING ETIQUETTE

We want to ensure this conversation is a pleasant experience for all and that all community members/ stakeholders are comfortable sharing their comments, questions and feedback.

Please be respectful and mindful of each other's time when asking questions/ providing comments, so that all attendees are able to participate in the meeting.

Keep questions/ comments project-specific and not personal to yield solution-driven discussion.

Please wait until all attendees have had the opportunity to ask a question/ provide a comment before providing additional questions/ comments.

You can always set up a conversation with **Allison Perlman**, **Allison.Perlman@boston.gov** to further discuss the project or process.



AGENDA

WELCOME – ALLISON PERLMAN PROJECT MANAGER, BOSTON PARKS AND RECREATION DEPARTMENT

1

PROJECT TEAM INTRODUCTIONS

2

PROJECT OVERVIEW

3

COMMUNITY MEETING #2 WHAT WE HEARD

PROJECT PRESENTATION – CDM SMITH

1

FINAL PLAYGROUND CONCEPT

2

COMMUNITY INPUT LISTENING & DISCUSSION

3

NEXT STEPS



PROJECT TEAM

CDM SMITH

ROBERT BUTTON

CLIENT SERVICE LEADER/ENGINEER
buttonro@CDMSmith.com or 617-452-6586

GLENN HOWARD

PROJECT MANAGER/LANDSCAPE ARCHITECT
howardgd@CDMSmith.com or 617-452-6630

JON BRONENKANT

LANDSCAPE DESIGNER
bronenkantjl@CDMSmith.com or 617-452-6191

CITY OF BOSTON

ALLISON PERLMAN

PROJECT MANAGER
allison.perlman@boston.gov or 617-961-3035

CHRISTINE BRANDAO

OUTREACH COORDINATOR, EXTERNAL AFFAIRS
christine.brandao@boston.gov or 617-961-3006

JACK DUGGAN

OFFICE OF NEIGHBORHOOD SERVICES
Jack.duggan@boston.gov





PROJECT SCOPE

- **Review existing conditions and use of the playground, pathways and parking lots**
- **Identify new playground elements reflective of the community**
- **Upgrade playground equipment, safety surfacing and access**
- **Assess feasibility of new restroom building**
- **Replace or repair damaged pathways or parking - on-going process**



PROJECT SCHEDULE

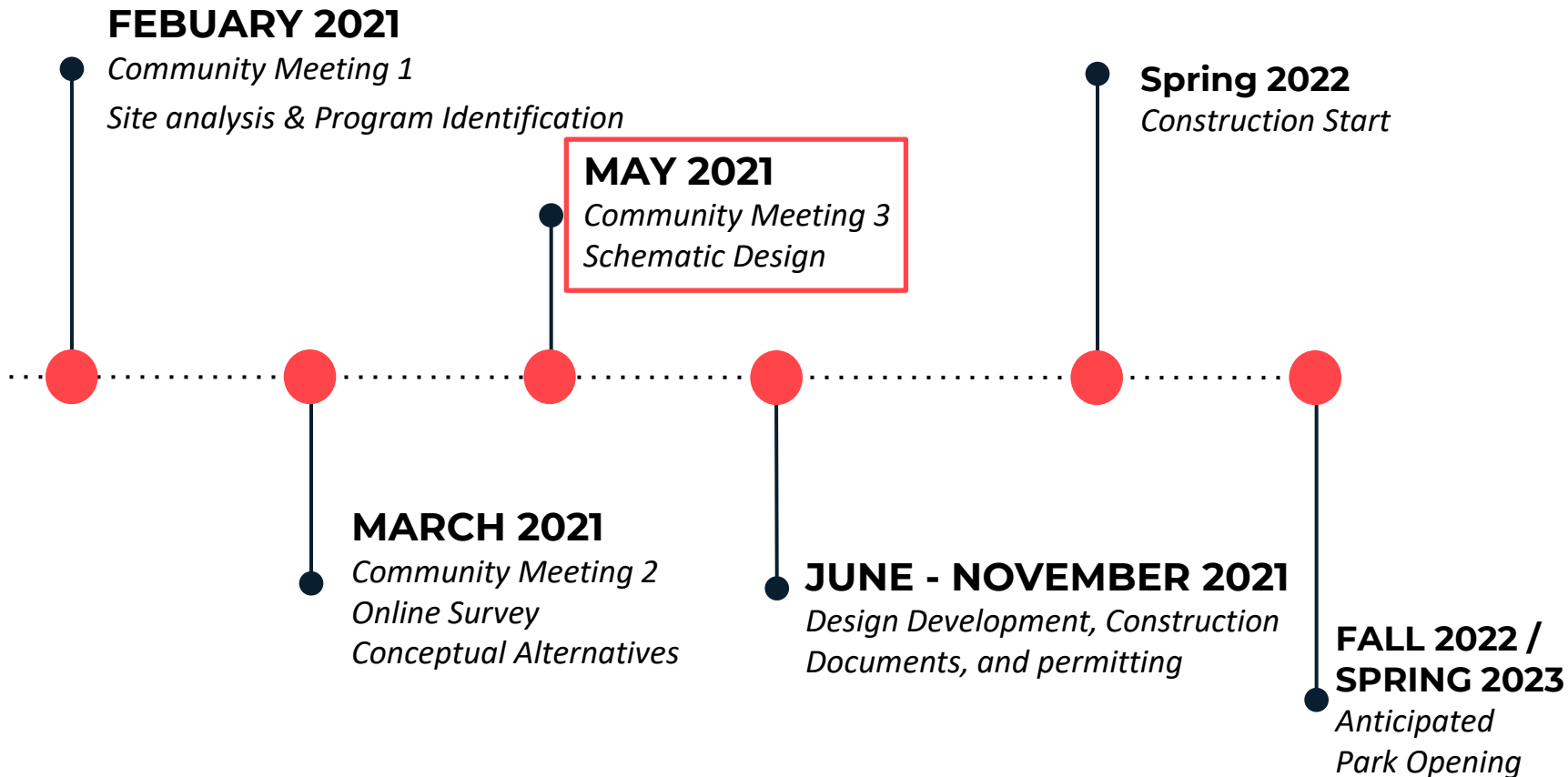

COMMUNITY MEETING #2 CONCEPT PLANS

CONCEPT 1 - THE BIRD HOUSE: A VIEW OF THE CITY

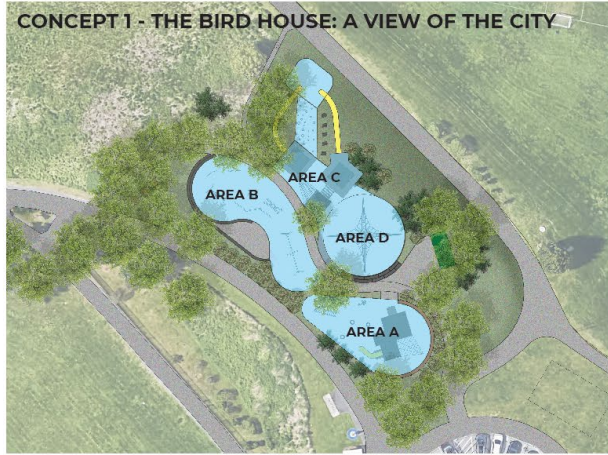

KEY FEATURES -

AREA A - 2-5, PLAY HOUSE WITH CLIMBING AND SLIDES, SMALL CLIMBER AND NESTS

AREA B - SWINGS AND BALANCING/ CLIMBING ELEMENTS

AREA C - 5-12, LARGE STRUCTURE WITH HILL SLIDES

AREA D - 5-12, LARGE CLIMBING STRUCTURE WITH VIEW

CONCEPT 2 - BIRDS AND THEIR HABITAT

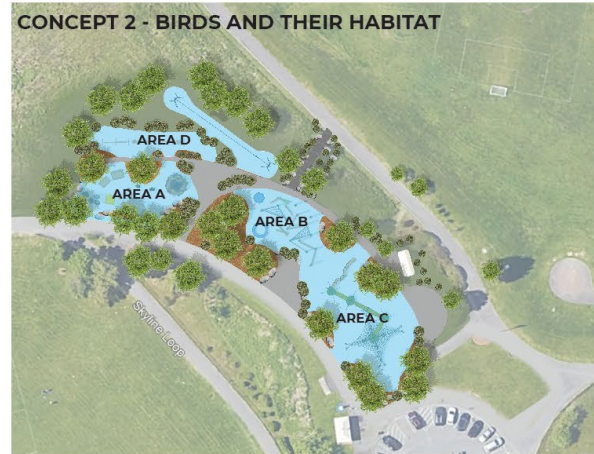

KEY FEATURES -

AREA A - 2-5, PLAY WITH SMALL EMBANKMENT SLIDE, NEST, AND PLAYHOUSE

AREA B - BALANCING AND SPINNING PLAY ELEMENTS

AREA C - 5-12, LARGE CLIMBER ROPE STRUCTURE WITH SLIDE AND BRIDGES

AREA D - SWINGS AND ZIPLINE

CONCEPT 3 - URBAN WILD



KEY FEATURES -

AREA A - 2-5, PLAYHOUSE WITH SLIDE, DISH SWING, BALANCING ELEMENTS AND RIVER CREATURES

AREA B - INCLUSIVE SPINNING ELEMENTS, OBSTACLE CLIMBING ELEMENTS, AND SWINGS

AREA C - 5-12, OVERLOOK TOWER STRUCTURE (ACCESSIBLE FROM BOTH TOP AND BOTTOM) WITH SLIDES AND VIEW

AREA D - SMALL TREE HOUSE PLAY STRUCTURE AND SEESAW



COMMUNITY MEETING #2 WHAT WE HEARD

General Comments

- Swings are a crucial play item, dish swing would be great too
- Include large climbing structures and net systems
- Include accessible playground equipment for all ages
- Bird and nature theme received positive comments
- A combination of natural seating and more formal seating with shading is desired
- Add in more native vegetation to provide shade and wind protection, without obstructing the views
- Include a teen seating area
- Fencing and natural barriers should be used in some instances to help protect and enclose certain play areas



COMMUNITY MEETING #2 WHAT WE HEARD

Comments and preferred elements for the 2-5 year-old play areas:

- Locate the play area further away from the parking lot, consider enclosure
- Include embankment slide with climbing options
- Include creative play – playhouse, wildlife

Comments and preferred elements for the 5-12 year-old play areas:

- Include treehouse play structure
- Large slide
- Skywalk tower with bridge
- Rope climbing net structure; obstacle play
- Accessible
- Slope play was a concern for visibility
- Zipline

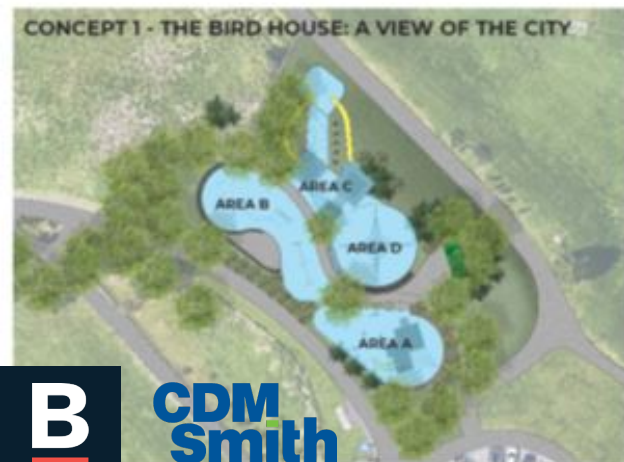

SITE OVERVIEW

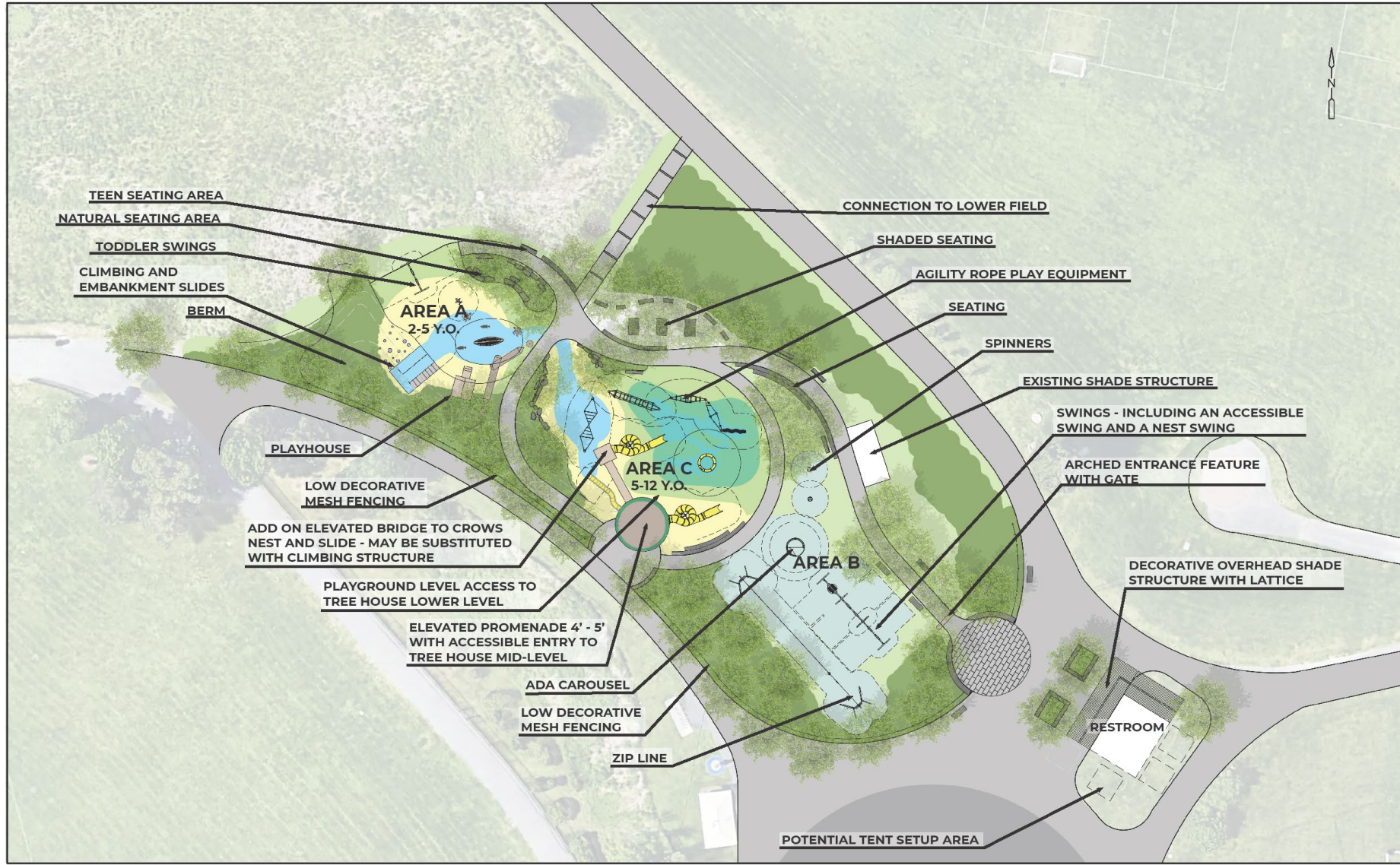

AREA A: 2-5 YEAR OLD PLAY AREA

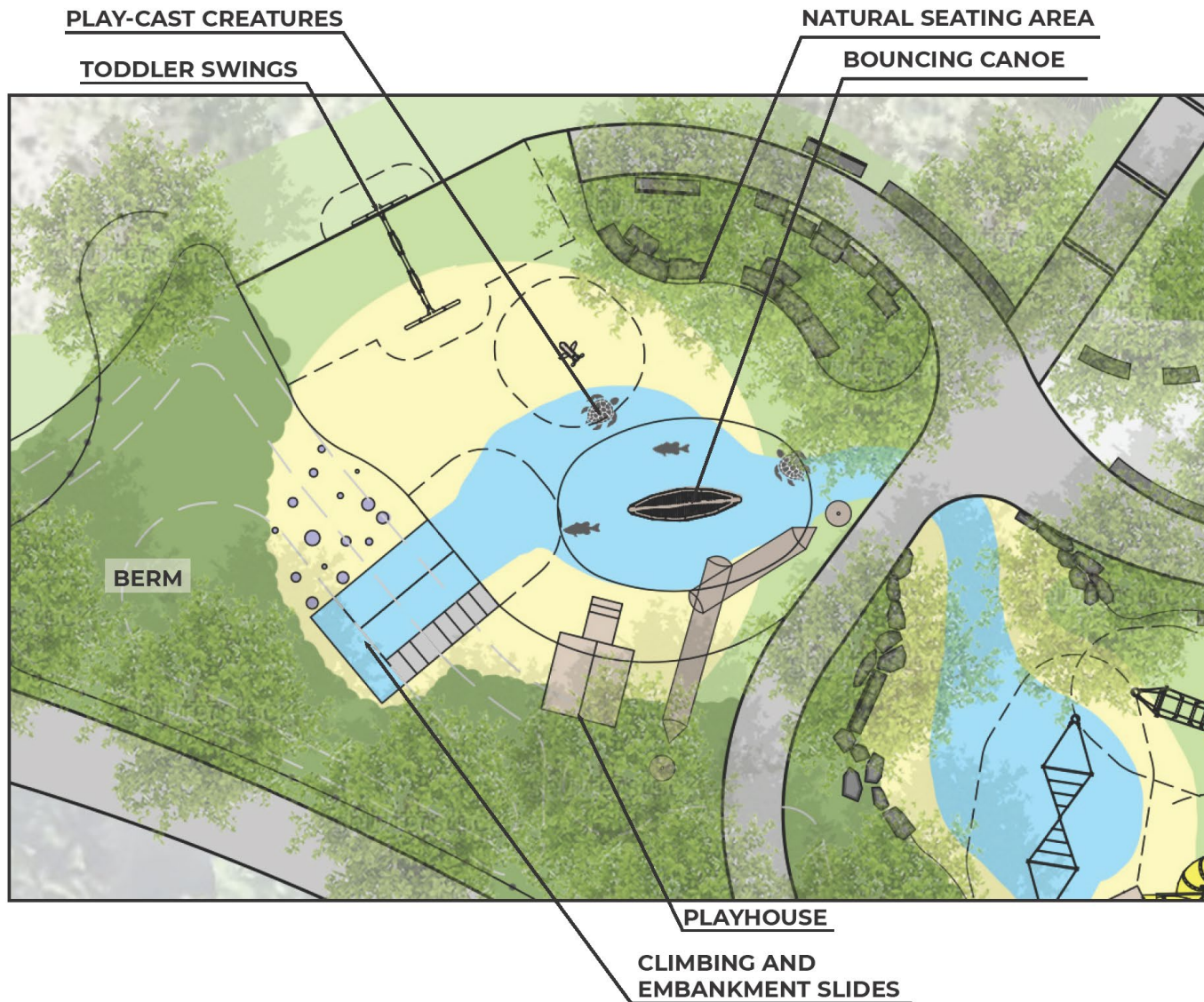

KEY FEATURES

- TODDLER SWING
- DOUBLE EMBANKMENT SLIDE
- CLIMBING HILL
- PLAY-CAST CREATURES HIDDEN THROUGHOUT
- BALANCING LOGS
- BIRD-HOUSE THEMED PLAYHOUSE
- SHADED SEATING



PRECIDENT IMAGES – 2-5 YEAR OLD PLAY AREA



EMBANKMENT SLIDE



PLAYHOUSE



TODDLER SWINGS



BALANCING LOGS



BOUNCING CANOE



AREA B: SWINGS, SPINNERS, AND ZIP LINE

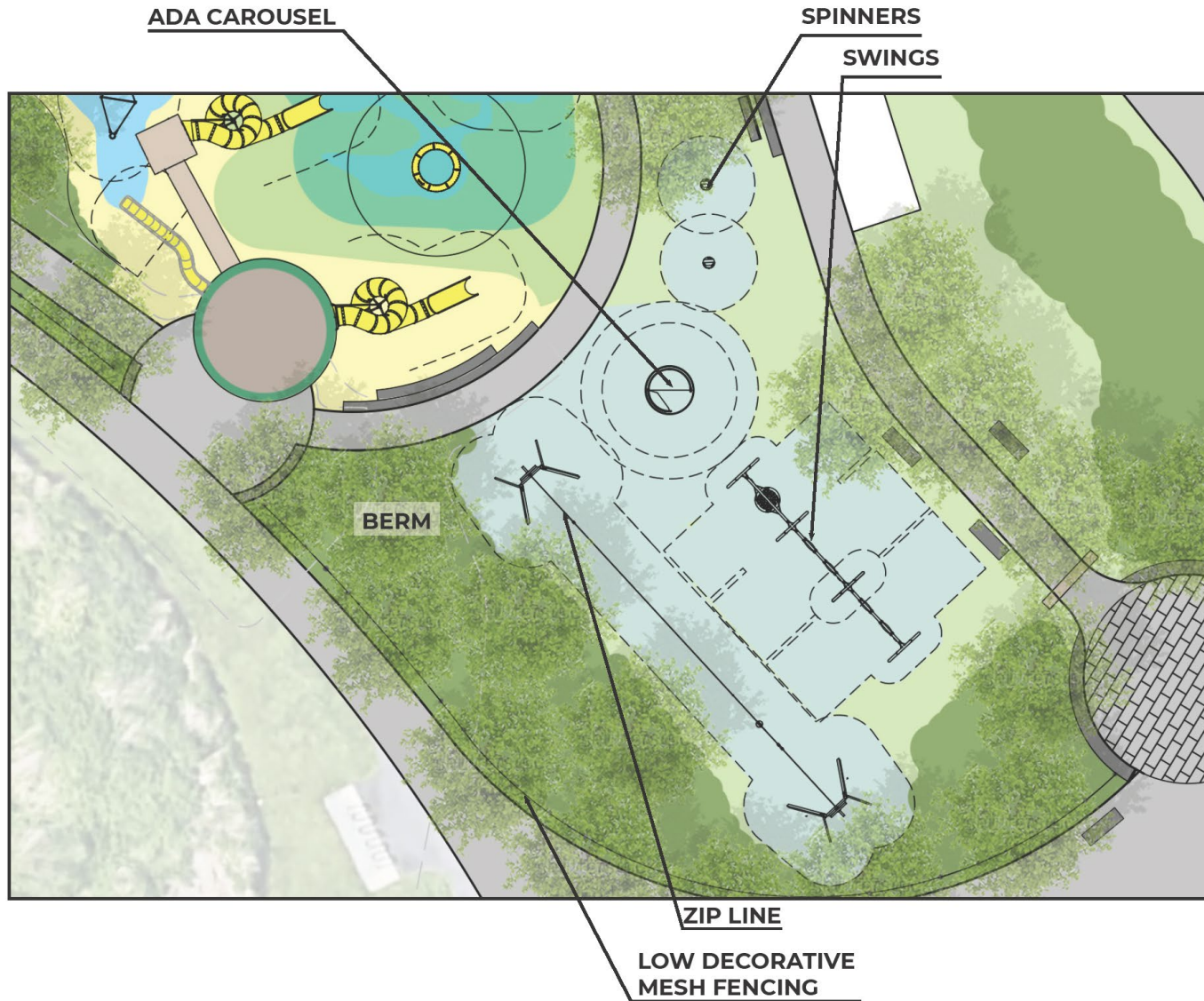

KEY FEATURES

- SPINNERS
- ADA CAROUSEL
- SWINGS
- NEST SWING
- ZIP LINE



PRECIDENT IMAGES – SWINGS AND SPINNERS



AREA C: 5-12 YEAR OLD PLAY AREA

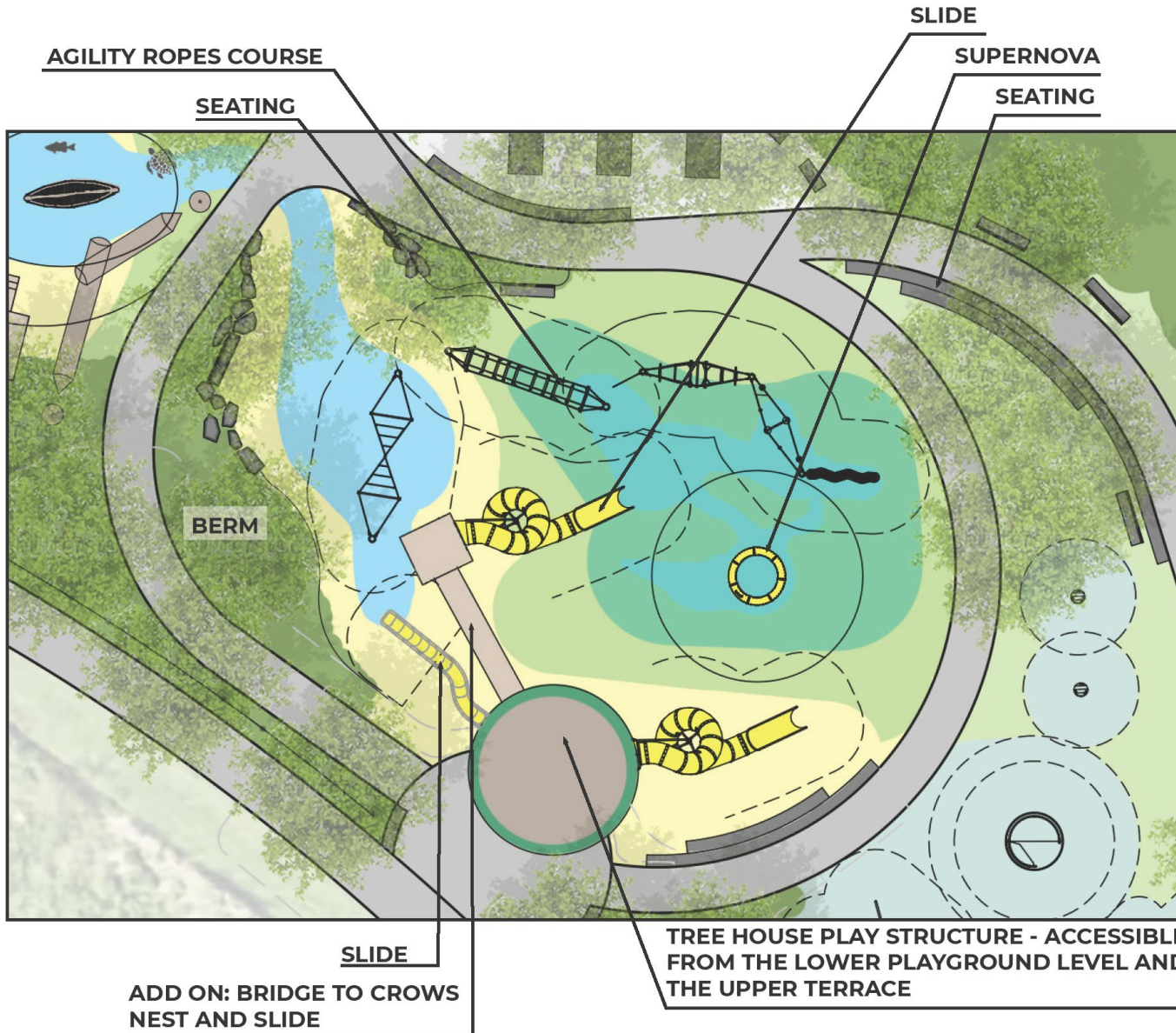

KEY FEATURES

- TREE HOUSE PLAY STRUCTURE
- SUPERNOVA EQUIPMENT
- EMBANKMENT SLIDE
- TALL PLASTIC TUBE SLIDE
- BRIDGE TO CROWS NEST
- ROPE AGILITY COURSES
- SHADED SEATING
- ACCESSIBLE VIEWING DECK FROM UPPER TERRACE



PRECIDENT IMAGES – 5-12 YEAR OLD PLAY AREA



ROPES AGILITY COURSE



SUPERNOVA



ROPES AGILITY COURSE

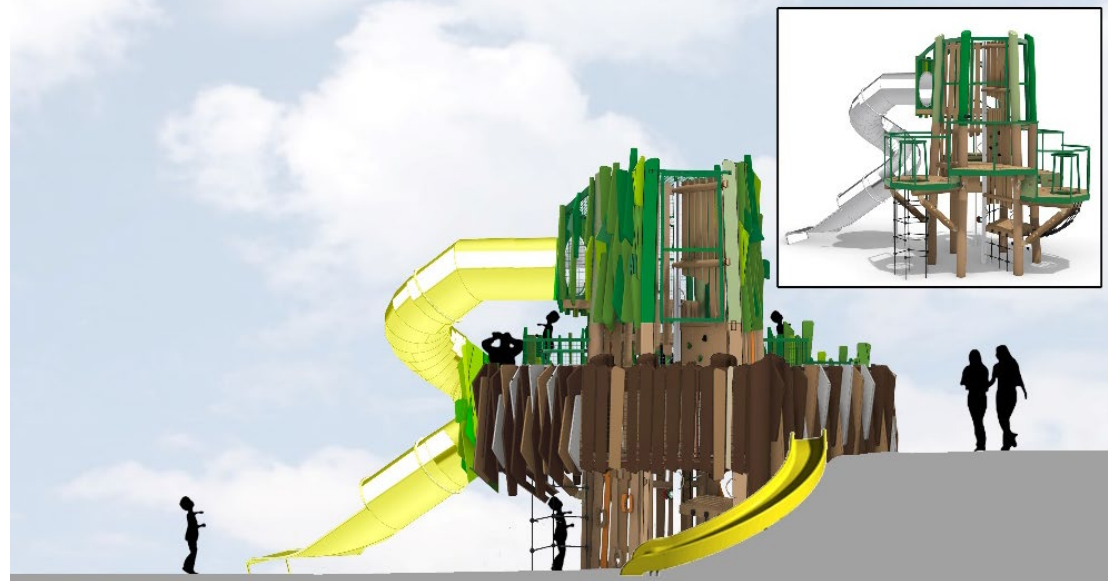

TREE HOUSE PLAY STRUCTURE



PRECIDENT IMAGES – 5-12 YEAR OLD PLAY AREA



ROPES AGILITY COURSE



SUPERNOVA



ROPES AGILITY COURSE

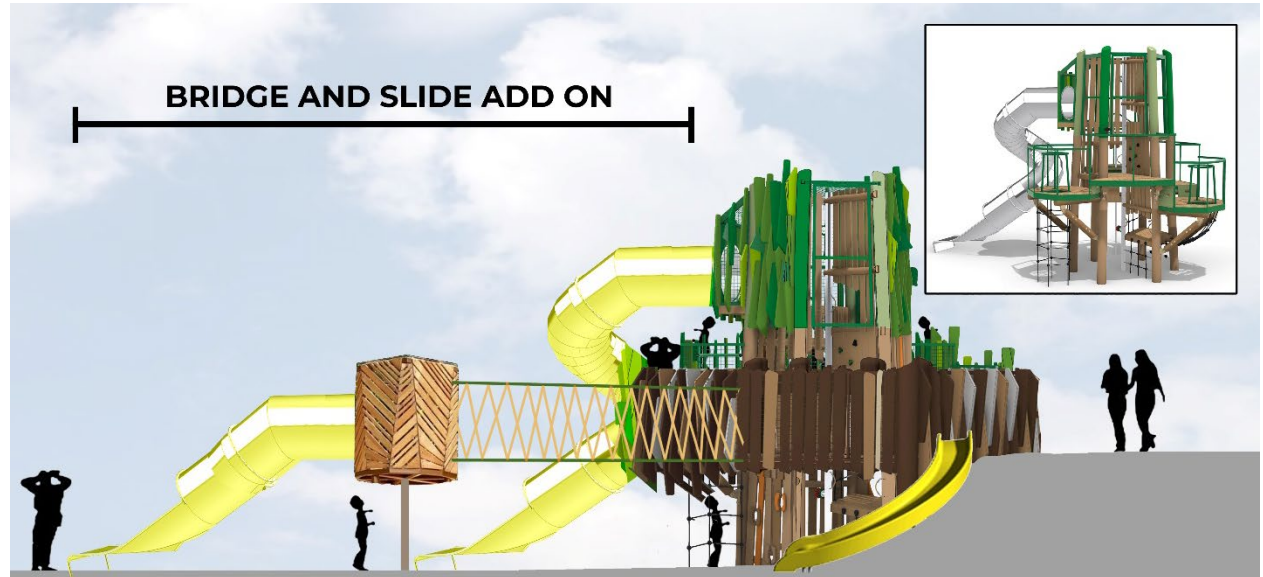

BRIDGE AND SLIDE ADD ON

TREE HOUSE PLAY STRUCTURE WITH ADD ON CROWS NEST



PRECIDENT IMAGES – SITE FEATURES



ENTRANCE SIGN



INTERPRETIVE SIGNAGE



PRECIDENT IMAGES – NATIVE PLANTINGS



RIVER BIRCH



WITCH-HAZEL



DOGWOOD



SWEET PEPPERBUSH



FRAGRANT SUMAC



SHADBLOW SERVICEBERRY



PRECIDENT IMAGES – NATURAL SEATING & VEGETATED BARRIERS



NATURAL SEATING AND VEGETATION BUFFER



NATURAL SEATING



NATURAL SEATING

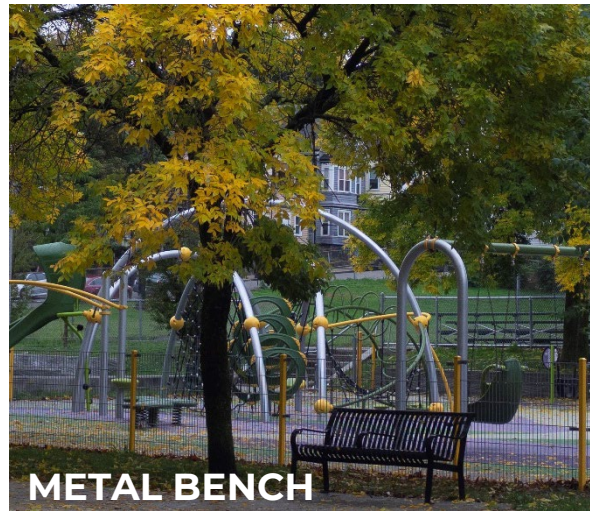

METAL BENCH



RECYCLED BENCH

PRECEDENT IMAGES – TYPES OF FENCING



FENCING INCORPORATED INTO THE BERM

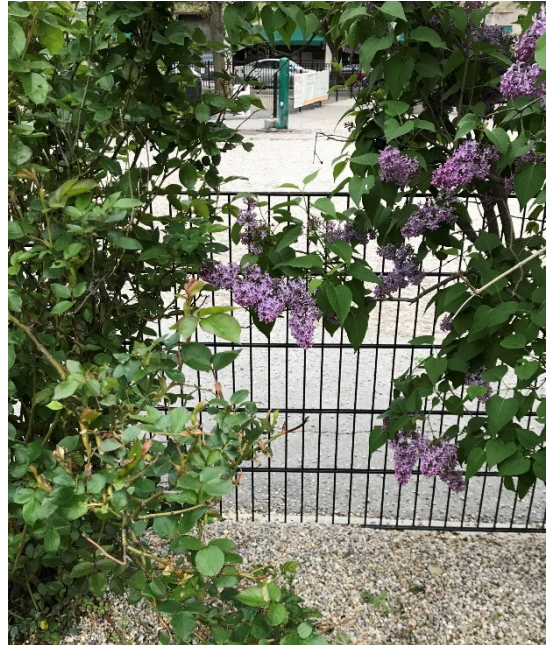

LOW MESH FENCE

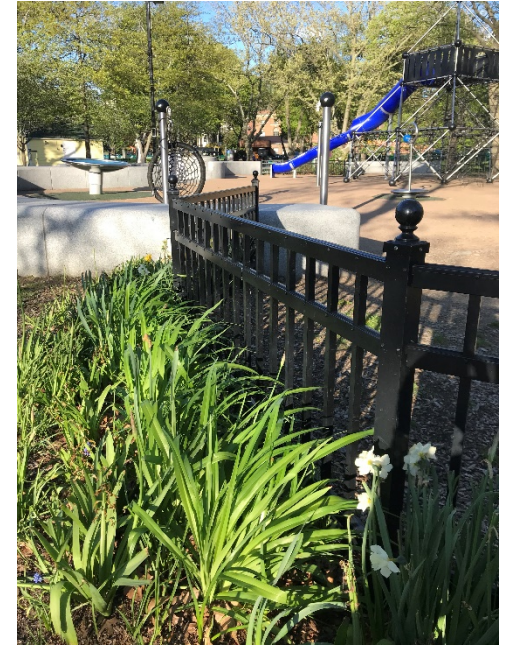

FENCEING WITH PLANTINGS

LISTENING & DISCUSSION

Help us build great parks.
Let us know what matters to you.



ZOOM TIPS

Here is how you can participate during the question and answer part of the presentation.

DURING THE PRESENTATION:



VIA WEB:

Turn video on / off.

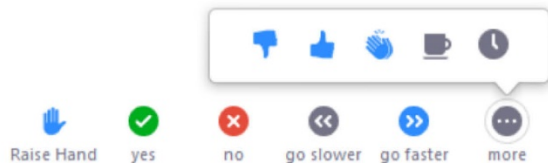

To use these non-verbal options click on participants (bottom of screen); these options will pop up in side bar.

DURING THE Q&A:



JOINING VIA PHONE?

Use *9 to raise hand to ask for audio / video permission to ask questions or provide comments.



VIA WEB:

Chat to ask questions / comments or provide responses to poll questions



Raise hand to ask for audio / video permission to ask questions or provide comments.

May 13, 2021

Boston Parks and Recreation Department



NEXT STEPS

- Design Development and Construction Documents
- Restroom Feasibility report, DEP permitting
- Bidding
- Construction

boston.gov/millennium-park





THANK YOU!

For questions, maintenance requests or concerns regarding any of our parks contact 311

BOS:
311



**CDM
Smith**

May 13, 2021
Boston Parks and Recreation Department

