

# 566 COLUMBUS AVE., BOSTON SOUTH END LANDMARK DISTRICT COMMISSION HEARING

JUNE 4, 2019











THE BOULEVARD



THE SALEM JAIL



LAWRENCE COURT



THE MODERN



THE ALLEN HOUSE

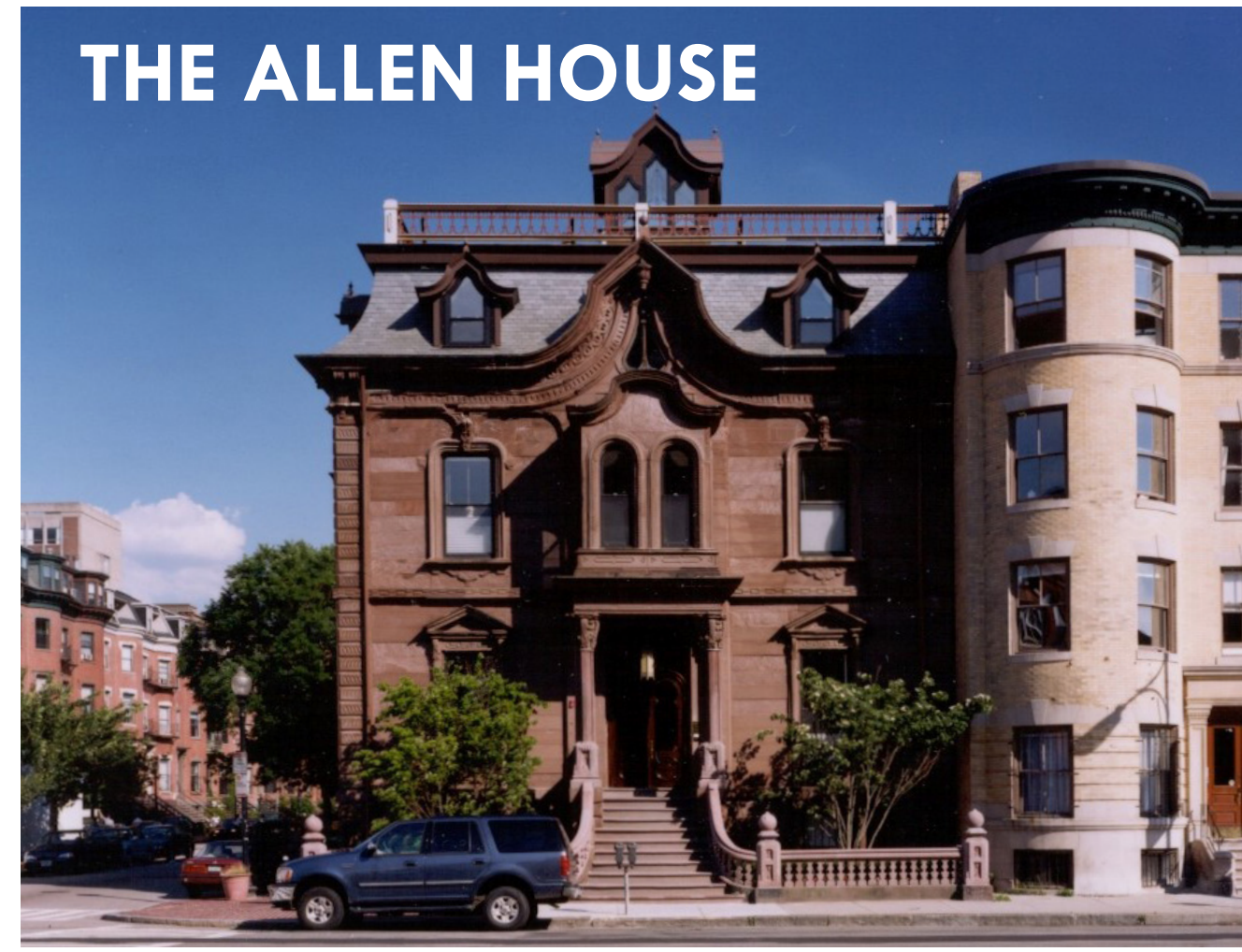

THE LUCAS



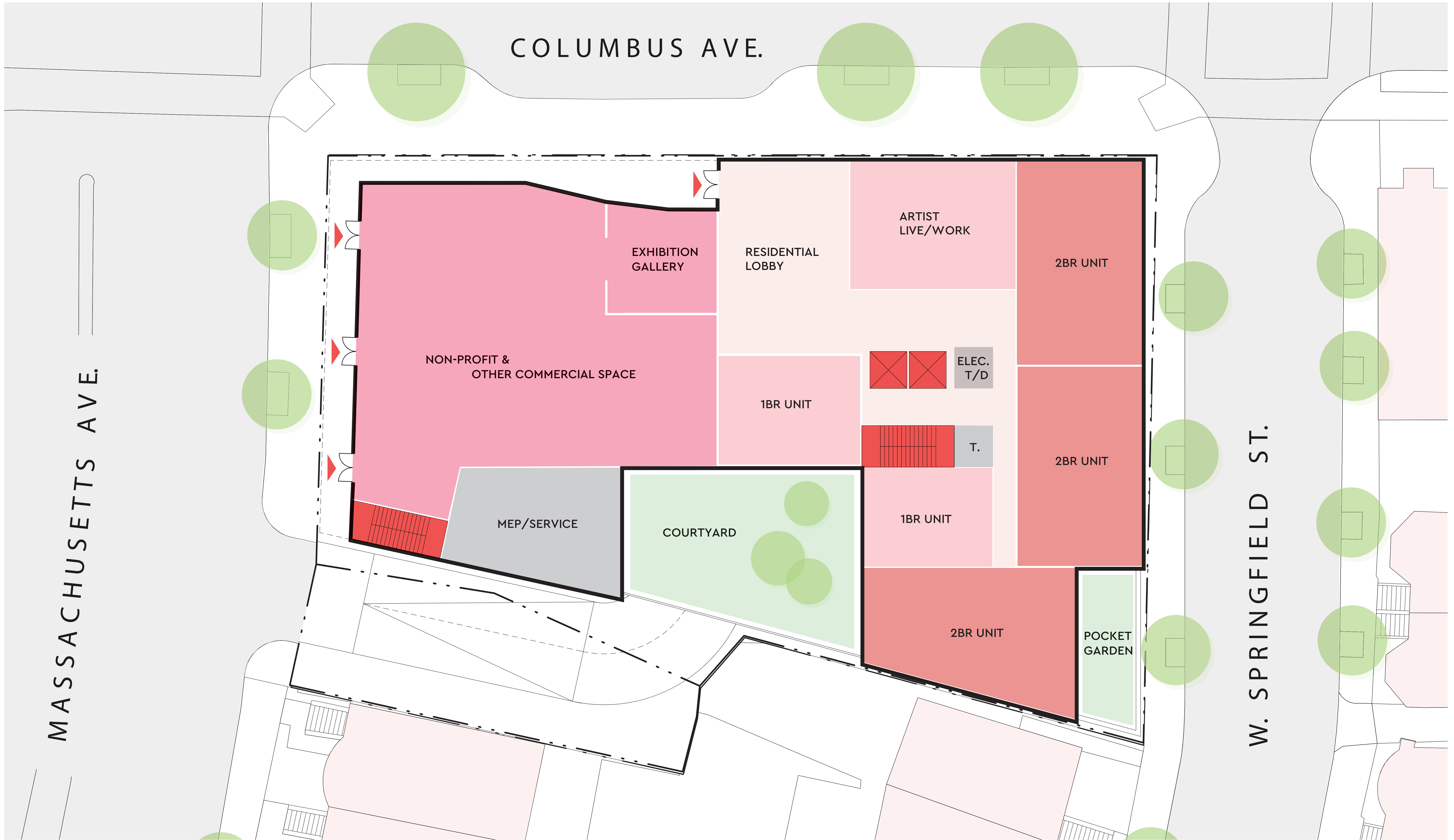









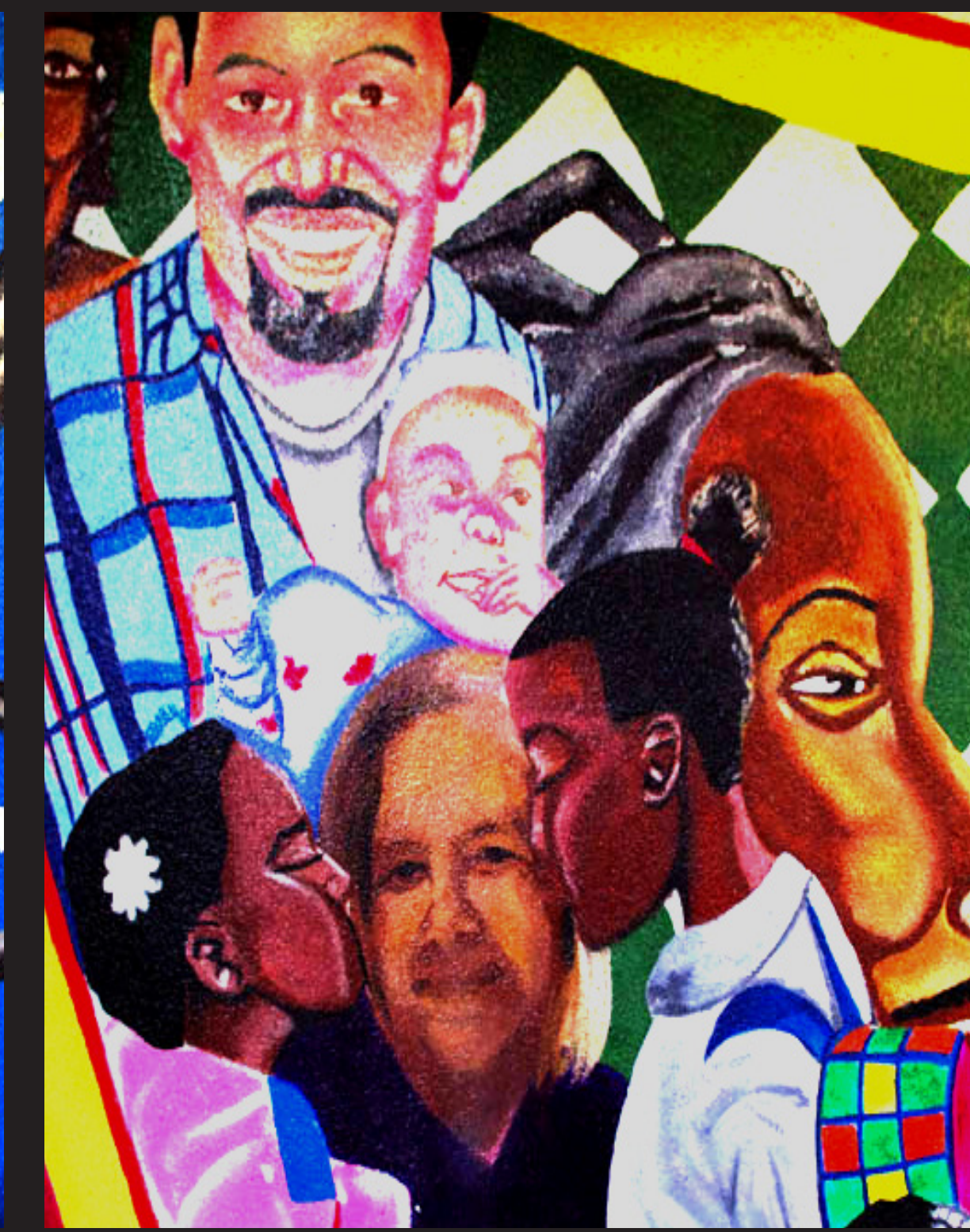

## OUR COMMITMENT TO HONORING THE MURAL

- **RETAIN A FINE ART CONSERVATION CONSULTANT TO WORK IN COLLABORATION WITH THE PROJECT DEVELOPMENT TEAM**
- **COLLABORATE WITH THE LATE ARTIST'S WIFE & FORM A MURAL ADVISORY GROUP**