

Department of Conservation and Recreation

**Notice of Intent for the Operations and Maintenance Plan for
Savin Hill & Malibu Beach**

**Bureau of Resource Protection
251 Causeway Street, Suite 700
Boston, MA 02114**

April 17, 2019





WPA Form 3 – Notice of Intent

Massachusetts Wetlands Protection Act M.G.L. c. 131, §40

Provided by MassDEP:
MassDEP File Number
Document Transaction Number
Boston (Dorchester)
City/Town

Important:
When filling out forms on the computer, use only the tab key to move your cursor - do not use the return key.

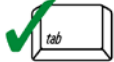

Note:
Before completing this form consult your local Conservation Commission regarding any municipal bylaw or ordinance.

A. General Information

1. Project Location (**Note:** electronic filers will click on button to locate project site):

<u>Savin Hill and Mailbu Beach</u> a. Street Address	<u>Boston</u> b. City/Town	<u>02122</u> c. Zip Code
<u>Latitude and Longitude:</u>	<u>42 18" 50"</u> d. Latitude	<u>71 02" 46"</u> e. Longitude
<u>f. Assessors Map/Plat Number</u>	<u>1302238001/1302238002</u> g. Parcel /Lot Number	

2. Applicant:

<u>Andy</u> a. First Name	<u>Backman</u> b. Last Name	
<u>Massachusetts Department of Conservation and Recreation (DCR)</u> c. Organization		
<u>251 Causeway Street, Suite 600</u> d. Street Address		
<u>Boston</u> e. City/Town	<u>MA</u> f. State	<u>02114</u> g. Zip Code
<u>617-626-1342</u> h. Phone Number	<u>andy.backman@mass.gov</u> j. Email Address	<u>i. Fax Number</u>

3. Property owner (required if different from applicant): Check if more than one owner

<u>Nicholas</u> a. First Name	<u>Gove</u> b. Last Name	
<u>Massachusetts DCR, Deputy Commissioner of Recreation and Operations</u> c. Organization		
<u>251 Causeway Street, Suite 600</u> d. Street Address		
<u>Boston</u> e. City/Town	<u>MA</u> f. State	<u>02114</u> g. Zip Code
<u>617-626-1250</u> h. Phone Number	<u>j. Email address</u>	<u>i. Fax Number</u>

4. Representative (if any):

<u>a. First Name</u>	<u>b. Last Name</u>	
<u>c. Company</u>		
<u>d. Street Address</u>		
<u>e. City/Town</u>	<u>f. State</u>	<u>g. Zip Code</u>
<u>h. Phone Number</u>	<u>j. Email address</u>	<u>i. Fax Number</u>

5. Total WPA Fee Paid (from NOI Wetland Fee Transmittal Form):

<u>\$125.00</u> a. Total Fee Paid	<u>\$50.00</u> b. State Fee Paid	<u>\$75.00</u> c. City/Town Fee Paid
--------------------------------------	-------------------------------------	---



WPA Form 3 – Notice of Intent

Massachusetts Wetlands Protection Act M.G.L. c. 131, §40

Provided by MassDEP:
MassDEP File Number
Document Transaction Number
Boston (Dorchester)
City/Town

A. General Information (continued)

6. General Project Description:

Operations & Maintenance Plan for normal daily activities on Savin Hill Cove and Malibu Beach in Dorchester.

7a. Project Type Checklist:

- 1. Single Family Home
- 2. Residential Subdivision
- 3. Limited Project Driveway Crossing
- 4. Commercial/Industrial
- 5. Dock/Pier
- 6. Utilities
- 7. Coastal Engineering Structure
- 8. Agriculture (e.g., cranberries, forestry)
- 9. Transportation
- 10. Other

7b. Is any portion of the proposed activity eligible to be treated as a limited project subject to 310 CMR 10.24 (coastal) or 310 CMR 10.53 (inland)?

1. Yes No If yes, describe which limited project applies to this project:

2. Limited Project

8. Property recorded at the Registry of Deeds for:

Suffolk

a. County

7624

c. Book

b. Certificate # (if registered land)

579

d. Page Number

B. Buffer Zone & Resource Area Impacts (temporary & permanent)

- 1. Buffer Zone Only – Check if the project is located only in the Buffer Zone of a Bordering Vegetated Wetland, Inland Bank, or Coastal Resource Area.
- 2. Inland Resource Areas (see 310 CMR 10.54-10.58; if not applicable, go to Section B.3, Coastal Resource Areas).

Check all that apply below. Attach narrative and any supporting documentation describing how the project will meet all performance standards for each of the resource areas altered, including standards requiring consideration of alternative project design or location.

For all projects affecting other Resource Areas, please attach a narrative explaining how the resource area was delineated.

Resource Area	Size of Proposed Alteration	Proposed Replacement (if any)
a. <input type="checkbox"/> Bank	1. linear feet	2. linear feet
b. <input type="checkbox"/> Bordering Vegetated Wetland	1. square feet	2. square feet
c. <input type="checkbox"/> Land Under Waterbodies and Waterways	1. square feet 3. cubic yards dredged	2. square feet



WPA Form 3 - Notice of Intent

Massachusetts Wetlands Protection Act M.G.L. c. 131, §40

Provided by MassDEP:
MassDEP File Number
Document Transaction Number
Boston (Dorchester)
City/Town

B. Buffer Zone & Resource Area Impacts (temporary & permanent) (cont'd)

Resource Area, Size of Proposed Alteration, Proposed Replacement (if any)
d. [] Bordering Land Subject to Flooding
e. [] Isolated Land Subject to Flooding
f. [] Riverfront Area
2. Width of Riverfront Area (check one):
[] 25 ft. - Designated Densely Developed Areas only
[] 100 ft. - New agricultural projects only
[] 200 ft. - All other projects
3. Total area of Riverfront Area on the site of the proposed project:
4. Proposed alteration of the Riverfront Area:
5. Has an alternatives analysis been done and is it attached to this NOI?
6. Was the lot where the activity is proposed created prior to August 1, 1996?

3. [X] Coastal Resource Areas: (See 310 CMR 10.25-10.35)

Check all that apply below. Attach narrative and supporting documentation describing how the project will meet all performance standards for each of the resource areas altered, including standards requiring consideration of alternative project design or location.

Online Users: Include your document transaction number (provided on your receipt page) with all supplementary information you submit to the Department.

Resource Area, Size of Proposed Alteration, Proposed Replacement (if any)
a. [] Designated Port Areas
b. [] Land Under the Ocean
c. [] Barrier Beach
d. [X] Coastal Beaches
e. [] Coastal Dunes



WPA Form 3 – Notice of Intent

Massachusetts Wetlands Protection Act M.G.L. c. 131, §40

Provided by MassDEP:
MassDEP File Number
Document Transaction Number
Boston (Dorchester)
City/Town

B. Buffer Zone & Resource Area Impacts (temporary & permanent) (cont'd)

	<u>Size of Proposed Alteration</u>	<u>Proposed Replacement (if any)</u>
f. <input type="checkbox"/> Coastal Banks	1. linear feet	
g. <input type="checkbox"/> Rocky Intertidal Shores	1. square feet	
h. <input type="checkbox"/> Salt Marshes	1. square feet	2. sq ft restoration, rehab., creation
i. <input type="checkbox"/> Land Under Salt Ponds	1. square feet	
	2. cubic yards dredged	
j. <input type="checkbox"/> Land Containing Shellfish	1. square feet	
k. <input type="checkbox"/> Fish Runs	Indicate size under Coastal Banks, inland Bank, Land Under the Ocean, and/or inland Land Under Waterbodies and Waterways, above	
	1. cubic yards dredged	
l. <input checked="" type="checkbox"/> Land Subject to Coastal Storm Flowage	no alteration of resource area	
	1. square feet	
4. <input type="checkbox"/> Restoration/Enhancement	If the project is for the purpose of restoring or enhancing a wetland resource area in addition to the square footage that has been entered in Section B.2.b or B.3.h above, please enter the additional amount here.	
	a. square feet of BVW	b. square feet of Salt Marsh
5. <input type="checkbox"/> Project Involves Stream Crossings		
	a. number of new stream crossings	b. number of replacement stream crossings

C. Other Applicable Standards and Requirements

Streamlined Massachusetts Endangered Species Act/Wetlands Protection Act Review

1. Is any portion of the proposed project located in **Estimated Habitat of Rare Wildlife** as indicated on the most recent Estimated Habitat Map of State-Listed Rare Wetland Wildlife published by the Natural Heritage and Endangered Species Program (NHESP)? To view habitat maps, see the *Massachusetts Natural Heritage Atlas* or go to http://www.mass.gov/dfwele/dfw/nhosp/regulatory_review/priority_habitat/online_viewer.htm.

a. Yes No **If yes, include proof of mailing or hand delivery of NOI to:**

**Natural Heritage and Endangered Species Program
Division of Fisheries and Wildlife
100 Hartwell Street, Suite 230
West Boylston, MA 01583**

b. Date of map _____



WPA Form 3 – Notice of Intent

Massachusetts Wetlands Protection Act M.G.L. c. 131, §40

Provided by MassDEP:
MassDEP File Number
Document Transaction Number
Boston (Dorchester)
City/Town

C. Other Applicable Standards and Requirements (cont'd)

If yes, the project is also subject to Massachusetts Endangered Species Act (MESA) review (321 CMR 10.18). To qualify for a streamlined, 30-day, MESA/Wetlands Protection Act review, please complete Section C.1.C, and include requested materials with this Notice of Intent (NOI); OR complete Section C.1.d, if applicable. *If MESA supplemental information is not included with the NOI, by completing Section 1 of this form, the NHESP will require a separate MESA filing which may take up to 90 days to review (unless noted exceptions in Section 2 apply, see below).*

1. c. Submit Supplemental Information for Endangered Species Review*

1. Percentage/acreage of property to be altered:
 - (a) within wetland Resource Area 0%
percentage/acreage
 - (b) outside Resource Area _____
percentage/acreage
2. Assessor's Map or right-of-way plan of site
3. Project plans for entire project site, including wetland resource areas and areas outside of wetlands jurisdiction, showing existing and proposed conditions, existing and proposed tree/vegetation clearing line, and clearly demarcated limits of work ****
 - (a) Project description (including description of impacts outside of wetland resource area & buffer zone)
 - (b) Photographs representative of the site
 - (c) MESA filing fee (fee information available at: http://www.mass.gov/dfwele/dfw/nhosp/regulatory_review/ mesa/ mesa_fee_schedule.htm).
Make check payable to "Commonwealth of Massachusetts - NHESP" and **mail to NHESP** at above address
Projects altering 10 or more acres of land, also submit:
 - (d) Vegetation cover type map of site
 - (e) Project plans showing Priority & Estimated Habitat boundaries

d. OR Check One of the Following

1. Project is exempt from MESA review.
Attach applicant letter indicating which MESA exemption applies. (See 321 CMR 10.14, http://www.mass.gov/dfwele/dfw/nhosp/regulatory_review/ mesa/ mesa_exemptions.htm; the NOI must still be sent to NHESP if the project is within estimated habitat pursuant to 310 CMR 10.37 and 10.59.)
2. Separate MESA review ongoing. _____
a. NHESP Tracking # 4/17/19
b. Date submitted to NHESP

* Some projects **not** in Estimated Habitat may be located in Priority Habitat, and require NHESP review (see <http://www.mass.gov/dfwele/dfw/nhosp/nhosp.htm>, regulatory review tab). Priority Habitat includes habitat for state-listed plants and strictly upland species not protected by the Wetlands Protection Act.

** MESA projects may not be segmented (321 CMR 10.16). The applicant must disclose full development plans even if such plans are not required as part of the Notice of Intent process.



WPA Form 3 – Notice of Intent

Massachusetts Wetlands Protection Act M.G.L. c. 131, §40

Provided by MassDEP:
MassDEP File Number
Document Transaction Number
Boston (Dorchester)
City/Town

C. Other Applicable Standards and Requirements (cont'd)

3. Separate MESA review completed.
Include copy of NHESP "no Take" determination or valid Conservation & Management Permit with approved plan.

2. For coastal projects only, is any portion of the proposed project located below the mean high water line or in a fish run?

a. Not applicable – project is in inland resource area only

b. Yes No If yes, include proof of mailing or hand delivery of NOI to either:

South Shore - Cohasset to Rhode Island, and the Cape & Islands:

North Shore - Hull to New Hampshire:

Division of Marine Fisheries -
Southeast Marine Fisheries Station
Attn: Environmental Reviewer
1213 Purchase Street – 3rd Floor
New Bedford, MA 02740-6694

Division of Marine Fisheries -
North Shore Office
Attn: Environmental Reviewer
30 Emerson Avenue
Gloucester, MA 01930

Also if yes, the project may require a Chapter 91 license. For coastal towns in the Northeast Region, please contact MassDEP's Boston Office. For coastal towns in the Southeast Region, please contact MassDEP's Southeast Regional Office.

3. Is any portion of the proposed project within an Area of Critical Environmental Concern (ACEC)?

a. Yes No If yes, provide name of ACEC (see instructions to WPA Form 3 or MassDEP Website for ACEC locations). **Note:** electronic filers click on Website.

b. ACEC

4. Is any portion of the proposed project within an area designated as an Outstanding Resource Water (ORW) as designated in the Massachusetts Surface Water Quality Standards, 314 CMR 4.00?

a. Yes No

5. Is any portion of the site subject to a Wetlands Restriction Order under the Inland Wetlands Restriction Act (M.G.L. c. 131, § 40A) or the Coastal Wetlands Restriction Act (M.G.L. c. 130, § 105)?

a. Yes No

6. Is this project subject to provisions of the MassDEP Stormwater Management Standards?

a. Yes. Attach a copy of the Stormwater Report as required by the Stormwater Management Standards per 310 CMR 10.05(6)(k)-(q) and check if:

1. Applying for Low Impact Development (LID) site design credits (as described in Stormwater Management Handbook Vol. 2, Chapter 3)

2. A portion of the site constitutes redevelopment

3. Proprietary BMPs are included in the Stormwater Management System.

b. No. Check why the project is exempt:

1. Single-family house

Online Users:
Include your document transaction number (provided on your receipt page) with all supplementary information you submit to the Department.



WPA Form 3 – Notice of Intent

Massachusetts Wetlands Protection Act M.G.L. c. 131, §40

Provided by MassDEP:	
MassDEP File Number	
Document Transaction Number	
Boston (Dorchester)	
City/Town	

C. Other Applicable Standards and Requirements (cont'd)

- 2. Emergency road repair
- 3. Small Residential Subdivision (less than or equal to 4 single-family houses or less than or equal to 4 units in multi-family housing project) with no discharge to Critical Areas.

D. Additional Information

Applicants must include the following with this Notice of Intent (NOI). See instructions for details.

Online Users: Attach the document transaction number (provided on your receipt page) for any of the following information you submit to the Department.

- 1. USGS or other map of the area (along with a narrative description, if necessary) containing sufficient information for the Conservation Commission and the Department to locate the site. (Electronic filers may omit this item.)
- 2. Plans identifying the location of proposed activities (including activities proposed to serve as a Bordering Vegetated Wetland [BVW] replication area or other mitigating measure) relative to the boundaries of each affected resource area.
- 3. Identify the method for BVW and other resource area boundary delineations (MassDEP BVW Field Data Form(s), Determination of Applicability, Order of Resource Area Delineation, etc.), and attach documentation of the methodology.
- 4. List the titles and dates for all plans and other materials submitted with this NOI.

a. Plan Title	

b. Prepared By	c. Signed and Stamped by

d. Final Revision Date	e. Scale

f. Additional Plan or Document Title	g. Date

- 5. If there is more than one property owner, please attach a list of these property owners not listed on this form.
- 6. Attach proof of mailing for Natural Heritage and Endangered Species Program, if needed.
- 7. Attach proof of mailing for Massachusetts Division of Marine Fisheries, if needed.
- 8. Attach NOI Wetland Fee Transmittal Form
- 9. Attach Stormwater Report, if needed.



WPA Form 3 – Notice of Intent

Massachusetts Wetlands Protection Act M.G.L. c. 131, §40

Provided by MassDEP:
MassDEP File Number
Document Transaction Number
Boston (Dorchester)
City/Town

E. Fees

- Fee Exempt: No filing fee shall be assessed for projects of any city, town, county, or district of the Commonwealth, federally recognized Indian tribe housing authority, municipal housing authority, or the Massachusetts Bay Transportation Authority.

Applicants must submit the following information (in addition to pages 1 and 2 of the NOI Wetland Fee Transmittal Form) to confirm fee payment:

0002239759	3/18/19
2. Municipal Check Number	3. Check date
e-Payment	
4. State Check Number	5. Check date
Commonwealth of Massachusetts	Department of Conservation & Recreation
6. Payor name on check: First Name	7. Payor name on check: Last Name

F. Signatures and Submittal Requirements

I hereby certify under the penalties of perjury that the foregoing Notice of Intent and accompanying plans, documents, and supporting data are true and complete to the best of my knowledge. I understand that the Conservation Commission will place notification of this Notice in a local newspaper at the expense of the applicant in accordance with the wetlands regulations, 310 CMR 10.05(5)(a).

I further certify under penalties of perjury that all abutters were notified of this application, pursuant to the requirements of M.G.L. c. 131, § 40. Notice must be made by Certificate of Mailing or in writing by hand delivery or certified mail (return receipt requested) to all abutters within 100 feet of the property line of the project location.

1. Signature of Applicant	4/16/2019
	2. Date
3. Signature of Property Owner (if different)	4/16/2019
	4. Date
5. Signature of Representative (if any)	
	6. Date

For Conservation Commission:

Two copies of the completed Notice of Intent (Form 3), including supporting plans and documents, two copies of the NOI Wetland Fee Transmittal Form, and the city/town fee payment, to the Conservation Commission by certified mail or hand delivery.

For MassDEP:

One copy of the completed Notice of Intent (Form 3), including supporting plans and documents, one copy of the NOI Wetland Fee Transmittal Form, and a **copy** of the state fee payment to the MassDEP Regional Office (see Instructions) by certified mail or hand delivery.

Other:

If the applicant has checked the "yes" box in any part of Section C, Item 3, above, refer to that section and the Instructions for additional submittal requirements.

The original and copies must be sent simultaneously. Failure by the applicant to send copies in a timely manner may result in dismissal of the Notice of Intent.



Massachusetts Department of Environmental Protection
 Bureau of Resource Protection - Wetlands
NOI Wetland Fee Transmittal Form
 Massachusetts Wetlands Protection Act M.G.L. c. 131, §40

Important: When filling out forms on the computer, use only the tab key to move your cursor - do not use the return key.



A. Applicant Information

1. Location of Project:

Constitution Beach Boston
 a. Street Address b. City/Town
0002239759 \$75.00 - please see attached fee calculation
 c. Check number explanation

2. Applicant Mailing Address:

Andy Backman
 a. First Name b. Last Name
Massachusetts Department of Conservation & Recreation
 c. Organization
251 Causeway Street, Suite 600
 d. Mailing Address
Boston MA 02114
 e. City/Town f. State g. Zip Code
617-626-1342 andy.backman@mass.gov
 h. Phone Number i. Fax Number j. Email Address

3. Property Owner (if different):

Nicholas Gove
 a. First Name b. Last Name
Massachusetts DCR, Deputy Commissioner for Recreation and Operations
 c. Organization
251 Causeway Street, Suite 600
 d. Mailing Address
Boston MA 02114
 e. City/Town f. State g. Zip Code
617-626-1250
 h. Phone Number i. Fax Number j. Email Address

To calculate filing fees, refer to the category fee list and examples in the instructions for filling out WPA Form 3 (Notice of Intent).

B. Fees

Fee should be calculated using the following process & worksheet. **Please see Instructions before filling out worksheet.**

Step 1/Type of Activity: Describe each type of activity that will occur in wetland resource area and buffer zone.

Step 2/Number of Activities: Identify the number of each type of activity.

Step 3/Individual Activity Fee: Identify each activity fee from the six project categories listed in the instructions.

Step 4/Subtotal Activity Fee: Multiply the number of activities (identified in Step 2) times the fee per category (identified in Step 3) to reach a subtotal fee amount. Note: If any of these activities are in a Riverfront Area in addition to another Resource Area or the Buffer Zone, the fee per activity should be multiplied by 1.5 and then added to the subtotal amount.

Step 5/Total Project Fee: Determine the total project fee by adding the subtotal amounts from Step 4.

Step 6/Fee Payments: To calculate the state share of the fee, divide the total fee in half and subtract \$12.50. To calculate the city/town share of the fee, divide the total fee in half and add \$12.50.



Massachusetts Department of Environmental Protection
 Bureau of Resource Protection - Wetlands
NOI Wetland Fee Transmittal Form
 Massachusetts Wetlands Protection Act M.G.L. c. 131, §40

B. Fees (continued)

Step 1/Type of Activity	Step 2/Number of Activities	Step 3/Individual Activity Fee	Step 4/Subtotal Activity Fee
2 (j). Other Activity	1	\$125.00	\$125.00
_____	_____	_____	_____
_____	_____	_____	_____
_____	_____	_____	_____
_____	_____	_____	_____
_____	_____	_____	_____
_____	_____	_____	_____
_____	_____	_____	_____
Step 5/Total Project Fee:			\$125.00
Step 6/Fee Payments:			
Total Project Fee:			\$125.00
			a. Total Fee from Step 5
State share of filing Fee:			\$50.00
			b. 1/2 Total Fee less \$12.50
City/Town share of filing Fee:			\$75.00
			c. 1/2 Total Fee plus \$12.50

C. Submittal Requirements

- a.) Complete pages 1 and 2 and send with a check or money order for the state share of the fee, payable to the Commonwealth of Massachusetts.

Department of Environmental Protection
 Box 4062
 Boston, MA 02211

- b.) **To the Conservation Commission:** Send the Notice of Intent or Abbreviated Notice of Intent; a **copy** of this form; and the city/town fee payment.

To MassDEP Regional Office (see Instructions): Send a copy of the Notice of Intent or Abbreviated Notice of Intent; a **copy** of this form; and a **copy** of the state fee payment. (E-filers of Notices of Intent may submit these electronically.)

List of Attachments to Notice of Intent

1. NOI fee calculation
2. Operations & Maintenance Plan Narrative
3. Map - USGS Locus
4. Maps – Savin Hill & Malibu Beach
 - FEMA Flood Zone Map
 - Coastal Wetland Resource Area Map
 - Project Area Maps
5. List of Mailed NOI files
6. Abutter Notification Documents

Attachment 1: NOI fee calculation

Department of Conservation and Recreation
Operations and Maintenance Plan
Savin Hill & Malibu Beach

DCR Operations & Maintenance Plans – NOI fee calculation

The activities are not related to construction. These are day-to-day maintenance activities conducted by DCR park staff. The most reasonable way to estimate project costs is to estimate salaries of the staff for the portions of their time that are spent with maintenance activities on the DCR beaches.

For each of the 4 NOIs, cost estimate is highlighted in the choices below from the listed City of Boston NOI filing fees.

City of Boston – NOI filing fees

- \$25 for projects that cost \$1,000 or less
- \$50 for projects that cost between \$1,000 - \$50,000
- \$75 for projects that cost between \$50,000 - \$100,000,
- .075% of the cost for projects that are more than \$100,000. The most we will charge you is \$1,500.

Given the required split between municipal and state filing fees, the city filing fee is calculated at \$75 for each NOI, and \$50 for the state, for a total filing fee of \$125.

Attachment 2: Project Narrative

Department of Conservation and Recreation
Operations and Maintenance Plan
Savin Hill & Malibu Beach



PROJECT NARRATIVE

Introduction

The Department of Conservation and Recreation (“Department” or “DCR”) seeks an Order of Conditions issued pursuant to the Massachusetts Wetlands Protection Act (WPA) and its implementing regulations, 310 CMR 10.00 et seq. (Regulations), for an Operations and Maintenance Plan (OMP), for Savin Hill Cove and Malibu Beach in Dorchester as defined in the resource area maps enclosed in this NOI package.

The intent of the OMP is to allow periodic, routine maintenance activities, in compliance with the WPA and Regulations, while providing for protection of coastal resource areas, improve DCR’s ability to provide proper maintenance at these locations and enhance the public enjoyment of Savin Hill and Malibu Beach. Operations and maintenance practices on coastal beaches must meet the WPA Performance Standards for Coastal Resource Areas by avoiding the adverse effects listed in 310 CMR 10.27. The planned activities within coastal wetland resource areas and their buffer zones are subject to jurisdiction under the WPA and its Regulations. Coastal wetland resources that fall within the area of work activities (shown on the Work Area map) are described in the Narrative for each property. Coastal wetland resource areas that occur outside the area of work activities are not described nor included in the NOI.

Operations and routine maintenance activities for DCR coastal properties are listed and described in the following pages.



SAVIN HILL COVE & MALIBU BEACH IN DORCHESTER OPERATIONS AND MAINTENANCE PLAN

1. **Equipment:** The Department utilizes a variety of equipment to maintain Savin Hill and Malibu Beach which includes 4-wheeled front end loaders for loading and removing debris, tractor drawn mechanical beach rakes consisting of a hydraulic operated conveyer tine and hopper collection system, 6-10 wheel heavy dump trucks disposal of debris, and 4-wheel drive utility vehicles for emergency response. The Department's equipment shall be operated on the beach and buffer zones for the purpose of collecting and removing debris or providing emergency response services. The equipment shall not be stored or left unattended on the beach. Equipment is stored at an off-site Department facility.
2. **Contractors and vendors:** The Department shall monitor contractor and vendor activities for compliance with approved operations or maintenance activities.
3. **Debris removal:** Debris, including organic material and man-made debris and trash, may be removed from the beach and other resource areas identified in this Project Narrative and buffer zones as needed. The Department will remove debris by hand whenever possible. Debris may be removed using a front-end loader and heavy dump trucks when other means are not feasible. Equipment shall be staged from the coastal beach or other solid surfaces to remove debris. Debris removal will not "alter" (as defined in 310 CMR 10.04) the coastal beach, other resource areas or buffer zones. Debris removal will not occur in the intertidal zone. Should debris removal operations require an alteration to the coastal beach, the Department shall file for an emergency certification. Collected debris shall not be stored at the project site and will be removed and disposed off-site.
4. **Marine life mortality and disposal:** The Department follows proper and routine disposal procedures of individual vertebrate and invertebrate marine mortalities. In the case of large-volume of individuals, or large-scale marine life such as whale carcasses, the Department will consult with the proper state and federal agencies to create an acceptable plan based on guidelines and recommendations for proper disposal. If removal and disposal operations require, the Department shall file for an emergency certification.
5. **Mechanical beach cleaning:** This activity is essential for public health and safety and will be accomplished in such a manner to preserve the existing form, volume and grain-size distribution of the beach to avoid an alteration to the resource area. Beaching raking is only performed in the resource work areas identified in the enclosed maps. Beach raking will not occur in the intertidal zone. The Department's tractor drawn mechanical beach rake collects trash and debris buried in the top layer of loose sand to a depth of 3". The trash and debris collected in the beach rakes hopper is then dumped into a 6-10 wheel dump truck and disposed of off-site. Front end loaders are utilized to remove debris that is too large for hand collection. The beach is periodically cleaned in this manner, 1-2 times per week, during the months of May through September.
6. **Special events:** The Department shall require event proponents to submit a *State Parks Special Use Permit* for applicable events. If the activity warrants, the Department will require the Permittee to file a Request for Determination of Applicability (RDA) or a Notice of Intent (NOI) with the Conservation Commission.



7. **Coastal storm surges, flooding, reclamation of sand, associated clean-up:** During coastal storms and astronomical high tides, surge impacts and over wash is often observed depositing sand and other debris onto the abutting sidewalks, public way and pavilion areas. This material represents a public safety hazard and may require closure of the public way during extreme events. After coastal storms cease, the Department may remove sand and other debris via heavy equipment. Debris collected from the public way will be disposed of offsite.
8. **Infrastructure Repairs and Maintenance:** Existing recreational facilities and structures such as the Malibu Beach Bathhouse, Harbor Walk, pavilions and playground require routine maintenance. DCR must service these assets as well as other infrastructure such as the lighting along the boardwalk and parking area when repairs are needed due to vandalism, or when wear and tear requires replacement of some its components. This operation shall exclude the full removal or reconstruction of any entire serviced infrastructure.
9. **Minor activities:** the following activities may be performed year-round as needed:
 - Manual removal of trash from the beach and buffer zone, including sidewalks, pavilions, bathhouse, etc.;
 - Mowing, pruning or string trimming of vegetation on the parking lot side of the beach boardwalk, not within in the resource work area;
 - Power washing and graffiti removal from sidewalks, buildings, pavilions, bathhouse, concession stand and other related hardscapes and infrastructure;
 - Parking area, sidewalk and public way maintenance activities such as pot-hole repairs, application of pavement markings, street light maintenance, sign installation and maintenance, and maintenance of storm water and flood control infrastructure¹.
 - Activities necessary for operations and planning that are temporary and have negligible impact e.g. sampling, survey, and monitoring.
10. **Amendments:** Any change of the work and activities described in this OMP shall require the Department to file a written request for amendment with the Conservation Commission/or the Department of Environmental Protection.
11. **Emergency Certification Process:** The Department will seek an emergency certification in accordance with 310 CMR 10.06 for any warranted, non-approved activities needed for the protection of public health or safety.

¹ The Department's storm water maintenance activities are outlined in the Department's National Pollutant Discharge Elimination System (NPDES) permit. A copy of our NPDES permit and Checklist for Storm Water Report are enclosed with the NOI.



SAVIN HILL & MALIBU BEACH - COASTAL WETLAND RESOURCE AREAS

This section provides a brief description of each coastal resource area covered by the WPA and its Regulations that is within the OMP project site. Each section begins with the regulatory definition of the resource area, followed by WPA performance standards, and applicability to the site. Coastal wetland resource areas at this site include Coastal Beach, Coastal Bank, Salt Marsh, and Land Subject to Storm Flowage. These resource areas are delineated on the Malibu Beach coastal wetland resources maps.

A. Coastal Beach:

Coastal Beach is defined as any unconsolidated sediment subject to wave, tidal and coastal storm action which forms the gently sloping shore of a body of salt water and includes tidal flats. Coastal beaches extend from the mean low water line landward to the dune line, coastal bank line or the seaward edge of existing human-made structures, whichever is closest to the ocean (310 CMR 10.27(2)).

WPA Performance Standards:

Any project on a coastal beach shall not have an adverse effect by increasing erosion, decreasing the volume or changing the form of any such coastal beach or an adjacent or down-drift coastal beach.

Applicability for Operations & Maintenance Activities:

On this site, the coastal beach is the area characterized by the sandy substrate, occupying the intertidal area that extends along the waterfront, and extending landward toward the property boundary and adjacent local road system. Operations and maintenance activities that are conducted on a regular basis by DCR staff on DCR coastal properties are described Attachment 3: Project Narrative. All numbered activities are potentially applicable to the coastal beach resource area at Malibu Beach. **The day-to-day maintenance activities will not alter nor adversely affect this coastal resource.**

B. Land Subject to Coastal Storm Flowage:

Land Subject to Coastal Storm Flowage includes low-lying areas along the coast that are within the 100-year flood hazard zone as determined by the Federal Emergency Management Agency (FEMA).

Applicability for Operations & Maintenance Activities:

At this site, the resource area includes the beach and the northeastern part of the property landward from the beach to the roadway / property boundary. (refer to attached FIRM map). **The Operations and Maintenance activities listed in Attachment 3: Project Narrative will not result in adverse impacts to storm damage prevention and flood control interests.**

Attachment 3: USGS Locus Map

Dorchester Shores Reservation

USGS Locus

Dorchester Shores Reservation

Operations and Maintenance Plan

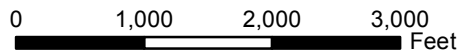
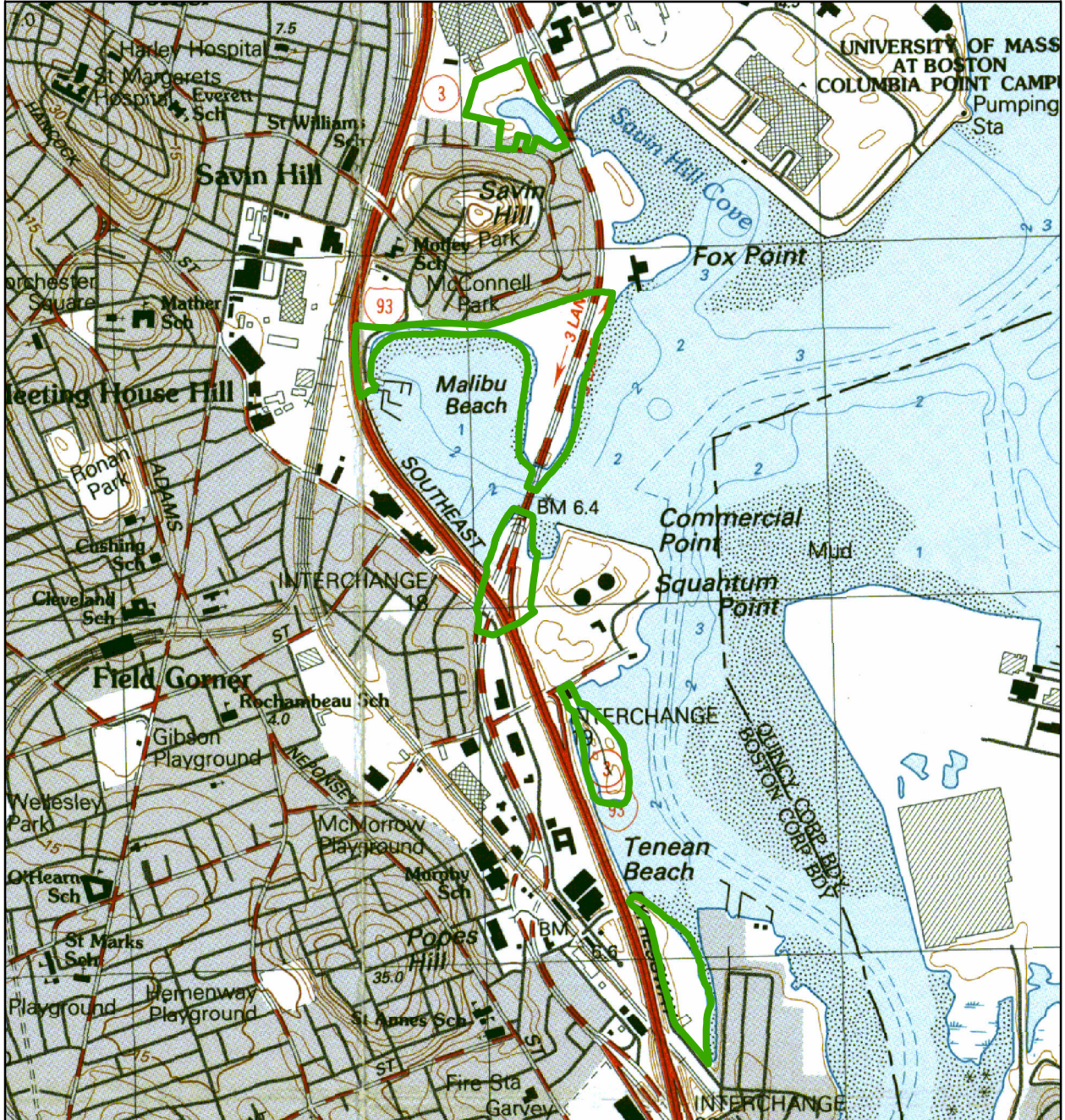

This is not a professional land survey.
Grid: MA State Plane Meters, NAD 1983.
Sources: MassGIS, USGS, DCR. 2019-01



Attachment 4: Maps

Savin Hill & Malibu Beach

NOTES TO USERS

This map is for use in administering the National Flood Insurance Program. It does not necessarily identify all areas subject to flooding, particularly from local drainage sources of small size. The community map repository should be consulted for possible updated or additional flood hazard information.

To obtain more detailed information in areas where **Base Flood Elevations (BFEs)** and/or **floodways** have been determined, users are encouraged to consult the Flood Profiles and Floodway Data and/or Summary of Stillwater Elevations tables contained within the Flood Insurance Study (FIS) Report that accompanies this FIRM. Users should be aware that BFEs shown on the FIRM represent rounded whole-foot elevations. These BFEs are intended for flood insurance rating purposes only and should not be used as the sole source of flood elevation information. Accordingly, flood elevation data presented in the FIS Report should be utilized in conjunction with the FIRM for purposes of construction and/or floodplain management.

Coastal Base Flood Elevations shown on this map apply only landward of 0.0' North American Vertical Datum of 1988 (NAVD 88). Users of this FIRM should be aware that coastal flood elevations are also provided in the Summary of Stillwater Elevations table in the Flood Insurance Study Report for this jurisdiction. Elevations shown in the Summary of Stillwater Elevations table should be used for construction and/or floodplain management purposes when they are higher than the elevations shown on this FIRM.

Boundaries of the **floodways** were computed at cross sections and interpolated between cross sections. The floodways were based on hydraulic considerations with regard to requirements of the National Flood Insurance Program. Floodway widths and other pertinent floodway data are provided in the Flood Insurance Study Report for this jurisdiction.

The AE Zone category has been divided by a **Limit of Moderate Wave Action (LIMWA)**. The LIMWA represents the approximate landward limit of the 1.5-foot breaking wave. The effects of wave hazards between the VE Zone and the LIMWA (or between the shoreline and the LIMWA for areas where VE Zones are not identified) will be similar to, but less severe than those in the VE Zone.

Certain areas not in Special Flood Hazard Areas may be protected by **flood control structures**. Refer to Section 2.4 "Flood Protection Measures" of the Flood Insurance Study Report for information on flood control structures for this jurisdiction.

The **projection** used in the preparation of this map was Massachusetts State Plane Mainland Zone (FIPS zone 2001). The **horizontal datum** was NAD 83, GRS 1980 spheroid. Differences in datum, spheroid, projection or UTM zones used in the production of FIRMs for adjacent jurisdictions may result in slight positional differences in map features across jurisdiction boundaries. These differences do not affect the accuracy of this FIRM.

Flood elevations on this map are referenced to the North American Vertical Datum of 1988. These flood elevations must be compared to structure and ground elevations referenced to the same vertical datum. For information regarding conversion between the National Geodetic Vertical Datum of 1929 and the North American Vertical Datum of 1988, visit the National Geodetic Survey website at <http://www.ngs.noaa.gov> or contact the National Geodetic Survey at the following address:

NGS Information Services
NOAA, NNGS12
National Geodetic Survey
SSMC-3, #9202
1315 East-West Highway
Silver Spring, Maryland 20910-3282
(301) 713-3242

To obtain current elevation, description, and/or location information for **bench marks** shown on this map, please contact the Information Services Branch of the National Geodetic Survey at (301) 713-3242, or visit its website at <http://www.ngs.noaa.gov>.

Base map information shown on this FIRM is derived from Massachusetts Geographic Information System (MassGIS) digital ortho-photography produced at 45 centimeter (2005) and 30 centimeter (2008) resolution. Aerial photography is dated Spring 2005 and Spring 2008.

The **profile baselines** depicted on this map represent the hydraulic modeling baselines that match the flood profiles in the FIS report. As a result of improved topographic data, the **profile baseline**, in some cases, may deviate significantly from the channel centerline or appear outside the SFHA.

Based on updated topographic information, this map reflects more detailed and up-to-date **stream channel configurations** and **floodplain delineations** than those shown on the previous FIRM for this jurisdiction. As a result, the Flood Profiles and Floodway Data Tables for multiple streams in the Flood Insurance Study Report (which contains authoritative hydraulic data) may reflect stream channel distances that differ from what is shown on the map. Also, the road to floodplain relationships for unrevised streams may differ from what is shown on previous maps.

Corporate limits shown on this map are based on the best data available at the time of publication. Because changes due to annexations or de-annexations may have occurred after this map was published, map users should contact appropriate community officials to verify current corporate limit locations.

Please refer to the separately printed **Map Index** for an overview map of the county showing the layout of map panels, community map repository addresses, and a Listing of Communities table containing National Flood Insurance Program dates for each community as well as a listing of the panels on which each community is located.

For information on available products associated with this FIRM visit the **Map Service Center (MSC)** website at <http://msc.fema.gov>. Available products may include previously issued Letters of Map Change, a Flood Insurance Study Report, and/or digital versions of this map. Many of these products can be ordered or obtained directly from the MSC website.

If you have **questions about this map**, how to order products, or the National Flood Insurance Program in general, please call the **FEMA Map Information eXchange (FMIX)** at 1-877-FEMA-MAP (1-877-336-2627) or visit the FEMA website at <http://www.fema.gov/business/infp>.

Only coastal structures that are certified to provide protection from the 1-percent-annual-chance flood are shown on this panel. However, all structures taken into consideration for the purpose of coastal flood hazard analysis and mapping are present in the DFIRM database in S_Gen_Struct.

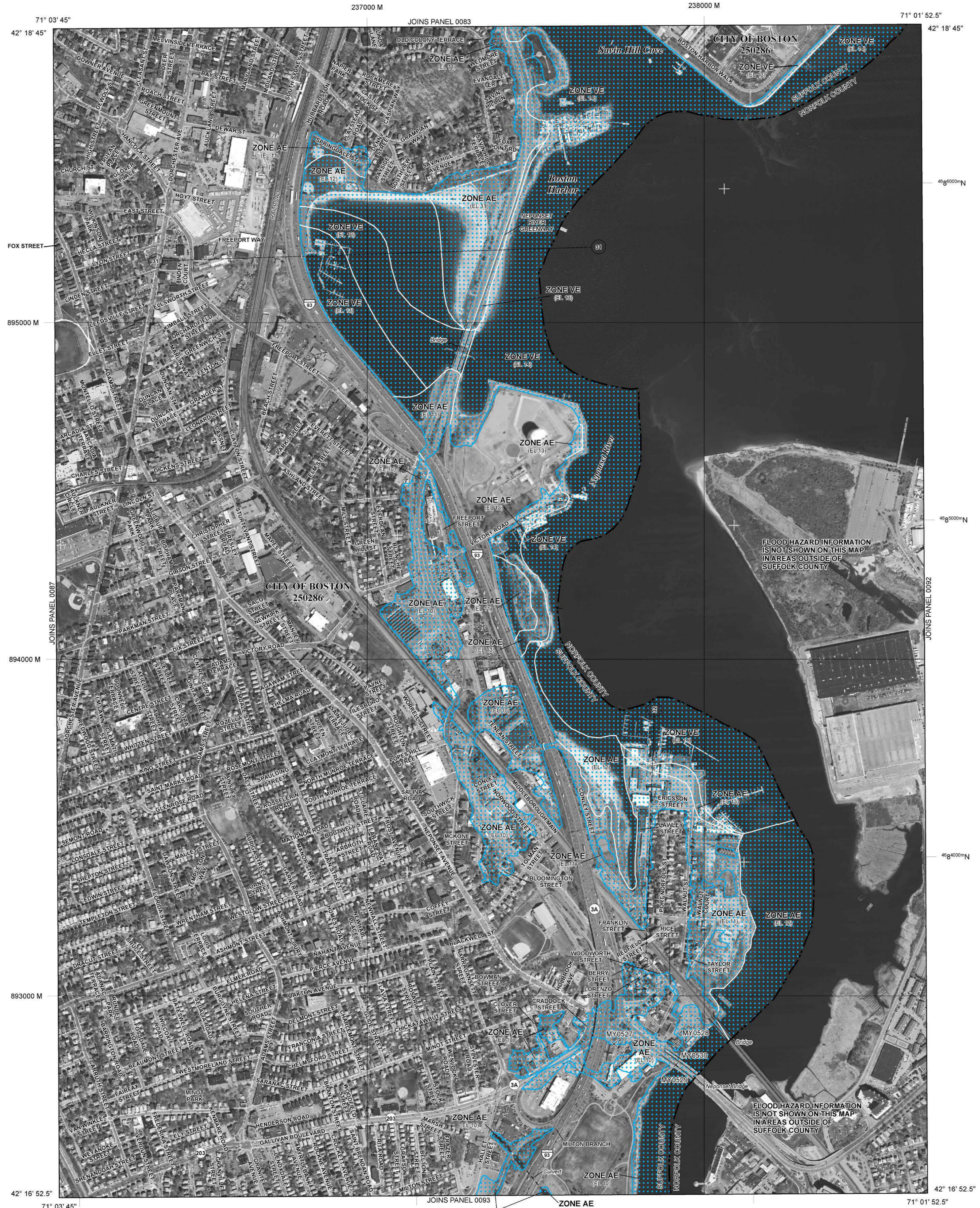

LEGEND

- SPECIAL FLOOD HAZARD AREAS (SFHAs) SUBJECT TO INUNDATION BY THE 1% ANNUAL CHANCE FLOOD. The 1% annual chance flood (100-year flood), also known as the base flood, is the flood that has a 1% chance of being equaled or exceeded in any given year. The Special Flood Hazard Area is the area subject to flooding by the 1% annual chance flood. Areas of Special Flood Hazard include Zones A, AE, AH, AO, AR, AV, V, and VE. The Base Flood Elevation is the water-surface elevation of the 1% annual chance flood.
 - ZONE AE** No Base Flood Elevations determined.
 - ZONE AE** Base Flood Elevations determined.
 - ZONE AH** Flood depths of 1 to 3 feet (usually areas of ponding); Base Flood Elevations determined.
 - ZONE AO** Flood depths of 1 to 3 feet (usually sheet flow on sloping terrain); average depths determined. For areas of alluvial fan flooding, velocities also determined.
 - ZONE AR** Special Flood Hazard Areas formerly protected from the 1% annual chance flood by a flood control system that was subsequently destroyed. Zone AR indicates that the former flood control system is being restored to provide protection from the 1% annual chance or greater flood.
 - ZONE AV** Area to be protected from 1% annual chance flood by a Federal flood protection system under construction; no Base Flood Elevations determined.
 - ZONE V** Coastal flood zone with velocity hazard (wave action); no Base Flood Elevations determined.
 - ZONE VE** Coastal flood zone with velocity hazard (wave action); Base Flood Elevations determined.
 - FLOODWAY AREAS IN ZONE AE
- The floodway is the channel of a stream plus any adjacent floodplain areas that must be kept free of encroachment so that the 1% annual chance flood can be carried without substantial increases in flood heights.
- OTHER FLOOD AREAS
 - ZONE X** Areas of 0.2% annual chance flood; areas of 1% annual chance flood with average depths of less than 1 foot or with drainage areas less than 1 square mile; and areas protected by levees from 1% annual chance flood.
 - OTHER AREAS
 - ZONE X** Areas determined to be outside the 0.2% annual chance floodplain.
 - ZONE D** Areas in which flood hazards are undetermined, but possible.
 - COASTAL BARRIER RESOURCES SYSTEM (CBRS) AREAS
 - OTHERWISE PROTECTED AREAS (OPAs)
- CBRS areas and OPAs are normally located within or adjacent to Special Flood Hazard Areas.
- 1% Annual Chance Floodplain Boundary
 - 0.2% Annual Chance Floodplain Boundary
 - Floodway boundary
 - Zone D boundary
 - CBRS and OPA boundary
 - Boundary dividing Special Flood Hazard Area Zones and boundary dividing Special Flood Hazard Areas of different Base Flood Elevations, flood depths, or flood velocities.
 - Limit of Moderate Wave Action
 - Limit of Moderate Wave Action coincident with Zone Break
 - Base Flood Elevation line and value; elevation in feet*
 - Base Flood Elevation value where uniform within zone; elevation in feet*
- *Referenced to the North American Vertical Datum of 1988

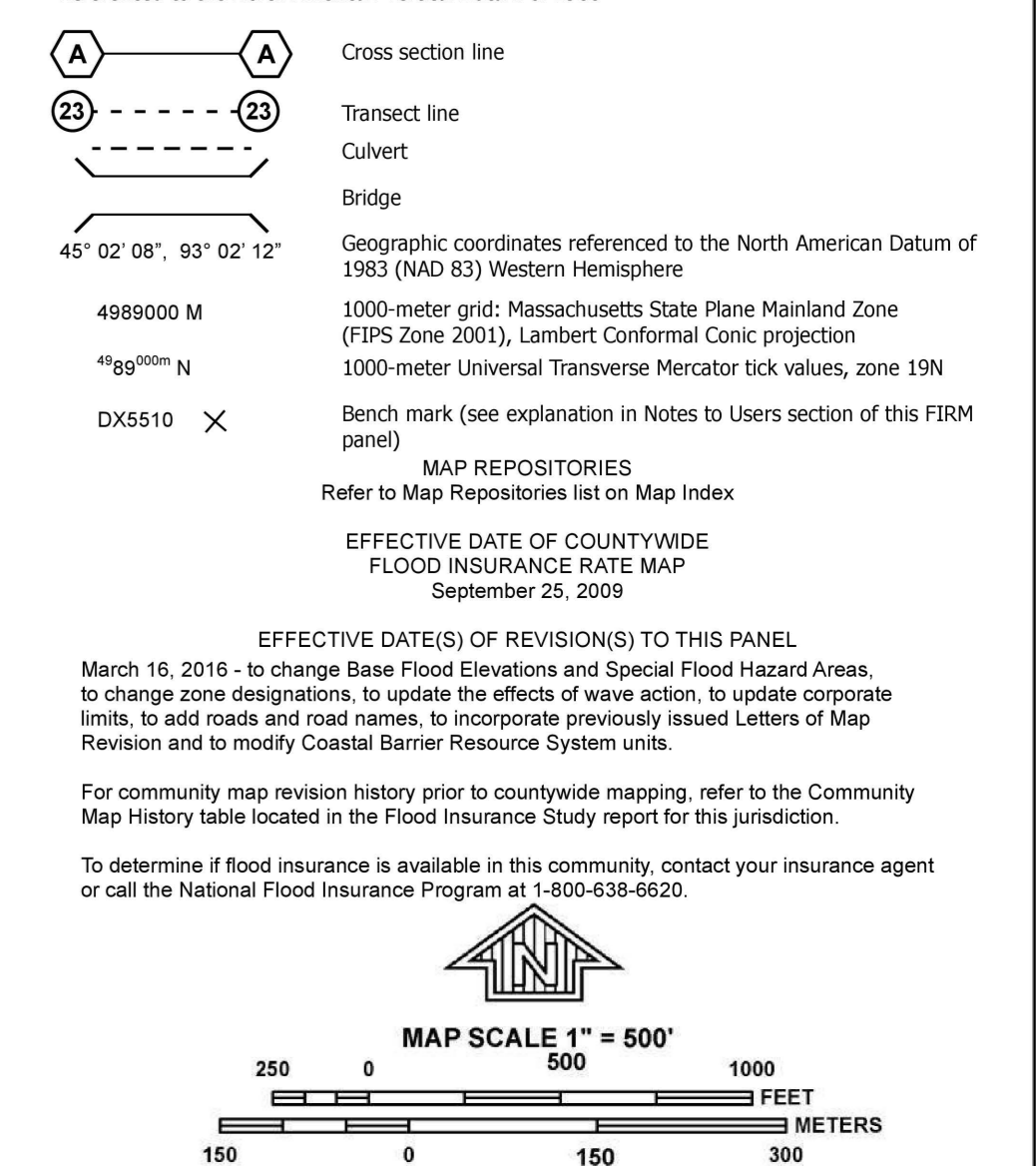

NATIONAL FLOOD INSURANCE PROGRAM

PANEL 0091J

FIRM FLOOD INSURANCE RATE MAP SUFFOLK COUNTY, MASSACHUSETTS (ALL JURISDICTIONS)

PANEL 91 OF 176
(SEE MAP INDEX FOR FIRM PANEL LAYOUT)

CONTAINS:

COMMUNITY	NUMBER	PANEL	SUFFIX
BOSTON, CITY OF	250286	0091	J

Notice to User: The **Map Number** shown below should be used when placing map orders; the **Community Number** shown above should be used on insurance applications for the subject community.

MAP NUMBER 25025C0091J
MAP REVISED MARCH 16, 2016
Federal Emergency Management Agency

Wetland Resources

Savin Hill & Malibu Beach

Operations and Maintenance Plan

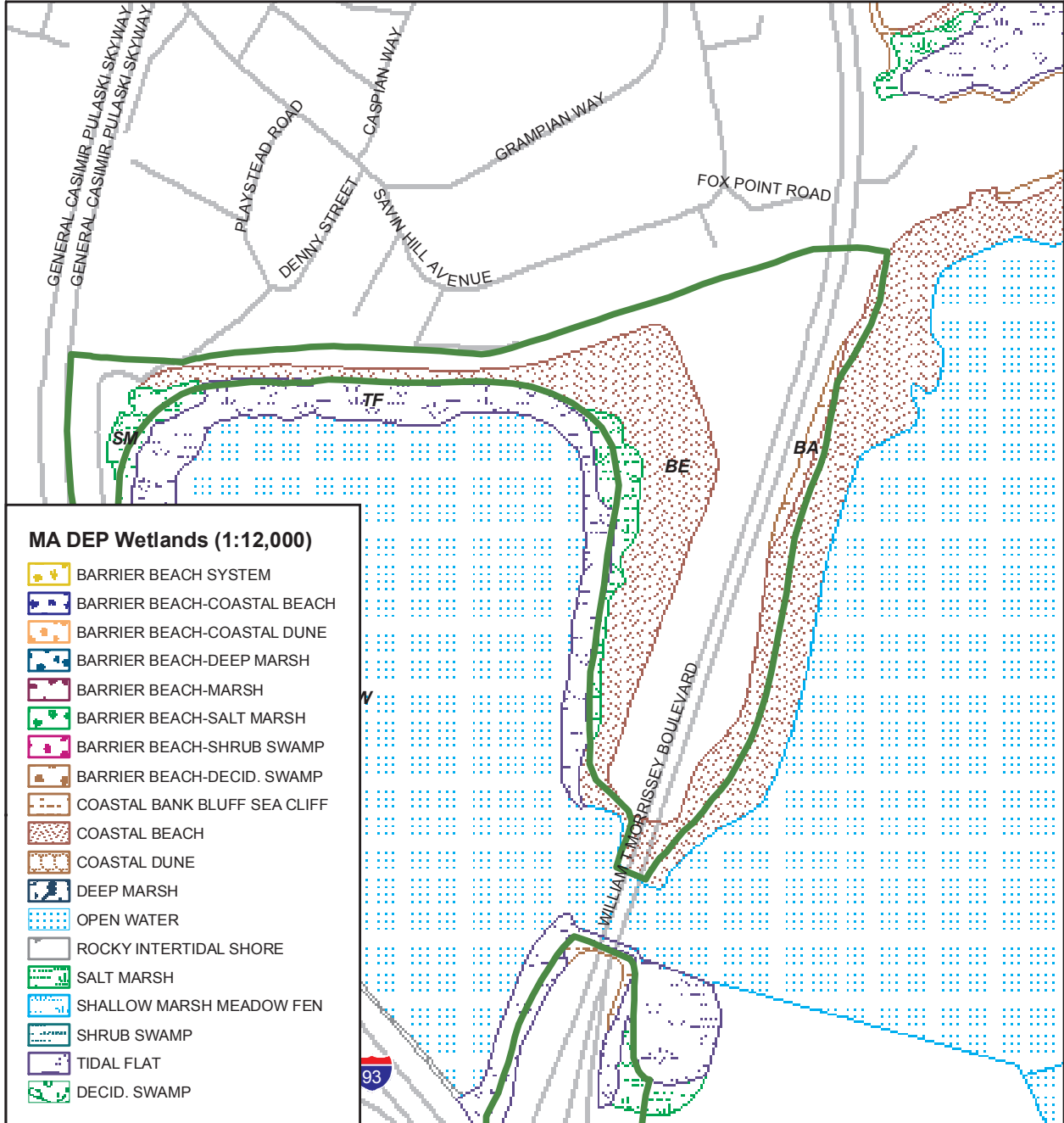

Site (tideland not shown)

This is not a professional land survey.
Grid: MA State Plane Meters, NAD 1983.
Sources: MassGIS, USGS, DCR. 2019-04



South Boston

Dorchester Shores Reservation
Savin Hill & Malibu Beach

Operations and
Maintenance Plan

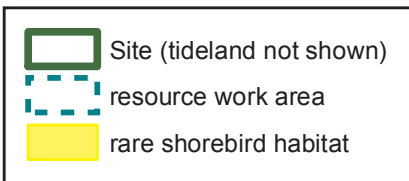

This is not a professional land survey.
Grid: StatePlane Meters, NAD1983.
Sources: MassGIS, DCR, Google
orthoimage service c.2019. 2019-04

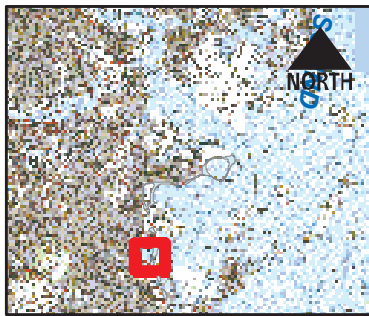

0 500
feet

1 inch = 600 feet



Work Area

**Savin Hill & Malibu Beach
Dorchester**

**Operations and
Maintenance Plan**

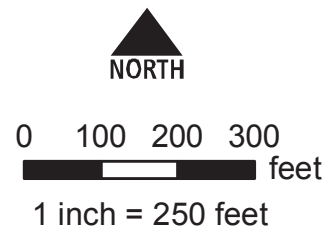
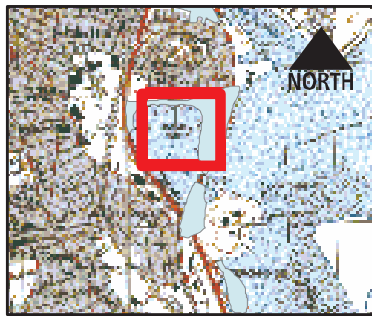
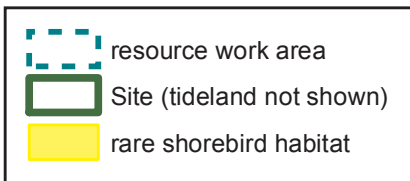
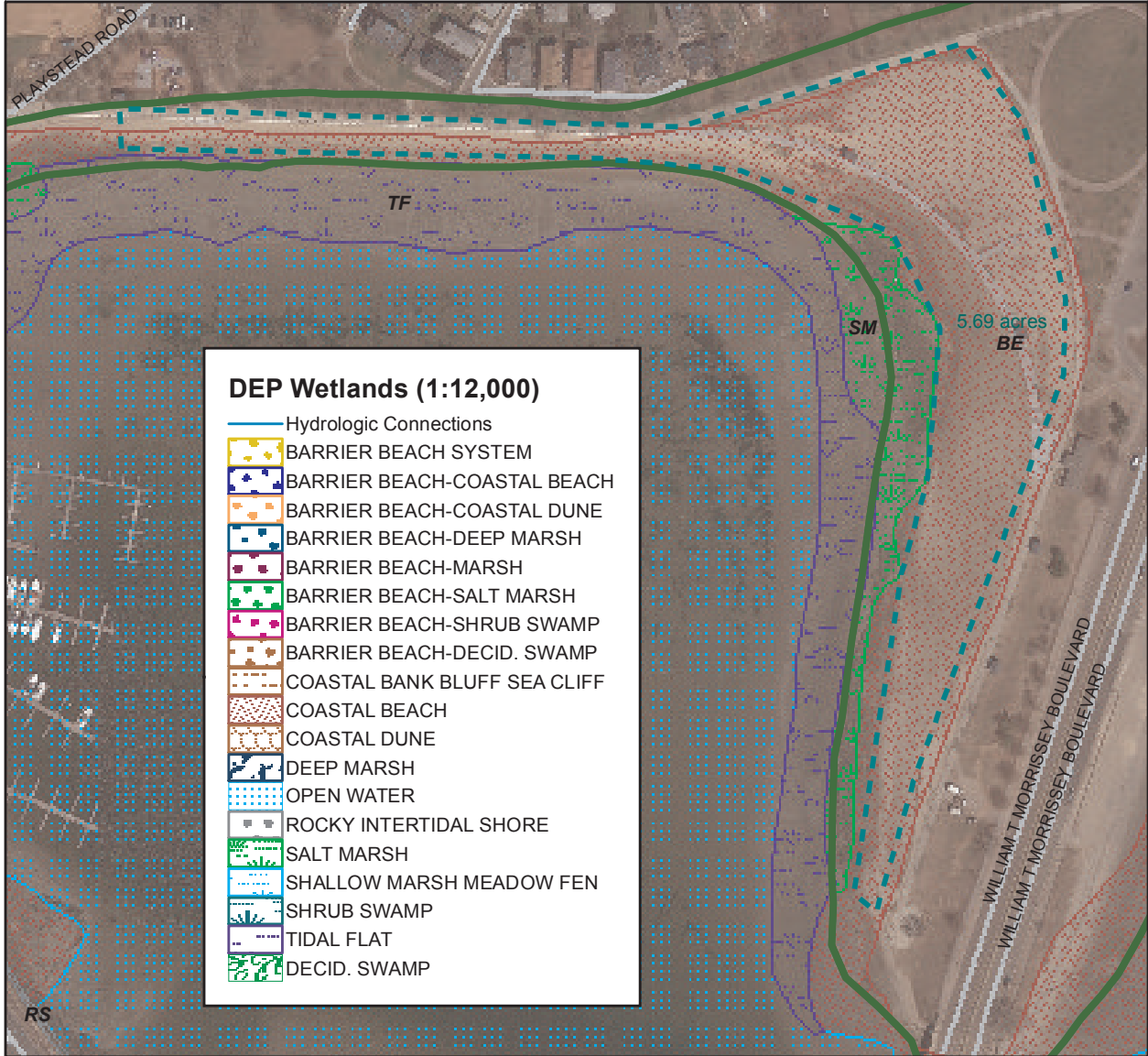

This is not a professional land survey.
Grid: StatePlane Meters, NAD1983.
Sources: MassGIS, DCR, Google
orthoimage service c.2019. 2019-04



Attachment 5: List of NOI Filings

Department of Conservation and Recreation
Operations and Maintenance Plan
Savin Hill & Malibu Beach

1. Original and copies delivered to:
Boston Conservation Commission
1 City Hall Square, Room 709
Boston, MA 02201

2. Copy of NOI mailed to:
Natural Heritage and Endangered Species Program
Division of Fisheries and Wildlife
1 Rabbit Hill Road,
Westborough, MA 01581
Main Phone: 508.389.6360

3. Copy of NOI mailed to:
Department of Environmental Protection, Northeast Region
205B Lowell Street
Wilmington, Massachusetts 01887
Main Phone: 978-694-3200

**U.S. Postal Service™
CERTIFIED MAIL® RECEIPT**
Domestic Mail Only

OFFICIAL USE

For delivery information, visit our website at www.usps.com®

Extra Services & Fees (check box, add fee as appropriate)

Return Receipt (hardcopy) \$ _____

Return Receipt (electronic) \$ _____

Certified Mail Restricted Delivery \$ _____

Adult Signature Required \$ _____

Adult Signature Restricted Delivery \$ _____

Postmark
Here

Total Postage and Fees \$ _____

Sent to **MA Dept. of Fish & Game NHESP**
Street and Apt. No. or PO Box No. **1 Rabbit Hill Rd.**
City, State, ZIP+4® **Westborough, MA 01581**

PS Form 3811, April 2015 PSN 7530-02-000-9053 See Reverse for Instructions

**U.S. Postal Service™
CERTIFIED MAIL® RECEIPT**
Domestic Mail Only

OFFICIAL USE

For delivery information, visit our website at www.usps.com®

Extra Services & Fees (check box, add fee as appropriate)

Return Receipt (hardcopy) \$ _____

Return Receipt (electronic) \$ _____

Certified Mail Restricted Delivery \$ _____

Adult Signature Required \$ _____

Adult Signature Restricted Delivery \$ _____

Postmark
Here

Total Postage and Fees \$ _____

Sent to **DEP Northwest Region HQ**
Street and Apt. No. or PO Box No. **205 B Lowell St.**
City, State, ZIP+4® **Wilmington, MA 01887**

PS Form 3811, April 2015 PSN 7530-02-000-9053 See Reverse for Instructions

SENDER: COMPLETE THIS SECTION

- Complete items 1, 2, and 3.
- Print your name and address on the reverse so that we can return the card to you.
- Attach this card to the back of the mailpiece, or on the front if space permits.

1. Article Addressed to:

*Dept. of Fish & Game
Natural Heritage & End. Sp. Program
1 Rabbit Hill Rd.
Westborough, MA 01581*



9590 9402 4792 8344 2559 02

2. Article Number (Transfer from service label)

7016 1370 0001 0919 3095

PS Form 3811, July 2015 PSN 7530-02-000-9053

COMPLETE THIS SECTION ON DELIVERY

- A. Signature Agent
- B. Received by (Printed Name) Addressee
- C. Date of Delivery
- D. Is delivery address different from item 1? Yes
If YES, enter delivery address below: No

3. Service Type

Priority Mail Express®

Adult Signature

Adult Signature Restricted Delivery

Certified Mail®

Certified Mail Restricted Delivery

Collect on Delivery

Collect on Delivery Restricted Delivery

Insured Mail (over \$500)

Registered Mail™

Registered Mail Restricted Delivery

Return Receipt for Merchandise

Signature Confirmation™

Signature Confirmation Restricted Delivery

Domestic Return Receipt

SENDER: COMPLETE THIS SECTION

- Complete items 1, 2, and 3.
- Print your name and address on the reverse so that we can return the card to you.
- Attach this card to the back of the mailpiece, or on the front if space permits.

1. Article Addressed to:

*DEP Northwest Region HQ
205 B Lowell St.
Wilmington, MA 01887*



9590 9402 4792 8344 2558 96

2. Article Number (Transfer from service label)

7016 1370 0001 0919 3088

PS Form 3811, July 2015 PSN 7530-02-000-9053

COMPLETE THIS SECTION ON DELIVERY

- A. Signature Agent Addressee
- B. Received by (Printed Name)
- C. Date of Delivery
- D. Is delivery address different from item 1? Yes
If YES, enter delivery address below: No

3. Service Type

Priority Mail Express®

Adult Signature

Adult Signature Restricted Delivery

Certified Mail®

Certified Mail Restricted Delivery

Collect on Delivery

Collect on Delivery Restricted Delivery

Insured Mail (over \$500)

Registered Mail™

Registered Mail Restricted Delivery

Return Receipt for Merchandise

Signature Confirmation™

Signature Confirmation Restricted Delivery

Domestic Return Receipt

Attachment 6: Abutter Notification Documents

Department of Conservation and Recreation
Operations and Maintenance Plan
Savin Hill & Malibu Beach

NOTIFICATION TO ABUTTERS UNDER THE WETLANDS PROTECTION ACT

In accordance with the Wetlands Protection Act (MGL c. 131, § 40) and its regulations (310 CMR 10.00), **a public hearing will be held by the Boston Conservation Commission to review a Notice of Intent filed by the Massachusetts Department of Conservation and Recreation (DCR) for DCR's Operations and Maintenance Plan for Savin Hill Cove and Malibu Beach in Dorchester.** The Operations and Maintenance Plan concerns routine maintenance activities at DCR's Dorchester beaches within the jurisdiction of the Wetlands Protection Act. You are being notified of this meeting as an abutter as defined in the regulations.

The public hearing will be held Wednesday, May 1, 2019 at 6:00 pm in the Piemonte Room, 5th floor of the Boston City Hall. You also may confirm and review hearing dates and agenda items at: <https://www.boston.gov/public-notices>

Applicant: Massachusetts Department of Conservation and Recreation
251 Causeway Street, Suite 600, Boston, MA 02114

A copy of the Notice of Intent or additional information may be obtained from DCR by contacting Andy Backman at DCR at the above address, at 617-626-1342 or Andy.Backman@mass.gov. A copy of the Notice of Intent may be examined at the Conservation Commission office in Room 709 at Boston City Hall during its set normal business hours. The Conservation Commission also can be contacted at (617) 635-3850.

Affidavit of Service

Under the Massachusetts Wetlands Protection Act and the Boston Wetlands Bylaw

I, KEVIN THIBEAULT, hereby certify under the pains & penalties of perjury that on 4/12/19 I gave notification to abutters in compliance with the second paragraph of Massachusetts General Laws Chapter 131, section 40, and the Boston Wetlands Bylaw, in connection with the following matter:

Operations and Maintenance Plans for DCR beach facilities in Boston

The form of notification, and a list of the butters to whom it was given and their addresses, are attached to this Affidavit of Service.

Name (signature)

Date

4/12/19

Name (print)

KEVIN THIBEAULT

PID	OWNER	ADDRESSEE	MLG_ADDRESS	MLG_CITY STATE	MLG_ZIP CODE	LOC_ADDRESS	LOC_CITY	LOC_ZIP CODE
1302238000	CITY OF BOSTON		SPRINGDALE	DORCHESTER MA	02125	SPRINGDALE ST	DORCHESTER	02125
1302238001	COMMONWEALTH OF MASS		SPRINGDALE	DORCHESTER MA	02125	SPRINGDALE ST	DORCHESTER	02125
1302238002	DOR YACHT CLUB INC LESSEE	C/O TREASURER	100 PLAYSTEAD RD	DORCHESTER MA	02125	SPRINGDALE ST	DORCHESTER	02125
1302284004	ROBIDEAU DUSTIN T	C/O DUSTIN T ROBIDEAU	18 BAYSIDE ST UNIT 3	DORCHESTER MA	02125	18 BAYSIDE ST Apt 2	DORCHESTER	02125
1302284006	ROBIDEAU DUSTIN	C/O DUSTIN ROBIDEAU	56 WHITECAPS DR	E FALMOUTH MA	02536	18 BAYSIDE ST Apt 3	DORCHESTER	02125
1302284000	EIGHTEEN BAYSIDE ST CONDO TR	C/O EDWARD BAKER	80 HAZLEWOOD DR	NORWOOD MA	02062	18 BAYSIDE ST	DORCHESTER	02125
1302284002	HARVEY RYAN D	C/O RYAN D HARVEY	18 BAYSIDE ST #1	DORCHESTER MA	02125	18 BAYSIDE ST Apt 1	DORCHESTER	02125
1302293000	ROSS ROBERT C	C/O ROBERT C ROSS	65 HOWE ST	QUINCY MA	02169	18 SOUTHVIEW ST	DORCHESTER	02125
1302299000	CLAIRE M CRONIN BE	C/O CLAIRE M CRONIN	199 SAVIN HILL AVE	DORCHESTER MA	02125	199 SAVIN HILL AV	DORCHESTER	02125
1302292000	9 SOUTHVIEW STREET		9 SOUTHVIEW ST	DORCHESTER MA	02122	9 SOUTHVIEW ST	DORCHESTER	02125
1302295000	CIULLA MICHAEL A	C/O MICHAEL CIULLA	10 SOUTHVIEW ST	DORCHESTER MA	02125	10 SOUTHVIEW ST	DORCHESTER	02125
1302291000	SZCZESNY STELLA		5 SOUTH VIEW	DORCHESTER MA	02125	5 SOUTHVIEW ST	DORCHESTER	02125
1302294000	HARRISON CHRISTOPHER BE	C/O CHRISTOPHER HARRISON	14 SOUTHVIEW ST	DORCHESTER MA	02125	14 SOUTHVIEW ST	DORCHESTER	02125
1302296000	DAVIS KURT E	C/O KURT E DAVIS	6 SOUTHVIEW ST	DORCHESTER MA	02125	6 SOUTHVIEW ST	DORCHESTER	02125