



Historic Window & Door Holdings
 12 Forest Road, Junction 123&123A
 P.O. Box 138
 Alstead, N.H. 03602-0138

"4 LIGHT 1/2 MOON TRANSOM TO REMAIN"

ALL EXISTING
 MILLWORK TO
 REMAIN

26 5/8" = WIDTH

26 5/8" = WIDTH

ASTRAGAL ON LEFT DOOR

HEIGHT = 82 3/8"
 BOTH DOORS

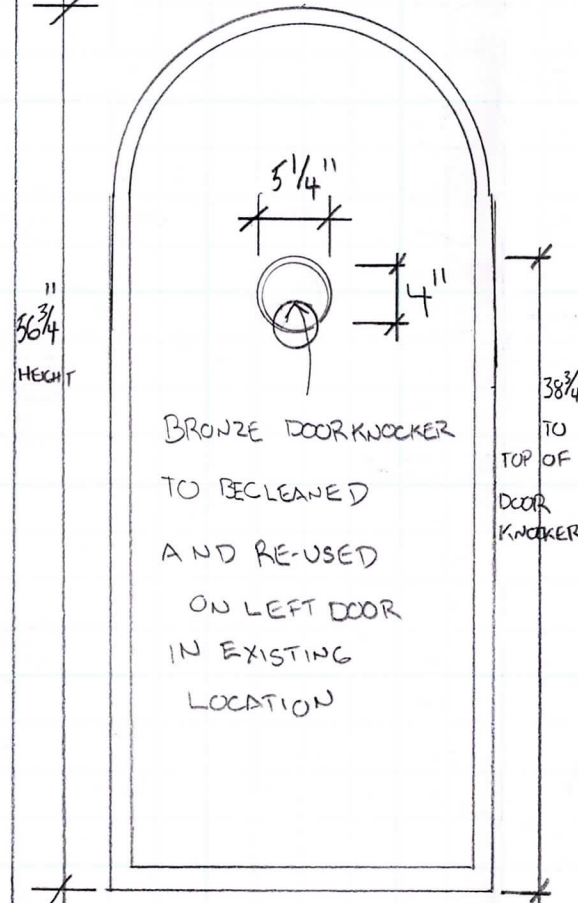

BRONZE DOOR KNOCKER
 TO BE CLEANED
 AND RE-USED
 ON LEFT DOOR
 IN EXISTING
 LOCATION

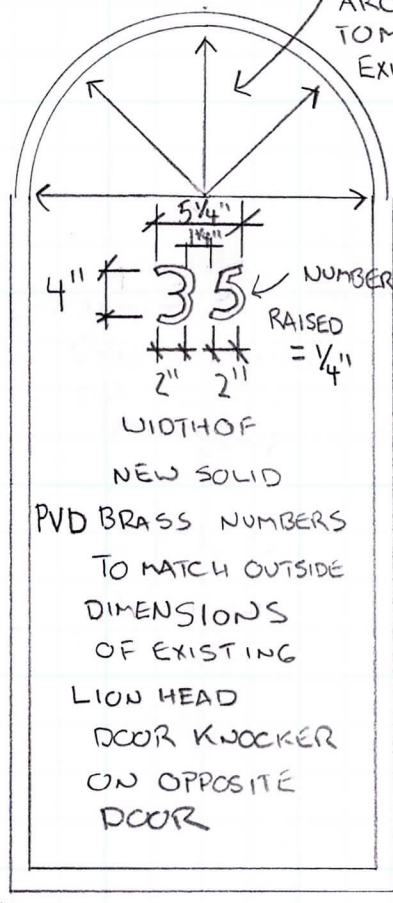

TEMPLATED
 ARCH
 TO MATCH
 EXISTING

4" 3 5" NUMBERS
 RAISED = 1/4"

WIDTH OF
 NEW SOLID
 PVD BRASS NUMBERS
 TO MATCH OUTSIDE
 DIMENSIONS
 OF EXISTING

LION HEAD
 DOOR KNOCKER
 ON OPPOSITE
 DOOR

4 SOLID BRASS
 HINGES / 2 PER DOOR
 AT INTERIOR, NOT VISIBLE
 AT EXTERIOR; 3 1/2" x 3 1/2"
 (KNUCKLES AT INTERIOR) HINGES

NEW 1 3/4" DEPTH MAHOGANY
 DOORS, POCKET MORTISE & TENON
 CONSTRUCTED WITH INSET ARCHED
 PANELS TO MATCH EXISTING,
 PAINTED 3 COATS TRI-CORN
 BLACK TO MATCH "SWING IN"
 AS EXISTS, IN EXISTING
 FRAME

EXISTING FRAME / DOOR JAMB
 TO REMAIN

MAHOGANY RAISED
 PANELS TO MATCH
 EXISTING MEASUREMENTS
 & SPECS

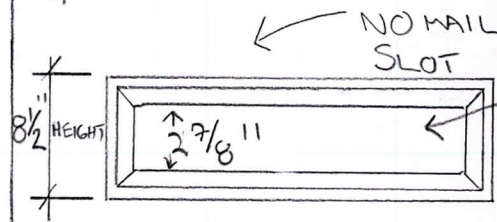

NO MAIL
 SLOT

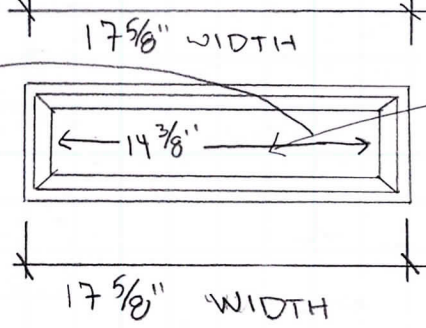

17 5/8" WIDTH

17 5/8" WIDTH

EXISTING WOOD WORK TO
 REMAIN

2 FLUSH BOLTS ON SIDE OF
 LEFT DOOR, VISIBLE FROM
 INTERIOR ONLY

GRANITE STEPS TO REMAIN

#35 MOUNT VERNON STREET
 BOSTON, M.A. 02108

#35 MOUNT VERNON STREET
 CONDO ASSN.

FRONT VIEW

SHEET NO. 1 OF 3



HISTORIC WINDOW AND DOOR CORPORATION



2" WIDTH

4"
IN
HEIGHT



2" WIDTH

1/4"
RAISED

4"
IN HEIGHT
SOLID BRASS
UNLACQUERED
TO TARNISH

Alstead Business Park
P.O. Box 138
Junction 123 & 123A
Alstead, NH 03602-0138
Tel. (603) 835-2918, 2153
Fax (603) 835-2464

1 1/4"
GAP BETWEEN
NUMBERS

5 1/4" TOTAL



DANGER
FALLING
ICE AND
SNOW





MORTON

Decorative metal pull with a central keyhole and ornate patterns.





