

View of existing deck and proposed extension

130 St Botolph Street

January 26, 2019

Christopher Taylor, RA
6 Cerina Road, Jamaica Plain, MA 02130



View from alley

Christopher Taylor, RA
6 Cerina Road, Jamaica Plain, MA 02130

130 St Botolph Street

January 26, 2019

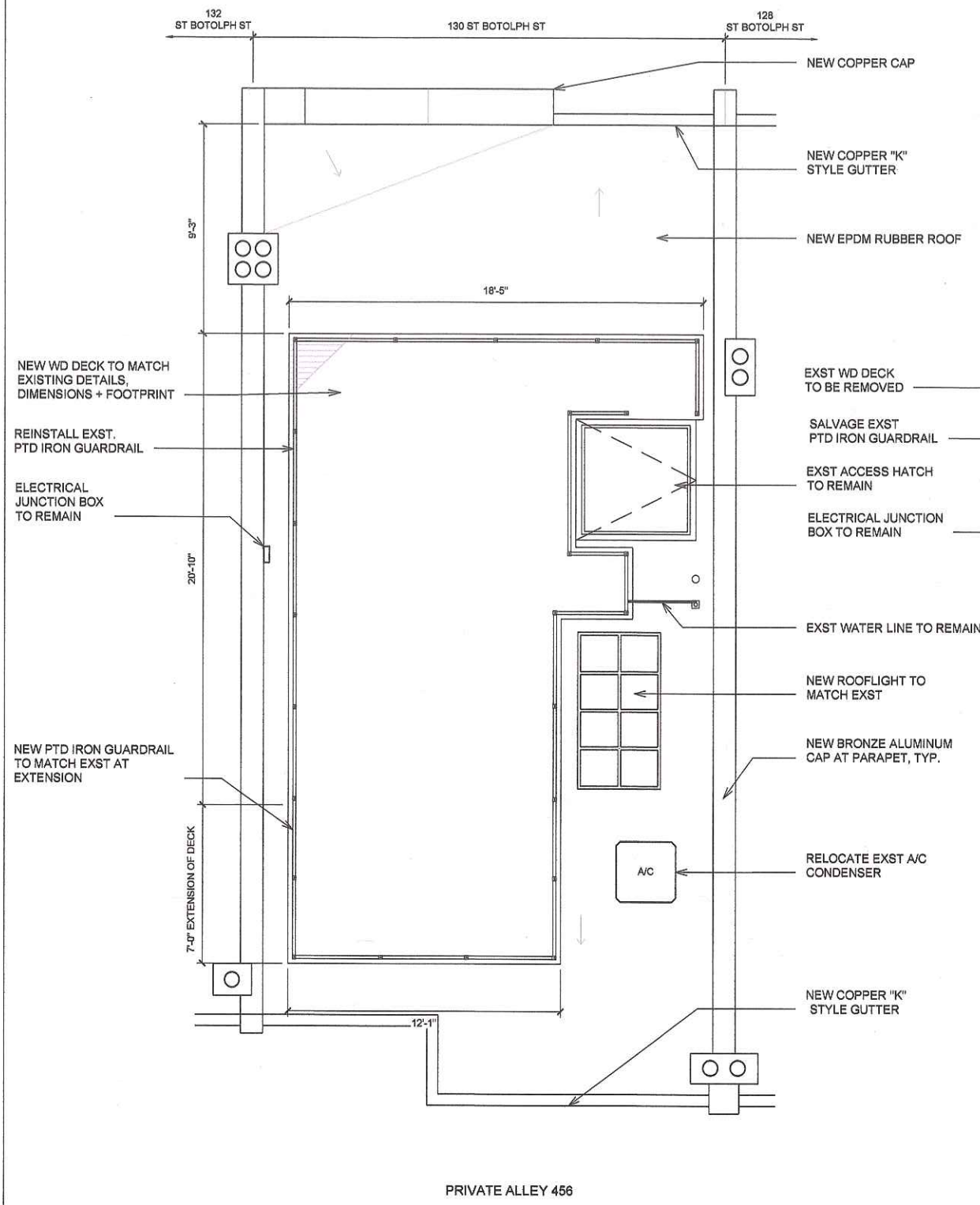

2 PROPOSED ROOF PLAN
1/4" = 1'-0"

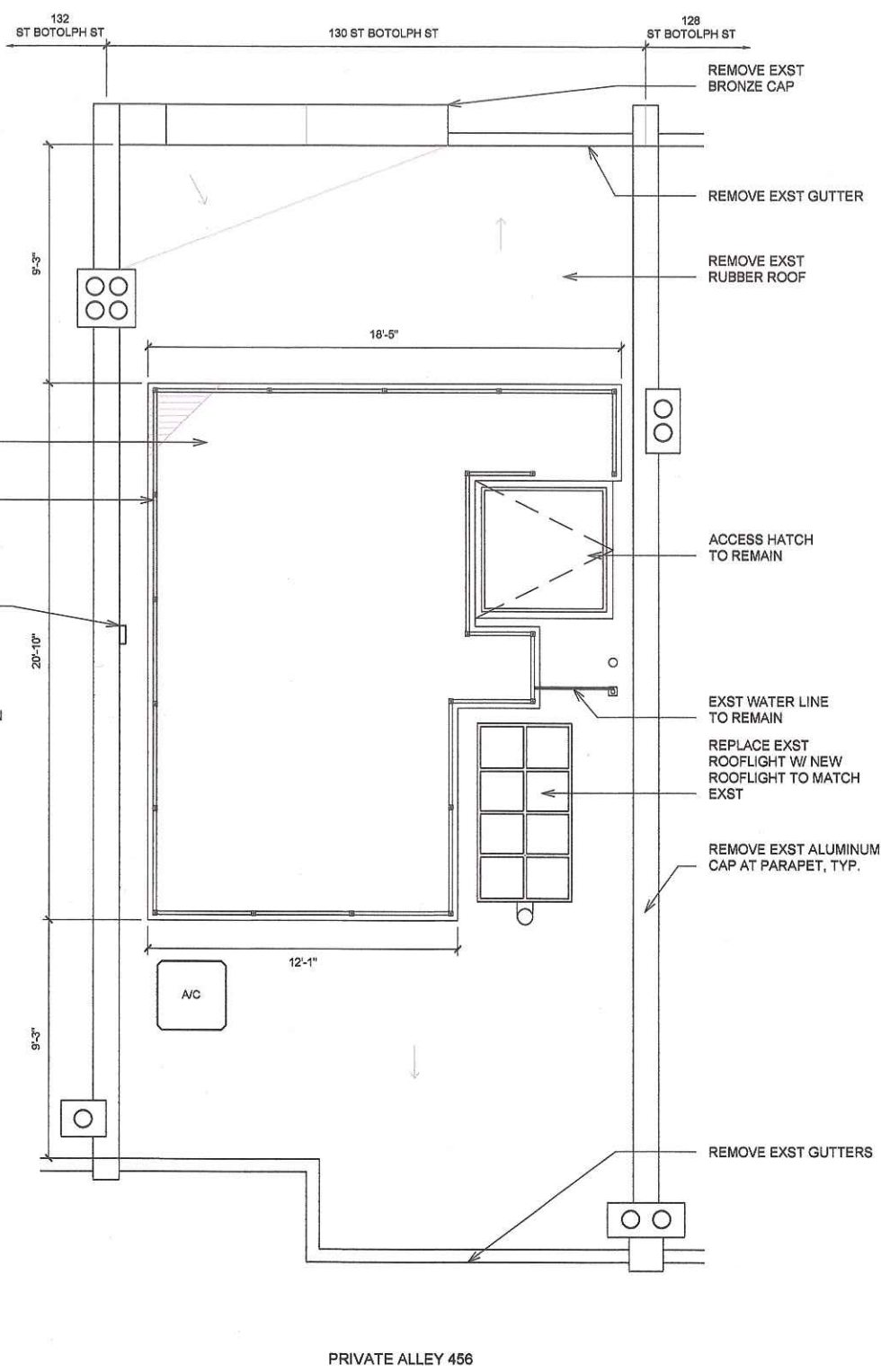

1 EXISTING ROOF PLAN
1/4" = 1'-0"

130 ST BOTOLPH
BOSTON, MA 02122

ARCHITECT:
CHRISTOPHER TAYLOR, RA
6 CERINA ROAD
JAMAICA PLAIN, MA 02130
617.335.6191

STRUCTURAL ENGINEER:

CODE CONSULTANT:

GENERAL CONTRACTOR:

ROOF PLANS

SCALE:
1/4" = 1'-0"

DATE:
JANUARY 26, 2019

A1.1