



MORRIS
NATHANSON
DESIGN
□□□□□□
163 Exchange Street
Pawtucket, RI 02860
Tel: (401) 723-3800
Fax: (401) 723-3813

THIS DRAWING IS A PART OF AN ARCHITECTURAL OR CONSTRUCTION CONTRACT OCCURRING HERE TO ALL DRAWINGS AND SPECIFICATIONS INCLUDING BUT NOT LIMITED TO GENERAL CONDITIONS SUMMARY OF WORK AND ANY APPLICABLE MANUFACTURER'S TECHNICAL SPECIFICATIONS.
REFER TO ALL OF THE DRAWINGS FOR COMPLETE SCOPE OF WORK.
THIS DRAWING IS NOT TO BE SCALED AND IS USED AS AN AS-BUILT.
THESE DRAWINGS AND SPECIFICATIONS ARE THE PROPERTY AND COPYRIGHT OF MORRIS NATHANSON DESIGN INC. AND SHALL NOT BE REPRODUCED OR IN PART, AND SHALL BE ASCRIBED TO MORRIS NATHANSON DESIGN INC. WITHOUT THE EXPRESS WRITTEN PERMISSION OF MORRIS NATHANSON DESIGN INC.
CONTRACTOR TO VERIFY ALL INFORMATION & DIMENSIONS IN FIELD PRIOR TO START OF CONSTRUCTION AND SHALL NOTIFY MORRIS NATHANSON DESIGN INC. OF ANY DISCREPANCIES.

CONSULTANTS:

PROJECT:
**BURRO BAR
1357 WASHINGTON ST
BOSTON, MA**

REVISIONS		
No.	DESCRIPTION	DATE

DRAWING TITLE:
TITLE

DESIGN BY: J	INCHES: 3/4"=1'-0"
CHECK BY: J	SCALE: AS NOTED
DRAWN BY: J	DATE: 0-2-00

**EXT
COVER**

BURRO BAR



**1357 WASHINGTON ST
BOSTON, MA**



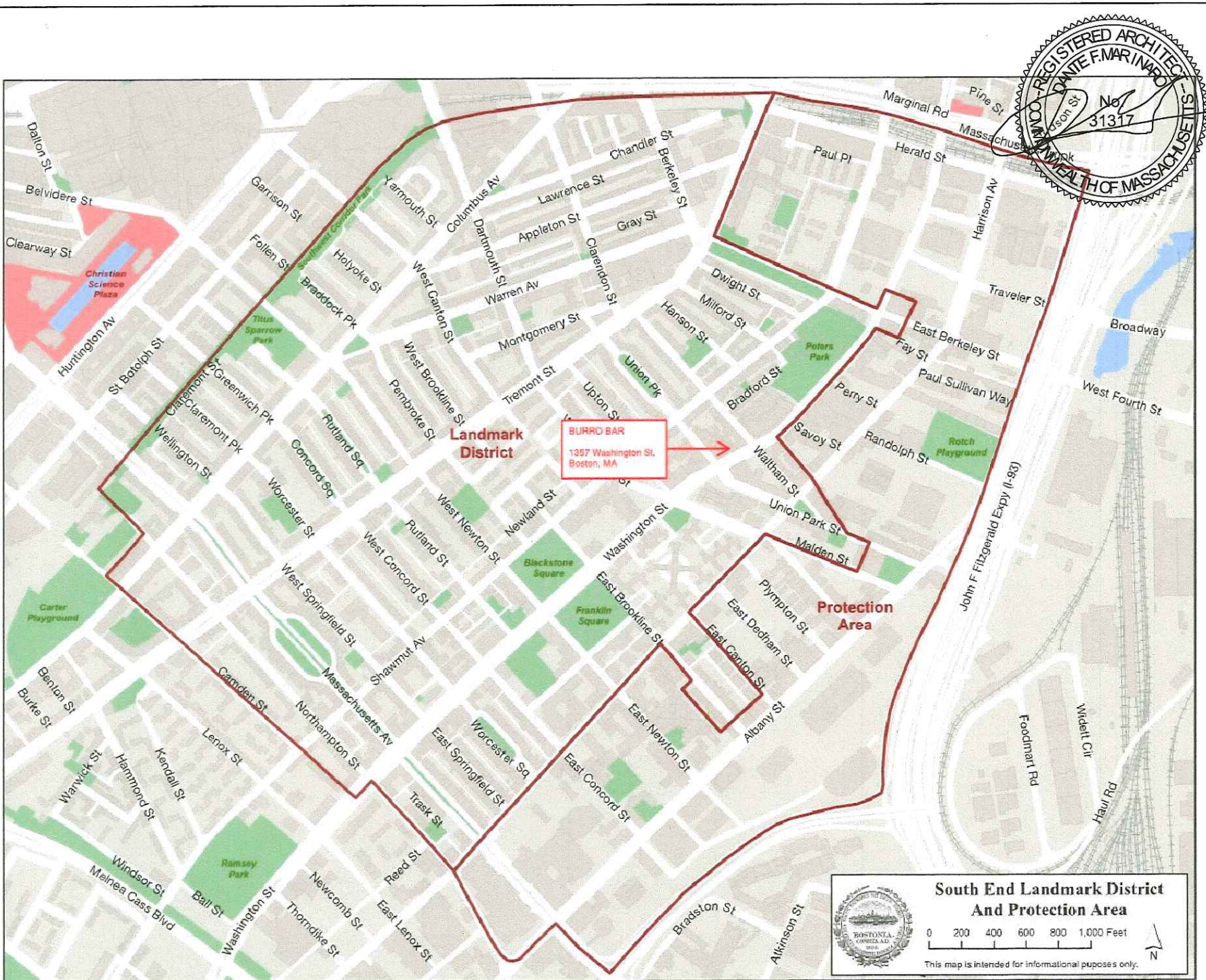

MND
MORRIS NATHANSON DESIGN
 163 Exchange Street
 Pawtucket, RI 02860
 Tel: (401) 723-3800
 Fax: (401) 723-3813

THIS DRAWING IS A PART OF AN INTEGRATED SET OF CONSTRUCTION CONTRACT DOCUMENTS. IT IS TO BE USED IN CONJUNCTION WITH ALL OTHER DOCUMENTS INCLUDING BUT NOT LIMITED TO GENERAL CONDITIONS, SUMMARY OF WORK, AND ANY APPROPRIATE TECHNICAL SPECIFICATIONS. THESE DRAWINGS AND SPECIFICATIONS ARE THE PROPERTY AND COPYRIGHT OF MORRIS NATHANSON DESIGN INC. AND SHALL NOT BE REPRODUCED OR IN ANY MANNER, WITHOUT THE WRITTEN PERMISSION OF MORRIS NATHANSON DESIGN INC.

CONTRACTOR TO VERIFY ALL INFORMATION & DIMENSIONS IN FIELD PRIOR TO START OF CONSTRUCTION AND SHALL NOTIFY MORRIS NATHANSON DESIGN INC. OF ANY DISCREPANCIES.

CONSULTANTS:

PROJECT:
**BURRO BAR
 1357 WASHINGTON ST
 BOSTON, MA**

REVISIONS		
No.	DESCRIPTION	DATE

DRAWING TITLE:
SOUTH END LANDMARK DISTRICT MAP

DESIGN BY: JD	PROJECT: 2071-M
CHECKED BY: JD	SCALE: AS NOTED
DRAWN BY: JD	DATE: 0-0-0

**South End Landmark District
 And Protection Area**

This map is intended for informational purposes only.



**MORRIS
NATHANSON
DESIGN**
 □□□□□□
 163 Exchange Street
 Pawtucket, RI 02860
 Tel: (401) 723-3800
 Fax: (401) 723-3813

THIS DRAWING IS A PART OF AN INTEGRATED SET OF CONSTRUCTION CONTRACT DOCUMENTS. REFER TO ALL DRAWINGS AND SPECIFICATIONS INCLUDING BUT NOT LIMITED TO GENERAL CONDITIONS, SUMMARY OF WORK AND ANY APPLICABLE MANUFACTURER'S TECHNICAL SPECIFICATIONS.

REFER TO ALL OF THE DRAWINGS FOR COMPLETE SCOPE OF WORK.
 THIS DRAWING IS NOT TO BE SCALED AND/OR USED AS AN AS-BUILT.

THESE DRAWINGS AND SPECIFICATIONS ARE THE PROPERTY AND COPYRIGHT OF MORRIS NATHANSON DESIGN INC. AND SHALL NOT BE USED IN WHOLE OR IN PART AND SHALL BE KEPT AS A "TRIED" PARTY WITHOUT THE EXPRESS WRITTEN PERMISSION OF MORRIS NATHANSON DESIGN INC.

CONTRACTOR TO VERIFY ALL INFORMATION & DIMENSIONS IN FIELD PRIOR TO START OF CONSTRUCTION AND SHALL NOTIFY MORRIS NATHANSON DESIGN INC. OF ANY DISCREPANCIES.

CONSULTANTS:

PROJECT:

**BURRO BAR
 1357 WASHINGTON ST
 BOSTON, MA**

REVISIONS

No.	DESCRIPTION	DATE

DRAWING TITLE:

EXTERIOR RENDERING

<small>DESIGN BY:</small>	J	<small>PROJECT:</small>	2017-11
<small>CHECK BY:</small>	J	<small>SCALE:</small>	AS NOTED
<small>DRAWN BY:</small>	J	<small>DATE:</small>	6-28-18

**EXT
 3**

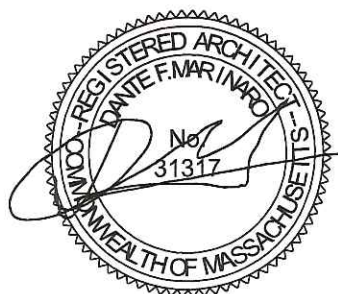

SPECIFICATION FEATURES

Construction

Housing is corrosion-resistant. Type 6063-T6 aluminum extrusion with die-cast aluminum end caps. End caps are secured by concealed stainless steel fasteners. Housing, end caps, and lens are sealed with single, closed cell silicone gaskets. Stainless steel hardware is standard. Reflector is constructed from 22 gauge cold rolled steel and pre-painted reflective white. A slightly diffused acrylic lens is standard, constructed of impact-resistant, U.V. stabilized virgin acrylic to prevent discoloration.

Electrical

LED fixtures use >0.9 power factor UL 1310 Class 2 AC to DC driver with

built-in dimming. Integral LED light engines are easily replaceable in the field. Offered in 80+ CRI for 3000K, 3500K, 4000K CCT.

Mounting

Fixture includes Slide-N-Mount™ adjustable, lockable, mounting arms constructed from Type 383 die-cast aluminum. Support structure by others.

Finish

Fixture housing is coated using electro-statically charged polyester powder coat paint for superior protection against fade and wear. Standard colors include white, silver, black, and bronze. Consult factory for custom colors.

Aiming

Fixture includes the PointGrab2™ lockable aiming system, providing minimum 180 degree vertical adjustment of the fixture housing in 5 degree increments. The aiming feature locks securely in place by means of a stainless steel locking mechanism.

Compliance

UL / cUL listed for use in damp locations.

Environment

Suited for indoor locations only.



ARROWLINEAR

LED

Cantilever Mount
Asymmetric Indirect

Individual Linear

CERTIFICATION DATA
UL/cUL Dry Location Listing
LM79 Compliant

ENERGY DATA
>0.9 Power Factor
120V – 277V 50/60 Hz
25°C Ambient Temperature

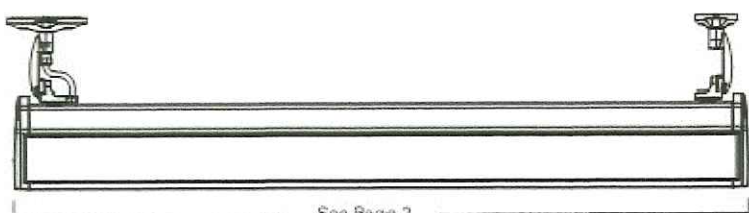
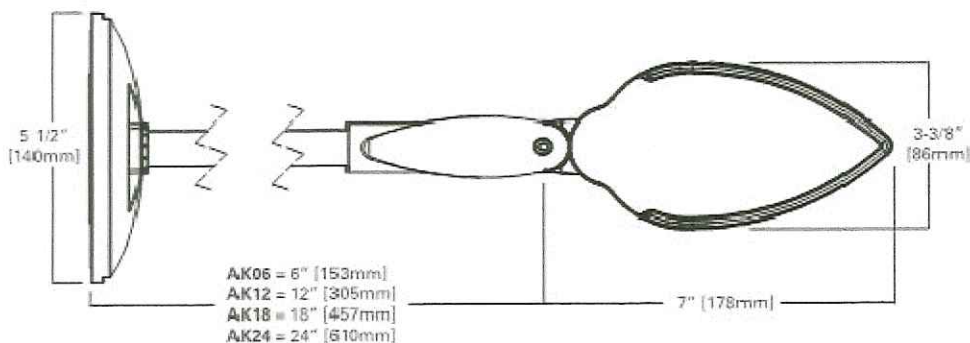

Refer to installation instructions for mounting details

See Page 2

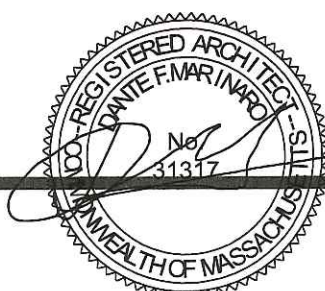

MORRIS NATHANSON DESIGN
163 Exchange Street
Pawtucket, RI 02860
Tel: (401) 723-3800
Fax: (401) 723-3813

THIS DRAWING IS A PART OF AN AGREEMENT OF CONSULTING CONTRACT DOCUMENTS. IT IS THE PROPERTY AND COPYRIGHT OF MORRIS NATHANSON DESIGN INC. AND SHALL NOT BE USED IN WHOLE OR IN PART FOR ANY OTHER PROJECT WITHOUT THE WRITTEN PERMISSION OF MORRIS NATHANSON DESIGN INC.

CONTRACTOR TO VERIFY ALL INFORMATION & DIMENSIONS IN FIELD PRIOR TO START OF CONSTRUCTION AND SHALL NOTIFY MORRIS NATHANSON DESIGN INC. OF ANY DISCREPANCIES.

THIS DRAWING AND SPECIFICATIONS ARE THE PROPERTY AND COPYRIGHT OF MORRIS NATHANSON DESIGN INC. AND SHALL NOT BE USED IN WHOLE OR IN PART FOR ANY OTHER PROJECT WITHOUT THE WRITTEN PERMISSION OF MORRIS NATHANSON DESIGN INC.

CONSULTANTS:

PROJECT:
BURRO BAR
1357 WASHINGTON ST
BOSTON, MA

REVISIONS		
No.	DESCRIPTION	DATE

DRAWING TITLE:
AIMING LIGHT

DESIGN BY: JB	SCALE: AS NOTED
CHECKED BY: JB	DATE: 04-08
DRAWN BY: JB	DATE: 04-08

EXT
4

EXTERIOR ELEVATION



Sunbrella fabric color: Black. 6" gold ptd copy. gold braid @ 8" hem (straight)

JOB:
BURRO BAR

LOCATION:
1357 WASHINGTON ST. BOSTON

FILE:
BURRO BAR BOSTON_FRONT ELEVATION_1918

DATE:
1918

PROJECT MANAGER:
KF

DESIGNED BY:
KRK

CLIENT APPROVAL

Date _____

NOTICE TO CLIENT

This drawing is a representation of how your signage will appear. By signing this drawing you are accepting the design as it is presented on this page.



221 Jefferson Boulevard ▲ Warwick, RI

v / 401.738.8055 f / 401.738.8244

www.aathriftysign.com

This design proposal is the property of AA Thrifty Sign & Awning. It is furnished with the expressed understanding that it will not be copied in any manner without written permission.

HALO LIT SIGN

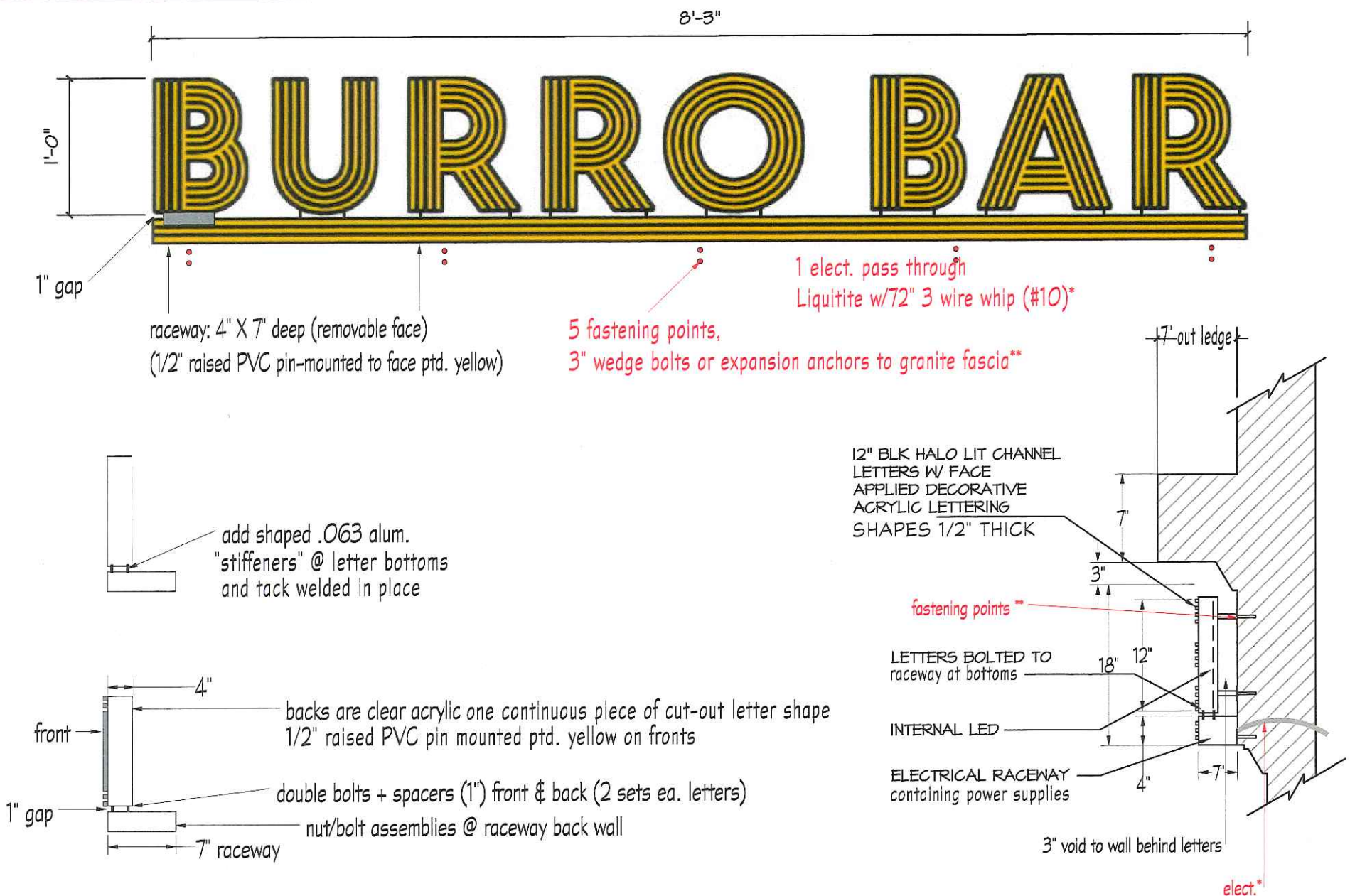

JOB:
BURRO BAR

LOCATION:
1357 WASHINGTON ST. BOSTON

FILE:
BURRO BAR BOSTON_RACEWAY_1 9 18

DATE:
1 9 18

PROJECT MANAGER:
KF

DESIGNED BY:
KRK

CLIENT APPROVAL

Date

NOTICE TO CLIENT
This drawing is a representation of how your signage will appear. By signing this drawing you are accepting the design as it is presented on this page.

AA Thrifty
sign & awning
SIGNING NEW ENGLAND SINCE 1934

221 Jefferson Boulevard & Warwick, RI
v / 401.738.8055 f / 401.738.8244
www.aathriftysign.com

This design proposal is the property of AA Thrifty Sign & Awning. It is furnished with the expressed understanding that it will not be copied in any manner without written permission.

BLADE SIGN



1/2" raised PVC @ perimeter + logo/letters
pinned + epoxied to 1 & 1/2" HD foam substrate

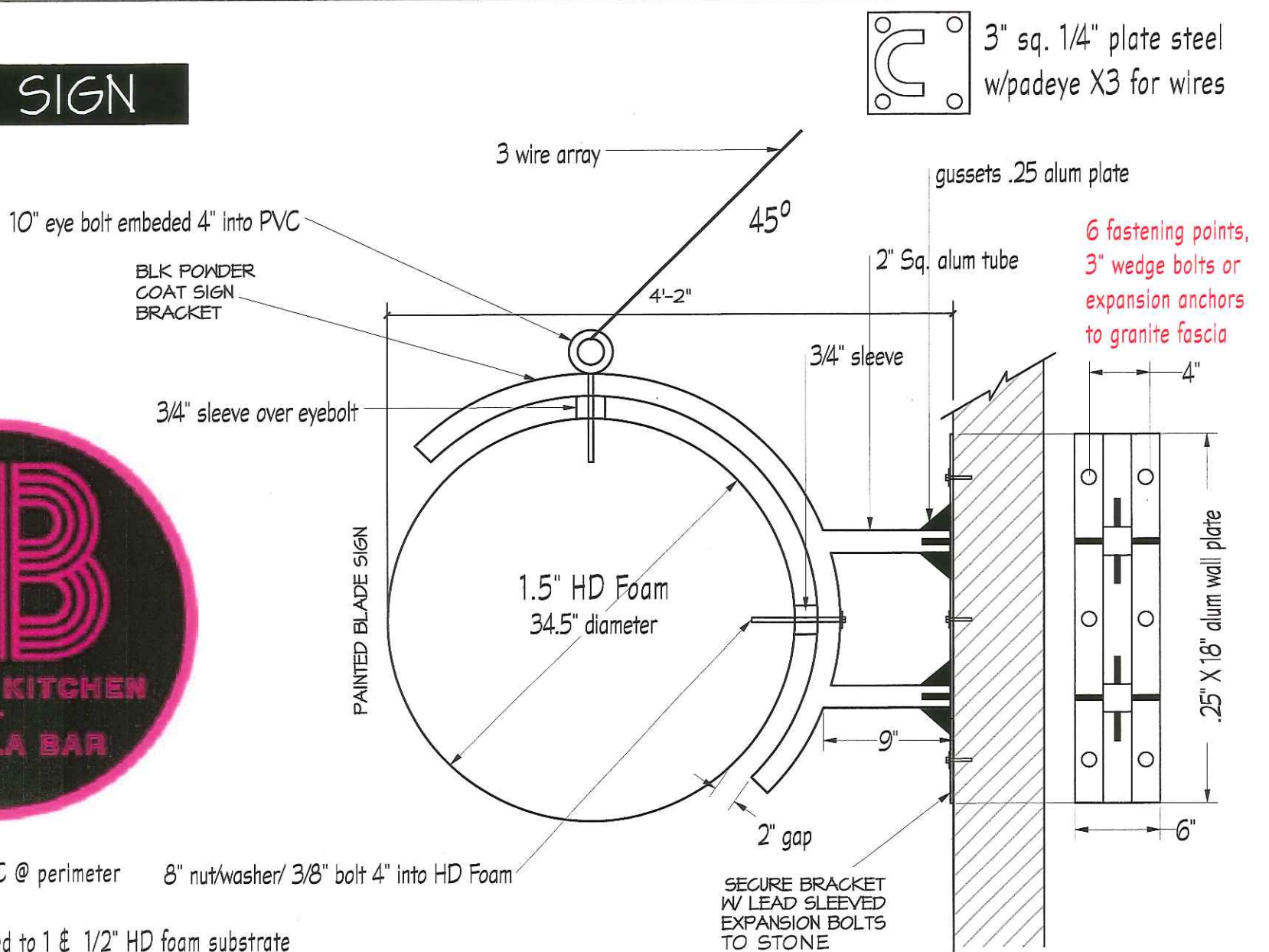

BURRO BAR

1357 WASHINGTON ST
BOSTON, MA



MORRIS
NATHANSON
DESIGN
163 Exchange Street
Pawtucket, RI 02860
Tel: (401) 723-3800
Fax: (401) 723-3813

THIS DRAWING IS A PART OF AN INTEGRATED SET OF
CONSTRUCTION CONTRACT DOCUMENTS REFER TO
ALL DRAWINGS AND SPECIFICATIONS INCLUDING BUT
NOT LIMITED TO GENERAL CONDITIONS SUMMARY
OF WORK AND ANY APPLICABLE MANUFACTURERS
TECHNICAL SPECIFICATIONS.

REFERS TO ALL OF THE DRAWINGS FOR COMPLETE
SCOPE OF WORK.

THIS DRAWING IS NOT TO BE SCALED AND/OR
USED AS AN ASSEMBLY.

THESE DRAWINGS AND SPECIFICATIONS ARE THE
PROPERTY AND COPYRIGHT OF MORRIS NATHANSON
DESIGN INC. AND SHALL NOT BE REPRODUCED OR
IN PART, NOR SHALL THEY BE ASSIGNED TO A THIRD
PARTY WITHOUT THE EXPRESS WRITTEN PERMISSION OF
MORRIS NATHANSON DESIGN INC.

CONTRACTOR TO VERIFY ALL INFORMATION &
DIMENSIONS IN FIELD PRIOR TO START OF
CONSTRUCTION AND SHALL NOTIFY MORRIS
NATHANSON DESIGN INC. OF ANY DISCREPANCIES.

CONSULTANTS:

PROJECT:

BURRO BAR
1357 WASHINGTON ST
BOSTON, MA

REVISIONS

No.	DESCRIPTION	DATE

DRAWING TITLE:

TITLE

DESIGN BY: JS FIELD: 207-PM
CHECK BY: JS SCALE: AS NOTED
DRAWN BY: JS DATE: 08-08

EXT
COVER

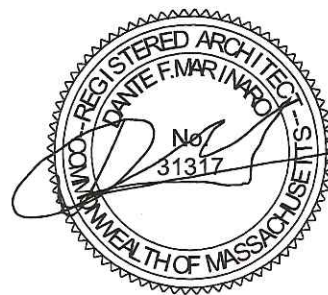

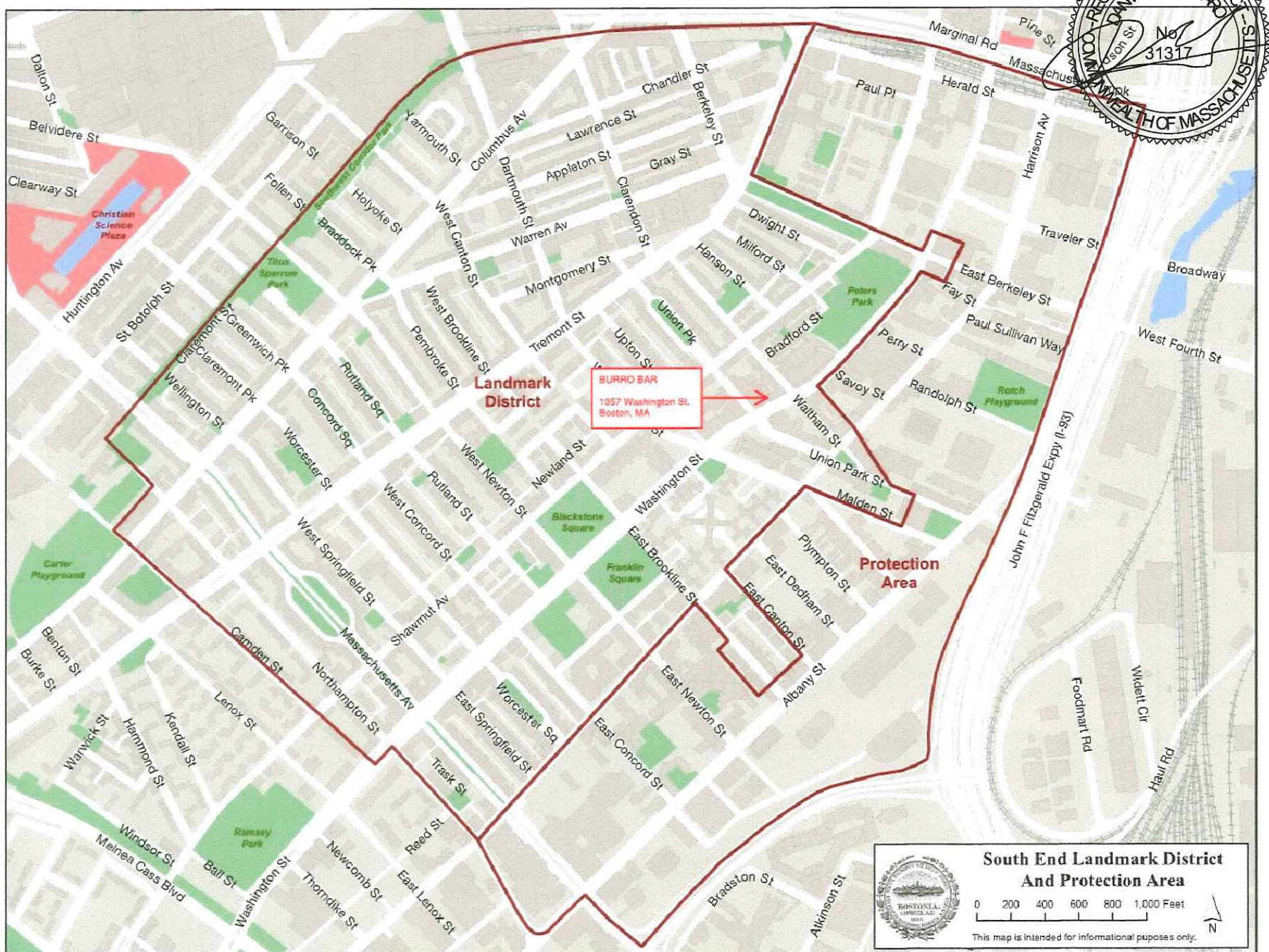

MORRIS NATHANSON DESIGN
 163 Exchange Street
 Pawtucket, RI 02860
 Tel: (401) 723-3800
 Fax: (401) 723-3813

THIS DRAWING IS A PART OF AN INSTRUMENT OF SERVICE FOR A CONTRACT FOR ARCHITECTURAL SERVICES. IT IS THE PROPERTY OF MORRIS NATHANSON DESIGN INC. AND SHALL NOT BE REPRODUCED, COPIED, OR TRANSMITTED IN ANY FORM OR BY ANY MEANS, ELECTRONIC OR MECHANICAL, INCLUDING PHOTOCOPYING, RECORDING, OR BY ANY INFORMATION STORAGE AND RETRIEVAL SYSTEM, WITHOUT THE EXPRESS WRITTEN PERMISSION OF MORRIS NATHANSON DESIGN INC.

CONSULTANTS:

PROJECT:
BURRO BAR
1357 WASHINGTON ST
BOSTON, MA

REVISIONS		
No.	DESCRIPTION	DATE

DRAWING TITLE:
SOUTH END LANDMARK DISTRICT MAP

DESIGNED BY: **JS** PROJECT: **2017-11**
 CHECKED BY: **JS** SCALE: **AS NOTED**
 DRAWN BY: **JS** DATE: **05-20-17**



EXISTING JUNCTION BOX TO POWER SIGN LIGHTS TO REMAIN. CONDUIT TO BE HIDDEN ALONG TOP OF GRANITE HEADER

NOTE:
EXISTING SIGN LIGHTS TO REMAIN - ANY NEEDED EXISTING CONDUIT TO BE RELOCATED AND HIDDEN ALONG THE TOP OF GRANITE HEADER

ANY REMAINING JUNCTION BOXES & EXPOSED CONDUIT TO BE PAINTED TO MATCH BRICK COLOR AS BEST AS POSSIBLE



REMOVE EXISTING GOOSENECK LIGHTS & ASSOCIATED CONDUIT

NOTE:
HOLES IN BRICK TO BE FILLED WITH COLORED LIQUID CEMENT - COLOR MATCHED TO THE ADJACENT SURFACE



MORRIS
NATHANSON
DESIGN
163 Exchange Street
Providence, RI 02860
Tel: (401) 723-3800
Fax: (401) 723-3813

THIS DRAWING IS A PART OF AN INTEGRATED SET OF CONSULTING CONTRACT DOCUMENTS. REFER TO ALL DRAWINGS AND SPECIFICATIONS INCLUDING BUT NOT LIMITED TO GENERAL CONDITIONS, SUMMARY OF WORK, AND ANY APPLICABLE MANUFACTURER'S TECHNICAL SPECIFICATIONS.

REFER TO ALL OF THE DRAWINGS FOR COMPLETE SCOPE OF WORK.

THIS DRAWING IS NOT TO BE REPRODUCED OR USED AS AN AS-BUILT.

THESE DRAWINGS AND SPECIFICATIONS ARE THE PROPERTY AND COPYRIGHT OF MORRIS NATHANSON DESIGN INC. AND SHALL NOT BE REPRODUCED OR IN ANY MANNER SHALL NOT BE ASSIGNED TO A THIRD PARTY WITHOUT THE EXPRESS WRITTEN PERMISSION OF MORRIS NATHANSON DESIGN INC.

CONTRACTOR TO VERIFY ALL INFORMATION & DIMENSIONS IN FIELD PRIOR TO START OF CONSTRUCTION AND SHALL NOTIFY MORRIS NATHANSON DESIGN INC. OF ANY DISCREPANCIES.

CONSULTANTS:

PROJECT:

BURRO BAR
1357 WASHINGTON ST
BOSTON, MA

REVISIONS

No.	DESCRIPTION	DATE

DRAWING TITLE:

EXISTING PHOTOS

DESIGN BY: JS INCHES: 2017-M
CHECK BY: JS SCALE: AS NOTED
DRAWN BY: JS DATE: 05-08

EXT
2





**MORRIS
NATHANSON
DESIGN**
 163 Exchange Street
 Pawtucket, RI 02860
 Tel: (401) 723-3800
 Fax: (401) 723-3813

THIS DRAWING IS A PART OF AN INTEGRATED SET OF DOCUMENTS. CONTRACT DOCUMENTS, SPECIFICATIONS, AND SCHEDULES SHALL BE REFERRED TO FOR ALL DETAILS AND CONDITIONS. CONTRACT DOCUMENTS SHALL BE REFERRED TO FOR ALL APPLICABLE MANUFACTURE TECHNICAL SPECIFICATIONS.

REFER TO ALL OF THE DRAWINGS FOR COMPLETE SCOPE OF WORK.

THIS DRAWING IS NOT TO BE SCALED AND/OR USED AS AN AS-BUILT.

THESE DRAWINGS AND SPECIFICATIONS ARE THE PROPERTY AND COPYRIGHT OF MORRIS NATHANSON DESIGN INC. AND SHALL NOT BE REPRODUCED OR IN ANY MANNER BE LOANED, COPIED, OR USED BY ANY PARTY WITHOUT THE EXPRESS WRITTEN PERMISSION OF MORRIS NATHANSON DESIGN INC.

CONTRACTOR TO VERIFY ALL INFORMATION & DIMENSIONS IN FIELD PRIOR TO START OF CONSTRUCTION AND SHALL NOTIFY MORRIS NATHANSON DESIGN INC. OF ANY DISCREPANCIES.

CONSULTANTS:

PROJECT:
BURRO BAR
1357 WASHINGTON ST
BOSTON, MA

REVISIONS

No.	DESCRIPTION	DATE

DRAWING TITLE:
EXTERIOR RENDERING

<small>DESIGN BY:</small> J	<small>PROJECT:</small> 207-11
<small>CHECK BY:</small> J	<small>SCALE:</small> AS NOTED
<small>DRAWN BY:</small> J	<small>DATE:</small> 05-08

EXT
3

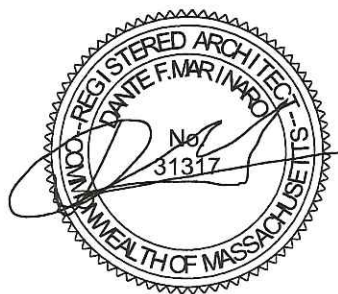

SPECIFICATION FEATURES

Construction

Housing is corrosion-resistant. Type 6063-T6 aluminum extrusion with die-cast aluminum end caps. End caps are secured by concealed stainless steel fasteners. Housing, end caps, and lens are sealed with single, closed cell silicone gaskets. Stainless steel hardware is standard. Reflector is constructed from 22 gauge cold rolled steel and pre-painted reflective white. A slightly diffused acrylic lens is standard, constructed of impact-resistant, U.V. stabilized virgin acrylic to prevent discoloration.

Electrical

LED fixtures use >0.9 power factor UL 1310 Class 2 AC to DC driver with

built-in dimming. Integral LED light engines are easily replaceable in the field. Offered in 80+ CRI for 3000K, 3500K, 4000K CCT.

Mounting

Fixture includes Slide-N-Mount™ adjustable, lockable, mounting arms constructed from Type 383 die-cast aluminum. Support structure by others.

Finish

Fixture housing is coated using electro-statically charged polyester powder coat paint for superior protection against fade and wear. Standard colors include white, silver, black, and bronze. Consult factory for custom colors.

Aiming

Fixture includes the PointGrab2™ lockable aiming system, providing minimum 180 degree vertical adjustment of the fixture housing in 5 degree increments. The aiming feature locks securely in place by means of a stainless steel locking mechanism.

Compliance

UL / cUL listed for use in damp locations.

Environment

Suited for indoor locations only.

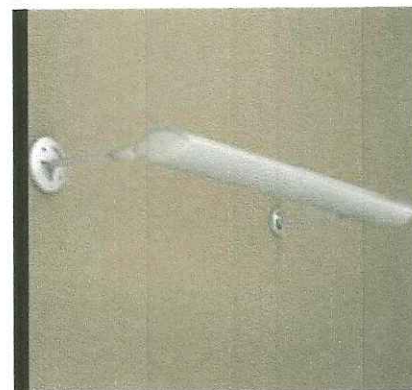

ARROWLINEAR

LED

Cantilever Mount
Asymmetric Indirect

Individual Linear

CERTIFICATION DATA
UL/cUL Dry Location Listing
LM79 Compliant

ENERGY DATA
>0.9 Power Factor
120V - 277V 50/60 Hz
25°C Ambient Temperature

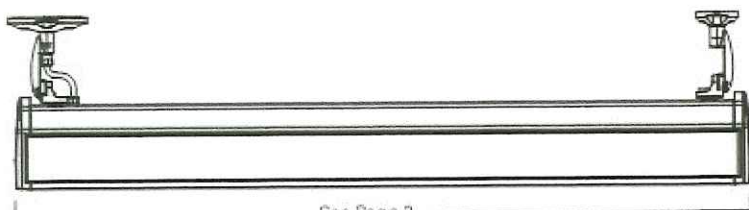
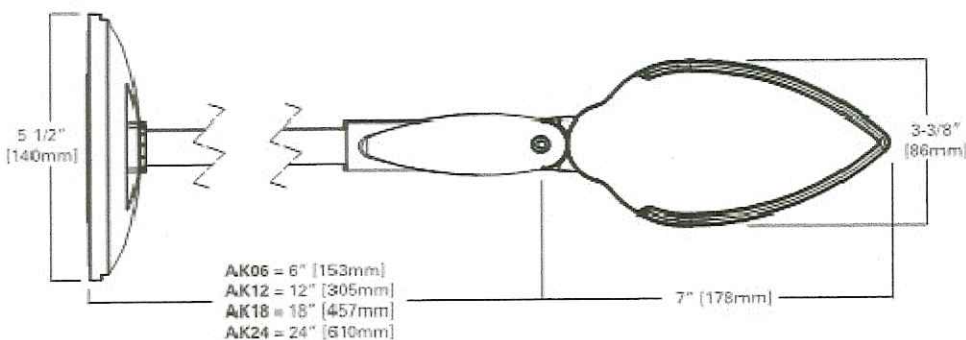

See Page 2

Refer to installation instructions for mounting details

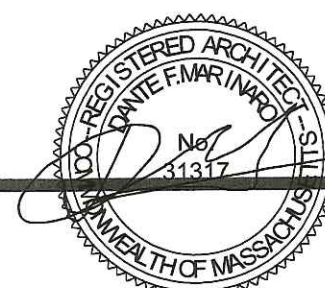

MORRIS NATHANSON DESIGN
163 Exchange Street
Pawtucket, RI 02860
Tel: (401) 723-3800
Fax: (401) 723-3813

THIS DRAWING IS A PART OF AN INTEGRATED SET OF CONSTRUCTION CONTRACT DOCUMENTS. REFER TO ALL DRAWINGS AND SPECIFICATIONS INCLUDING BUT NOT LIMITED TO GENERAL CONDITIONS, SUMMARY OF WORK, AND ANY APPLICABLE MANUFACTURER'S TECHNICAL SPECIFICATIONS.
REFER TO ALL OF THE DRAWINGS FOR COMPLETE SCOPE OF WORK.
THIS DRAWING IS NOT TO BE SCALE AND/OR USED AS AN ASSEMBLY.
THESE DRAWINGS AND SPECIFICATIONS ARE THE PROPERTY AND COPYRIGHT OF MORRIS NATHANSON DESIGN, INC. AND SHALL NOT BE USED FOR ANY OTHER PROJECT WITHOUT THE EXPRESS WRITTEN PERMISSION OF MORRIS NATHANSON DESIGN, INC.
CONTRACTOR TO VERIFY ALL INFORMATION & DIMENSIONS IN FIELD PRIOR TO START OF CONSTRUCTION AND SHALL NOTIFY MORRIS NATHANSON DESIGN, INC. OF ANY DISCREPANCIES.

CONSULTANTS:

PROJECT:
BURRO BAR
1357 WASHINGTON ST
BOSTON, MA

REVISIONS		
No.	DESCRIPTION	DATE

DRAWING TITLE:

ARROW LIGHT

DESIGN BY: JB NO. 2017-11
CHECKED BY: JB SCALE: AS NOTED
DATE: 6-28-17

EXT
4

EXTERIOR ELEVATION

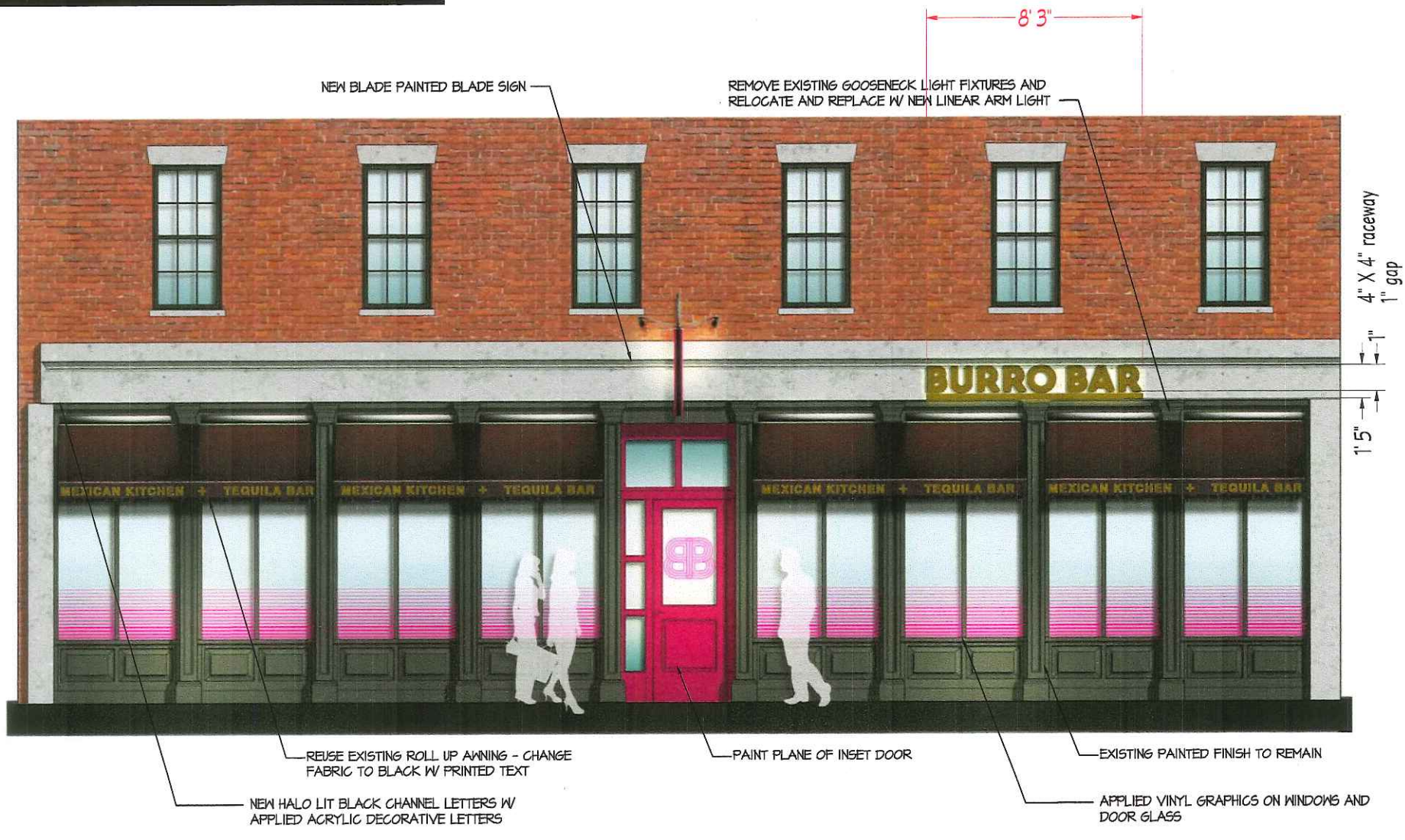

Sunbrella fabric color: Black. 6" gold ptd copy. gold braid @ 8" hem (straight)

JOB:
BURRO BAR
LOCATION:
1357 WASHINGTON ST. BOSTON

FILE:
BURRO BAR BOSTON_FRONT ELEVATION_1918
DATE:
1918

PROJECT MANAGER:
KF
DESIGNED BY:
KRK

CLIENT APPROVAL
Date _____
NOTICE TO CLIENT
This drawing is a representation of how your signage will appear. By signing this drawing you are accepting the design as it is presented on this page.



221 Jefferson Boulevard ▲ Warwick, RI
v / 401.738.8055 f / 401.738.8244
www.aathriftysign.com

HALO LIT SIGN

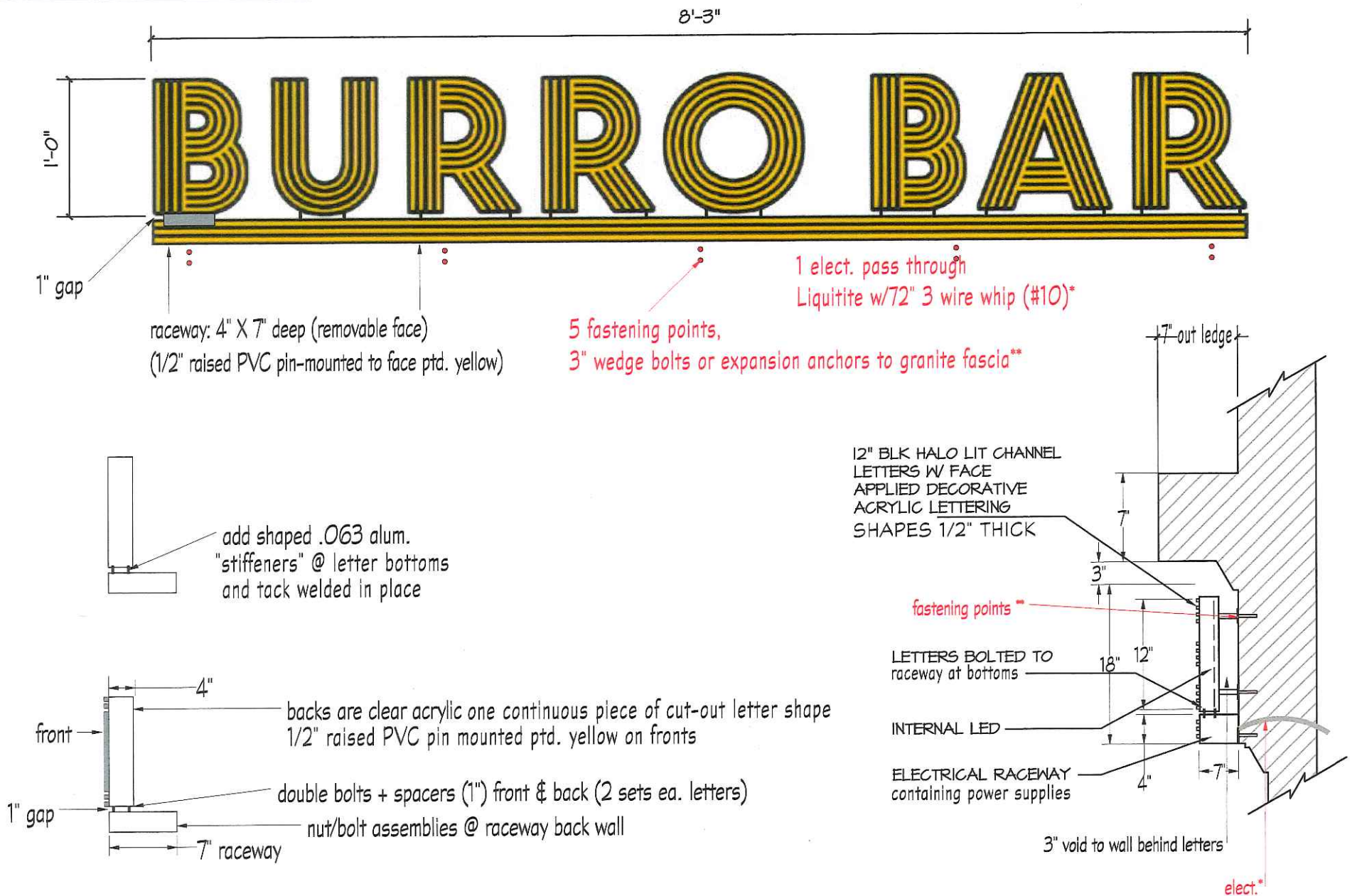

JOB:
BURRO BAR

LOCATION:
1357 WASHINGTON ST. BOSTON

FILE:
BURRO BAR BOSTON_RACEWAY_1 9 18

DATE:
1 9 18

PROJECT MANAGER:
KF

DESIGNED BY:
KRK

CLIENT APPROVAL

Date

NOTICE TO CLIENT

This drawing is a representation of how your signage will appear. By signing this drawing you are accepting the design as it is presented on this page.

AA Thrifty
sign & awning
SIGNING NEW ENGLAND SINCE 1944

221 Jefferson Boulevard & Warwick, RI
v / 401.738.8055 f / 401.738.8244

www.aathriftysign.com

This design proposal is the property of AA Thrifty Sign & Awning. It is furnished with the expressed understanding that it will not be copied in any manner without written permission.

BLADE SIGN

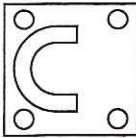

3" sq. 1/4" plate steel
w/padeye X3 for wires



1/2" raised PVC @ perimeter + logo/letters
pinned + epoxied to 1 & 1/2" HD foam substrate

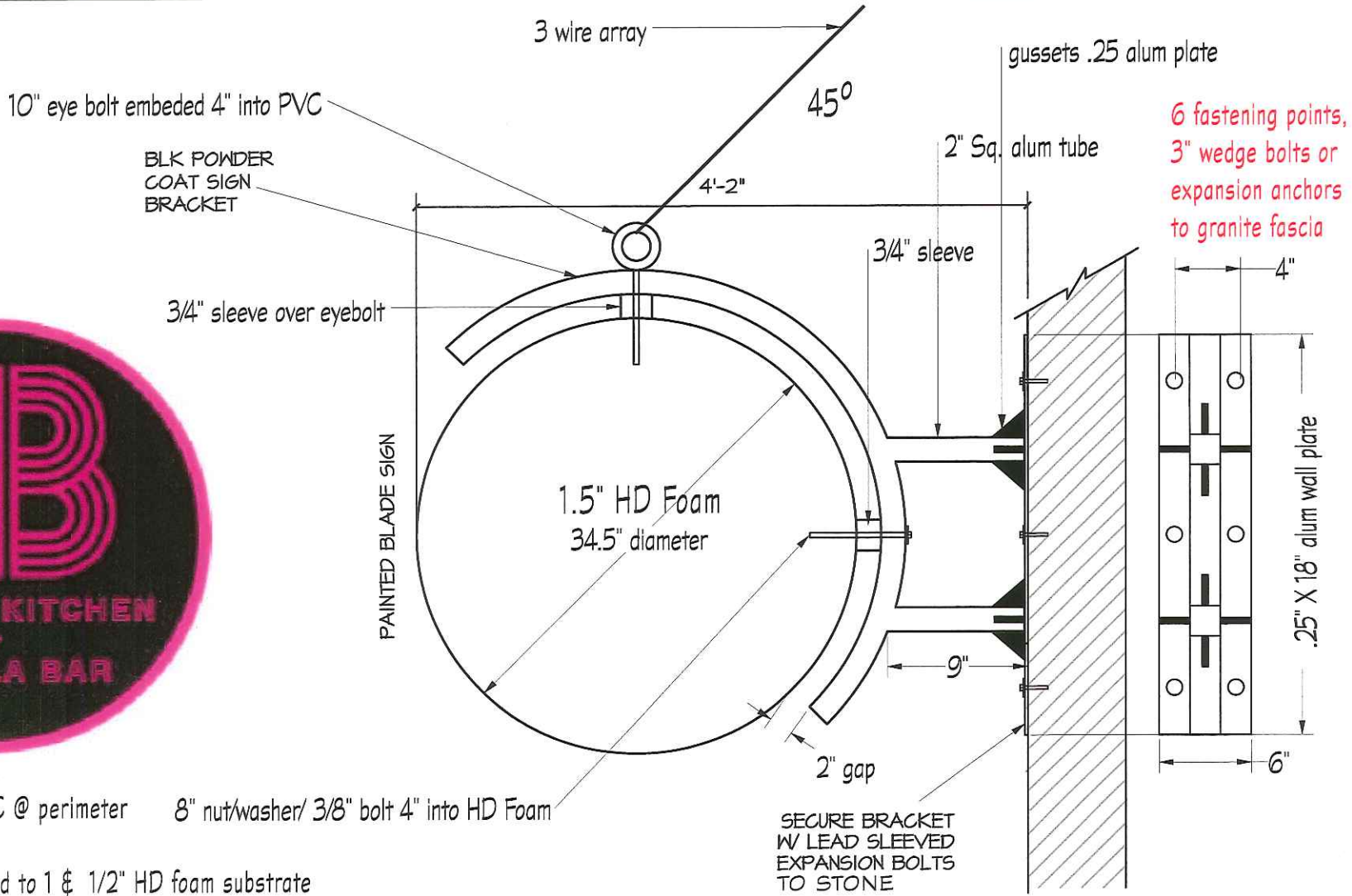



**MORRIS
NATHANSON
DESIGN**
 163 Exchange Street
 Pawtucket, RI 02860
 Tel: (401) 723-3800
 Fax: (401) 723-3813

THE DRAWINGS & SPECIFICATIONS HEREBY SET FORTH IN THIS CONTRACT DOCUMENTS REFER TO ALL DRAWINGS AND SPECIFICATIONS INCLUDING BUT NOT LIMITED TO "GENERAL CONDITIONS", "SUMMARY OF WORK", "SPECIFICATIONS", "MANUFACTURES", "TECHNICAL SPECIFICATIONS".
 REFER TO ALL OF THE DRAWINGS FOR COMPLETE SCOPE OF WORK.
 THIS DRAWING IS NOT TO BE SCALED AND/OR USED AS AN AS-BUILD.
 THESE DRAWINGS AND SPECIFICATIONS ARE THE PROPERTY AND COPYRIGHT OF MORRIS NATHANSON DESIGN INC. AND SHALL REMAIN THE PROPERTY OF THIS PARTY. NO WORK SHALL BE ASSIGNED TO A THIRD PARTY WITHOUT THE EXPRESS WRITTEN PERMISSION OF MORRIS NATHANSON DESIGN INC.
 CONTRACTOR TO VERIFY ALL INFORMATION & DIMENSIONS IN FIELD PRIOR TO START OF CONSTRUCTION AND SHALL NOTIFY MORRIS NATHANSON DESIGN INC. OF ANY DISCREPANCIES.

CONSULTANTS:

PROJECT:
**BURRO BAR
 1357 WASHINGTON
 BOSTON, MA 02118**

REVISIONS		
NO.	DESCRIPTION	DATE
1	FIELD REVIEW	12-08-11

DRAWING TITLE:

DISTRICT MAP & EXISTING PHOTOS

DESIGN BY: JB	PROJECT: 2011-H
CHECKED BY: JB	SCALE: AS NOTED
DRAWN BY: JB	DATE: 12-08-11

**EXT
COVER**

BURRO BAR



**1357 WASHINGTON ST
 BOSTON, MA**





MORRIS NATHANSON DESIGN

163 Exchange Street
Pawtucket, RI 02860
Tel: (401) 723-3800
Fax: (401) 723-3813

THIS DRAWING IS A PART OF AN INTEGRATED SET OF CONSTRUCTION CONTRACT DOCUMENTS. REFER TO ALL DRAWINGS AND SPECIFICATIONS INCLUDING BUT NOT LIMITED TO "GENERAL CONDITIONS," SUMMARY OF WORK, AND ANY APPLICABLE MANUFACTURERS TECHNICAL SPECIFICATIONS.

REFER TO ALL OF THE DRAWINGS FOR COMPLETE SCOPE OF WORK.

THIS DRAWING IS NOT TO BE SCALED AND/OR USED AS AN AS-BUILD.

THESE DRAWINGS AND SPECIFICATIONS ARE THE PROPERTY AND COPYRIGHT OF MORRIS NATHANSON DESIGN INC. AND SHALL NOT BE USED IN WHOLE OR IN PART, NOR SHALL THEY BE ASSIGNED TO A THIRD PARTY WITHOUT THE EXPRESS WRITTEN PERMISSION OF MORRIS NATHANSON DESIGN INC.

CONTRACTOR TO VERIFY ALL INFORMATION & DIMENSIONS IN FIELD PRIOR TO START OF CONSTRUCTION AND SHALL NOTIFY MORRIS NATHANSON DESIGN INC. OF ANY DISCREPANCIES.

CONSULTANTS:

PROJECT:

BURRO BAR
1357 WASHINGTON
BOSTON, MA 02118

REVISIONS

No.	DESCRIPTION	DATE
1	SELDG REVIEW	12-08-17

DRAWING TITLE:

EXTERIOR ELEVATION

DSGN. BY: JB	PROJ. #: 2017-14
CHK. BY: JB	SCALE: AS NOTED
DRWN. BY: JB	DATE: 12-08-17

EXT

2

NEW BLADE PAINTED BLADE SIGN

REMOVE EXISTING GOOSENECK LIGHT FIXTURES AND RELOCATE AND REPLACE W/ NEW LINEAR ARM LIGHT



BURRO BAR

MEXICAN KITCHEN + TEQUILA BAR

BB

1'-3 1/2"

1'-0"

8'-3"

REUSE EXISTING ROLL UP AWNING - CHANGE FABRIC TO BLACK W/ PRINTED TEXT

NEW HALO LIT BLACK CHANNEL LETTERS W/ APPLIED ACRYLIC DECORATIVE LETTERS

PAINT PLANE OF INSET DOOR

EXISTING PAINTED FINISH TO REMAIN

APPLIED VINYL GRAPHICS ON WINDOWS AND DOOR GLASS

1
EXT-2

EXTERIOR ELEVATION

SCALE: 1/4"=1'-0"



MORRIS
NATHANSON
DESIGN
□□□□□□
163 Exchange Street
Pawtucket, RI 02860
Tel: (401) 723-3800
Fax: (401) 723-3813

THIS DRAWING IS A PART OF AN INTEGRATED SET OF CONSTRUCTION CONTRACT DOCUMENTS. REFER TO ALL DRAWINGS AND SPECIFICATIONS INCLUDING BUT NOT LIMITED TO "GENERAL CONDITIONS," "SUMMARY OF WORK," AND ANY APPLICABLE MANUFACTURERS TECHNICAL SPECIFICATIONS.

REFER TO ALL OF THE DRAWINGS FOR COMPLETE SCOPE OF WORK.

THIS DRAWING IS NOT TO BE SCALED AND/OR USED AS AN AS-BUILD.

THESE DRAWINGS AND SPECIFICATIONS ARE THE PROPERTY AND COPYRIGHT OF MORRIS NATHANSON DESIGN INC. AND SHALL NOT BE USED IN WHOLE OR IN PART, NOR SHALL THEY BE ASSIGNED TO A THIRD PARTY WITHOUT THE EXPRESS WRITTEN PERMISSION OF MORRIS NATHANSON DESIGN INC.

CONTRACTOR TO VERIFY ALL INFORMATION & DIMENSIONS IN FIELD PRIOR TO START OF CONSTRUCTION AND SHALL NOTIFY MORRIS NATHANSON DESIGN INC. OF ANY DISCREPANCIES.

CONSULTANTS:

PROJECT:

BURRO BAR
1357 WASHINGTON
BOSTON, MA 02118

REVISIONS

No.	DESCRIPTION	DATE
1	SELDG REVIEW	12-08-11

DRAWING TITLE:

DISTRICT MAP & EXISTING PHOTOS

DSGN BY: JB PROJ#: 2011-14
CHK BY: JB SCALE: AS NOTED
DRWN BY: JB DATE: 12-08-11

EXT
1



12" BLK HALO LIT CHANNEL
LETTERS W/ FACE APPLIED
APPLIED DECORATIVE
ACRYLIC LETTERING

LETTERS BOLTED TO CONC.
HEADER W/ 2" STANDOFFS

INTERNAL LED

ELECTRICAL RACEWAY

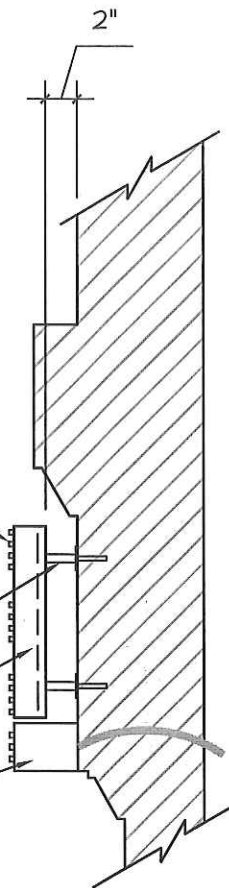

1 HALO LIT SIGN
EXT-3 SCALE: 1"=1'-0"



BLK POWDER COAT SIGN
BRACKET W/ INTEGRATED
BULLET SIGN LIGHT

PAINTED BLADE SIGN

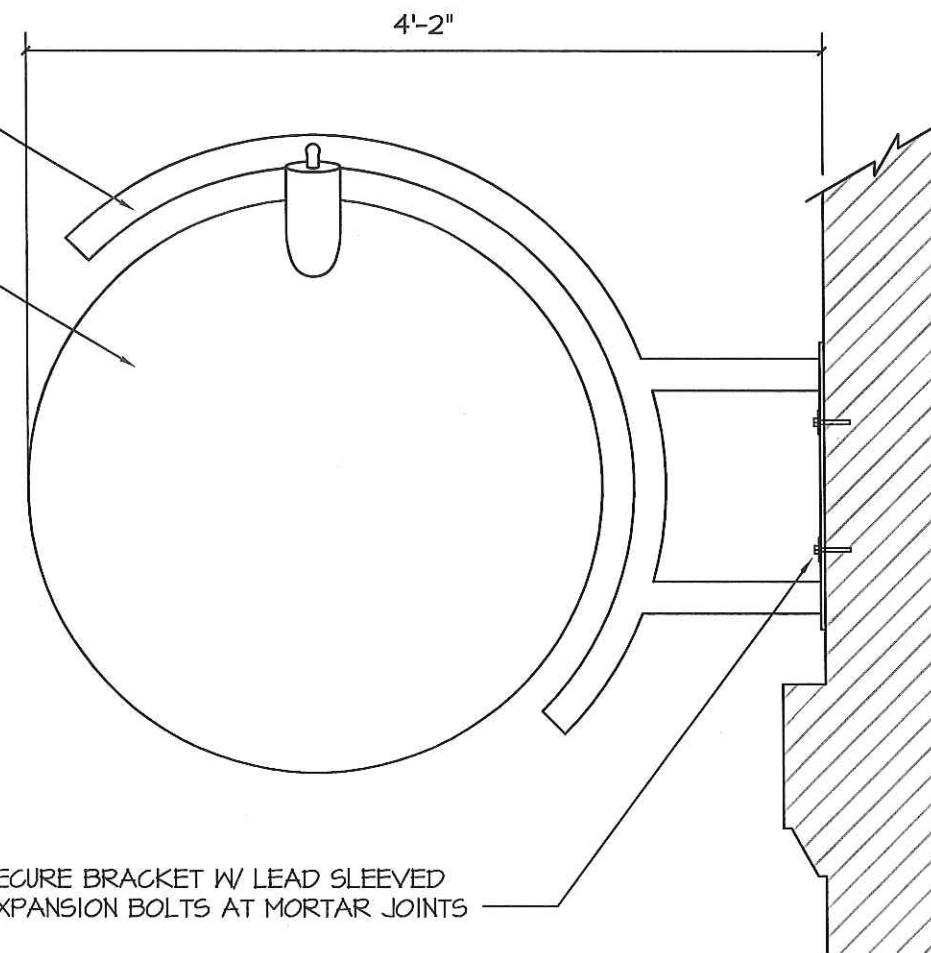

SECURE BRACKET W/ LEAD SLEEVED
EXPANSION BOLTS AT MORTAR JOINTS

2 BLADE SIGN
EXT-3 SCALE: 1"=1'-0"



MORRIS
NATHANSON
DESIGN
163 Exchange Street
Pawtucket, RI 02860
Tel: (401) 723-3800
Fax: (401) 723-3813

THIS DRAWING IS A PART OF AN INTEGRATED SET OF
CONSTRUCTION CONTRACT DOCUMENTS. REFER TO
ALL DRAWINGS AND SPECIFICATIONS INCLUDING BUT
NOT LIMITED TO "GENERAL CONDITIONS", SUMMARY
OF WORK, AND ANY APPLICABLE MANUFACTURERS
TECHNICAL SPECIFICATIONS.

REFER TO ALL OF THE DRAWINGS FOR COMPLETE
SCOPE OF WORK.

THIS DRAWING IS NOT TO BE SCALED AND/OR
USED AS AN AS-BUILD.

THESE DRAWINGS AND SPECIFICATIONS ARE THE
PROPERTY AND COPYRIGHT OF MORRIS NATHANSON
DESIGN INC. AND SHALL NOT BE USED IN WHOLE OR
IN PART, NOR SHALL THEY BE ASSIGNED TO A THIRD
PARTY WITHOUT THE EXPRESS WRITTEN PERMISSION OF
MORRIS NATHANSON DESIGN INC.

CONTRACTOR TO VERIFY ALL INFORMATION &
DIMENSIONS IN FIELD PRIOR TO START OF
CONSTRUCTION AND SHALL NOTIFY MORRIS
NATHANSON DESIGN INC. OF ANY DISCREPANCIES.

CONSULTANTS:

PROJECT:

BURRO BAR
1357 WASHINGTON
BOSTON, MA 02118

REVISIONS

No.	DESCRIPTION	DATE
1	SELDG REVIEW	12-08-17

DRAWING TITLE:

SIGNAGE DETAILS

DSGN. BY: JB	PROJ.#: 2017-M
CHK. BY: JB	SCALE: AS NOTED
DRWN. BY: JB	DATE: 12-08-17

EXT
3

SPECIFICATION FEATURES

Construction

Housing is corrosion-resistant. Type 6063-T6 aluminum extrusion with die-cast aluminum end caps. End caps are secured by concealed stainless steel fasteners. Housing, end caps, and lens are sealed with single, closed cell silicone gaskets. Stainless steel hardware is standard. Reflector is constructed from 22 gauge cold rolled steel and pre-painted reflective white. A slightly diffused acrylic lens is standard, constructed of impact-resistant, U.V. stabilized virgin acrylic to prevent discoloration.

Electrical

LED fixtures use >0.9 power factor
UL 1310 Class 2 AC to DC driver with

built-in dimming. Integral LED light engines are easily replaceable in the field. Offered in 80+ CRI for 3000K, 3500K, 4000K CCT.

Mounting

Fixture includes Slide-N-Mount™ adjustable, lockable, mounting arms constructed from Type 303 die-cast aluminum. Support structure by others.

Finish

Fixture housing is coated using electro-statically charged polyester powder coat paint for superior protection against fade and wear. Standard colors include white, silver, black, and bronze. Consult factory for custom colors.

Aiming

Fixture includes the PointGrab2™ lockable aiming system, providing minimum 180 degree vertical adjustment of the fixture housing in 5 degree increments. The aiming feature locks securely in place by means of a stainless steel locking mechanism.

Compliance

UL / cUL listed for use in damp locations.

Environment

Suited for indoor locations only.



ARROWLINEAR

LED

Cantilever Mount
Asymmetric Indirect

Individual Linear

CERTIFICATION DATA
UL/cUL Dry Location Listing
LM79 Compliant

ENERGY DATA
>0.9 Power Factor
120V - 277V 50/60 Hz
25°C Ambient Temperature

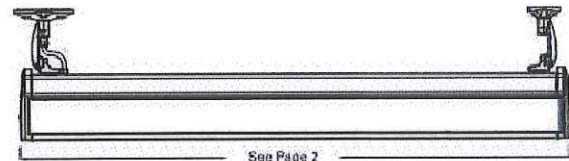
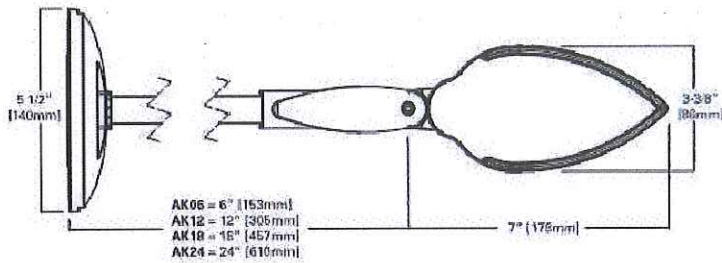

Refer to installation instructions for mounting details



SIGN BRACKET STORE
By Hooks & Lattice SignBracketStore.com

1
EXT-4

AWNING LIGHT

SCALE: N/A

2
EXT-4

SIGN LIGHT

SCALE: N/A



MORRIS NATHANSON DESIGN

163 Exchange Street
Pawtucket, RI 02860
Tel: (401) 723-3800
Fax: (401) 723-3813

THIS DRAWING IS A PART OF AN INTEGRATED SET OF CONSTRUCTION CONTRACT DOCUMENTS. REFER TO ALL DRAWINGS AND SPECIFICATIONS INCLUDING BUT NOT LIMITED TO "GENERAL CONDITIONS," SUMMARY OF WORK" AND ANY APPLICABLE MANUFACTURERS TECHNICAL SPECIFICATIONS.

REFER TO ALL OF THE DRAWINGS FOR COMPLETE SCOPE OF WORK.

THIS DRAWING IS NOT TO BE SCALED AND/OR USED AS AN AS-BUILD.

THESE DRAWINGS AND SPECIFICATIONS ARE THE PROPERTY AND COPYRIGHT OF MORRIS NATHANSON DESIGN INC. AND SHALL NOT BE USED IN WHOLE OR IN PART, NOR SHALL THEY BE ASSIGNED TO A THIRD PARTY WITHOUT THE EXPRESS WRITTEN PERMISSION OF MORRIS NATHANSON DESIGN INC.

CONTRACTOR TO VERIFY ALL INFORMATION & DIMENSIONS IN FIELD PRIOR TO START OF CONSTRUCTION AND SHALL NOTIFY MORRIS NATHANSON DESIGN INC. OF ANY DISCREPANCIES.

CONSULTANTS:

PROJECT:

BURRO BAR
1357 WASHINGTON
BOSTON, MA 02118

REVISIONS

No.	DESCRIPTION	DATE
1	BUILDING REVIEW	12-08-17

DRAWING TITLE:

LIGHT SPECIFICATIONS

DSGN. BY: JB	PROJ. #: 2017-11
CHK. BY: JB	SCALE: AS NOTED
DRWN. BY: JB	DATE: 12-08-17

EXT
4