

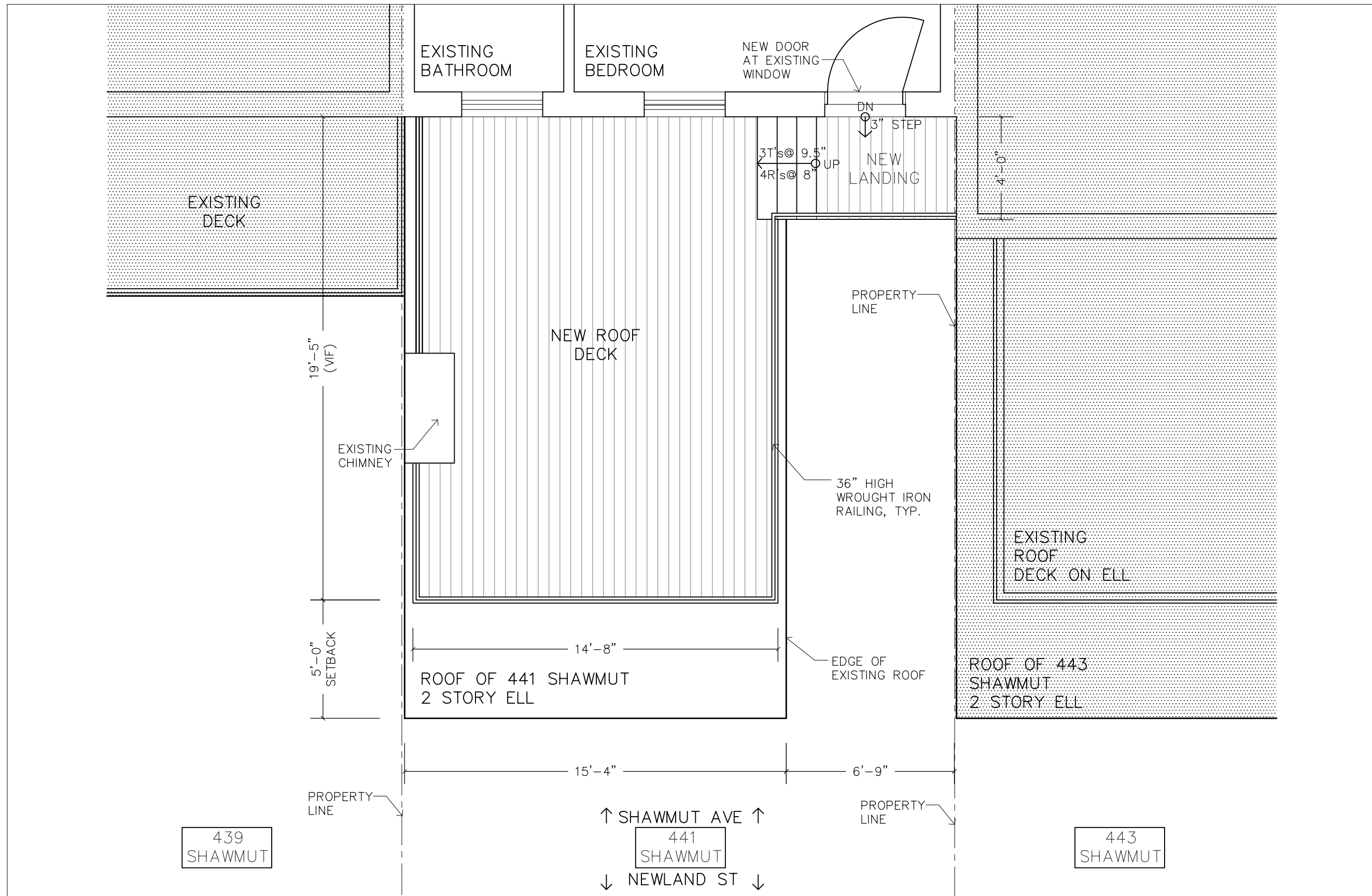

DOWLING ROOF DECK
441 SHAWMUT AVE, APT. #2
BOSTON, MASSACHUSETTS

DATE:
2.15.17

A-1



1 **THIRD FLOOR PLAN**
1/4" = 1'-0"

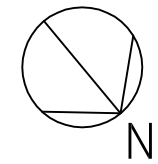



1 EXISTING REAR ELEVATION
 3/16" = 1'-0"

A-2

DATE:
 2.15.17

DOWLING ROOF DECK
 441 SHAWMUT AVE, APT. #2
 BOSTON, MASSACHUSETTS

BRUCE MILLER
 ARCHITECTURE + INTERIORS
 46 WALTHAM STREET #215
 BOSTON, MA 02118
 617.338.3933



439
SHAWMUT

443
SHAWMUT

441
SHAWMUT

SHAWMUT ELL

1 PROPOSED REAR ELEVATION
3/16" = 1'-0"

A-3

DATE:
2.15.17

DOWLING ROOF DECK
441 SHAWMUT AVE
BOSTON, MASSACHUSETTS

BRUCE MILLER
ARCHITECTURE + INTERIORS
46 WALTHAM STREET #215
BOSTON, MA 02118
617.338.3933



\$1000 FINE
FOR
DISPOSAL
OF RUBBISH
IN THE
CITY OF
BOSTON



\$1000 FINE
FOR
DISPOSAL
OF RUBBISH
IN THE
CITY OF
BOSTON



NO STOPPING
FOR LANE CHANGES

430